

## CWLK "Long thread" Cable gland kits

CW brass glands are suitable for indoor and outdoor applications and meet IP66 requirements. The gland clamps the cable ensuring electrical continuity and mechanical retention of the cable. Suitable for use with SWA cable. These glands have a longer thread than standard CW glands.



Part Number	Entry Thread Diameter (A)	Thread Length Minimum (B)	Cable Bedding Diameter (C)	Overall Cable Diameter (D)	Overall Gland Length (E)	Hex Size Across Flat (F)	Hex Size Across Corners (G)	Contents of each Per Kit
<b>CWLK16/20</b>	M20	16	8.4	13.5	74.0	24.0	26.5	2
<b>CWLK20S</b>	M20	16	11.7	16.0	74.0	24.0	26.5	2
<b>CWLK20</b>	M20	16	14.0	21.1	74.0	30.0	33.0	2
<b>CWLK25</b>	M25	16	20.0	27.4	74.0	37.6	41.4	2
<b>CWLK32</b>	M32	16	26.3	34.0	81.0	46.0	50.6	2
<b>CWLK40</b>	M40	16	32.2	40.6	88.0	55.0	60.5	1
<b>CWLK50</b>	M50	16	44.1	53.2	89.0	65.0	71.5	1
<b>CWLK63</b>	M63	19	56.0	68.5	95.0	80.0	88.0	1

All dimensions are in mm

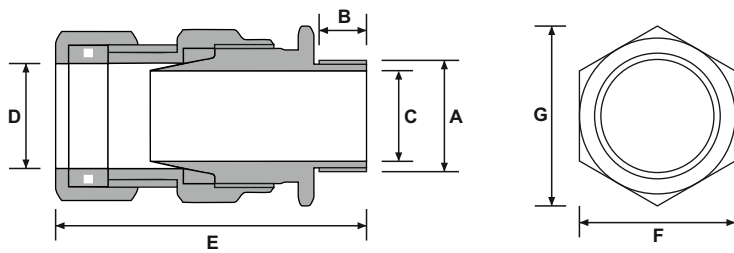

## CW LSF Shrouds

Part Number	Description	Pack
<b>EGS20CW-LSF</b>	M20 LSF Shroud for CW Gland	2
<b>EGS25CW-LSF</b>	M25 LSF Shroud for CW Gland	2
<b>EGS32CW-LSF</b>	M32 LSF Shroud for CW Gland	2
<b>EGS40CW-LSF</b>	M40 LSF Shroud for CW Gland	1
<b>EGS50CW-LSF</b>	M50 LSF Shroud for CW Gland	1
<b>EGS63CW-LSF</b>	M63 LSF Shroud for CW Gland	1
<b>EGS75CW-LSF</b>	M75 LSF Shroud for CW Gland	1



## Brass Earth Tags

Part Number	Description	Pack
<b>EET20B</b>	M20 Brass Earth Tag	1
<b>EET25B</b>	M25 Brass Earth Tag	1
<b>EET32B</b>	M32 Brass Earth Tag	1
<b>EET40B</b>	M40 Brass Earth Tag	1
<b>EET50B</b>	M50 Brass Earth Tag	1
<b>EET63B</b>	M63 Brass Earth Tag	1
<b>EET75B</b>	M75 Brass Earth Tag	1



## Brass Locknuts

Part Number	Description	Pack
<b>ELN20B</b>	M20 Brass Locknut	1
<b>ELN25B</b>	M25 Brass Locknut	1
<b>ELN32B</b>	M32 Brass Locknut	1
<b>ELN40B</b>	M40 Brass Locknut	1
<b>ELN50B</b>	M50 Brass Locknut	1
<b>ELN63B</b>	M63 Brass Locknut	1
<b>ELN75B</b>	M75 Brass Locknut	1



## Technical Datasheet



### Applications

Indoor and outdoor use  
Use where waterproof seal is required  
Suitable for SWA cable  
Glands to BS6121:Part 1

### IP Rating

IP66

### Kit contents

#### CWLK16/20 to CWLK32

2 x brass glands  
2 x galvanised steel locknuts  
2 x brass earth tags  
2 x PVC shrouds

#### CWLK40 to CWLK63

1 x brass gland  
1 x galvanised steel locknut  
1 x brass earth tag  
1 x PVC shroud

*LSF shrouds, brass locknuts and additional brass earth tags are available to purchase individually.*

### CW LSF Shrouds

Zero Halogen  
Low smoke  
Self-extinguishing  
UL94 V0 rated