

fix and secure with
expressFIX



FIX & SECURE

EBT-6U uncoated SS316 ball-lock ties

EBT-6U uncoated stainless steel cable ties provide a low cost solution to the electrical contractor for fixing and clamping applications.

Excellent weather, heat, corrosion, chemical and fire resistance, ensure they are suitable for indoor, outdoor and underground applications, that require high strength and reliability.



Technical Datasheet



Colour

Metallic

Material

Marine Grade SS316

Operating temperature

-60°C up to +300°C.

Features

- UL94 fireproof
- Halogen free
- UV resistant
- Rounded edges
- Rollerball locking mechanism
- 4.6 & 7.9mm wide options
- Eleven lengths

Tensile Strength

4.6mm wide = 667N

7.9mm wide = 1335N

Ordering information

Part Number	Pack Qty (pcs)	Length (mm)	Width (mm)	Max Bundle Dia (mm)	Min Tensile Strength (N)
EBT-6U-046-0100	100	100	4.6	18	667
EBT-6U-046-0150	100	150	4.6	34	667
EBT-6U-046-0200	100	200	4.6	50	667
EBT-6U-046-0260	100	260	4.6	69	667
EBT-6U-046-0300	100	300	4.6	80	667
EBT-6U-046-0360	100	360	4.6	100	667
EBT-6U-046-0520	100	520	4.6	151	667
EBT-6U-046-0620	100	620	4.6	183	667
EBT-6U-046-0680	100	680	4.6	200	667
EBT-6U-046-0840	100	840	4.6	254	667
EBT-6U-046-1000	100	1000	4.6	304	667
EBT-6U-079-0100	100	100	7.9	18	1335
EBT-6U-079-0150	100	150	7.9	34	1335
EBT-6U-079-0200	100	200	7.9	50	1335
EBT-6U-079-0260	100	260	7.9	69	1335
EBT-6U-079-0300	100	300	7.9	80	1335
EBT-6U-079-0360	100	360	7.9	100	1335
EBT-6U-079-0520	100	520	7.9	151	1335
EBT-6U-079-0620	100	620	7.9	183	1335
EBT-6U-079-0680	100	680	7.9	200	1335
EBT-6U-079-0840	100	840	7.9	254	1335
EBT-6U-079-1000	100	1000	7.9	304	1335

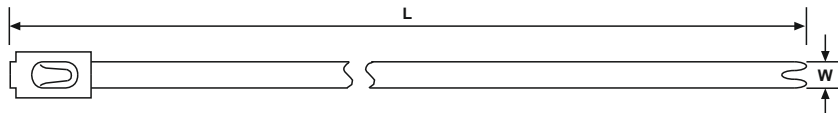

Application tooling

EFSST

- For 4.6 & 7.9mm widths
- Lever action cuts off excess tail
- Easy grip handle design
- Installer controlled tensioning
- Suitable for coated or non-coated cable ties



ECTT2

- For 4.6 & 7.9mm widths
- Automatic cut off of excess tail
- Adjustable tensioning
- Metal body construction
- Low cost solution



EBT-60 coated SS316 ball-lock ties

EBT-60 polyester coated stainless steel cable ties deliver a low cost solution for applications that require an extra degree of protection for the cable, bundle or pipe.

The polyester coating mitigates galvanic corrosion of dissimilar metals once in position, and ensures safe installer handling.



Ordering information

Part Number	Pack Qty (pcs)	Length (mm)	Width (mm)	Max Bundle Dia (mm)	Min Tensile Strength (N)
EBT-60-046-0100	100	100	4.6	18	667
EBT-60-046-0150	100	150	4.6	34	667
EBT-60-046-0200	100	200	4.6	50	667
EBT-60-046-0260	100	260	4.6	69	667
EBT-60-046-0300	100	300	4.6	80	667
EBT-60-046-0360	100	360	4.6	100	667
EBT-60-046-0520	100	520	4.6	151	667
EBT-60-046-0620	100	620	4.6	183	667
EBT-60-046-0680	100	680	4.6	200	667
EBT-60-046-0840	100	840	4.6	254	667
EBT-60-046-1000	100	1000	4.6	304	667
EBT-60-079-0100	100	100	7.9	18	1335
EBT-60-079-0150	100	150	7.9	34	1335
EBT-60-079-0200	100	200	7.9	50	1335
EBT-60-079-0260	100	260	7.9	69	1335
EBT-60-079-0300	100	300	7.9	80	1335
EBT-60-079-0360	100	360	7.9	100	1335
EBT-60-079-0520	100	520	7.9	151	1335
EBT-60-079-0620	100	620	7.9	183	1335
EBT-60-079-0680	100	680	7.9	200	1335
EBT-60-079-0840	100	840	7.9	254	1335
EBT-60-079-1000	100	1000	7.9	304	1335

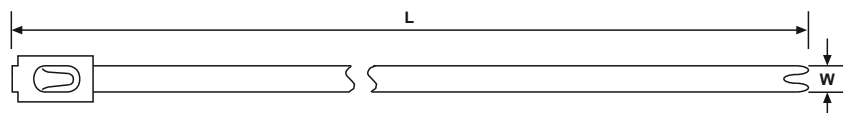

Application tooling

EFSST

- For 4.6 & 7.9mm widths
- Lever action cuts off excess tail
- Easy grip handle design
- Installer controlled tensioning
- Suitable for coated or non-coated cable ties



ECTT2

- For 4.6 & 7.9mm widths
- Automatic cut off of excess tail
- Adjustable tensioning
- Metal body construction
- Low cost solution



Technical Datasheet



Colour

Black

Material

Marine Grade SS316 with black polyester coating

Operating temperature

-60°C up to +300°C (base tie)
-60°C up to +150°C (coating)

Features

UL94 fireproof
Halogen free
UV resistant
Rounded edges
Rollerball locking mechanism
4.6 & 7.9mm wide options
Eleven lengths
Fully coated head and tail

Tensile Strength

4.6mm wide = 667N
7.9mm wide = 1335N

EBT premium uncoated SS316 ball-lock ties

Offering a higher tensile strength the EBT premium uncoated cable ties have a non-releasable locking mechanism offering infinite adjustment along the length. Suitable for the most arduous conditions or where additional strength, fire and chemical resistance is required. Manufactured in the UK, and used in all industries from mass transit, shipbuilding, oil rigs, mining and chemical industries. The unique "end of tail" design ensures a smooth and guided entry to the cable tie head at installation.

Ordering information

Part Number	Material	Pack Qty (pcs)	Length (mm)	Width (mm)	Max Bundle Dia (mm)	Min Tensile Strength (N)
EBT5S	SS 316	100	127	4.6	25	900
EBT8S	SS 316	100	201	4.6	50	900
EBT12S	SS 316	100	300	4.6	80	900
EBT14S	SS 316	100	362	4.6	102	900
EBT20S	SS 316	100	521	4.6	152	900
EBT27S	SS 316	100	681	4.6	203	900
EBT33S	SS 316	100	838	4.6	254	900
EBT8H	SS 316	50	201	7.9	50	2000
EBT14H	SS 316	50	362	7.9	102	2000
EBT20H	SS 316	50	521	7.9	152	2000
EBT27H	SS 316	50	681	7.9	203	2000
EBT33H	SS 316	50	838	7.9	254	2000
EBT14XH	SS 316	50	362	12.3	102	2700
EBT20XH	SS 316	50	521	12.3	152	2700
EBT27XH	SS 316	50	681	12.3	203	2700
EBT33XH	SS 316	50	838	12.3	254	2700

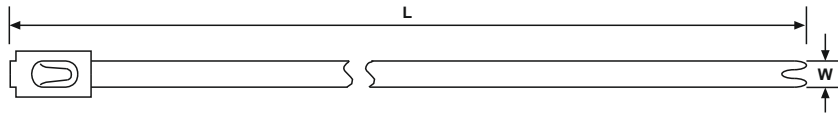

Application tooling

THT

- For 4.6 & 7.9mm widths
- Ergonomic T-Handle design
- Integrated ratchet system
- Simple tensioning mechanism
- Tail coils to a safe' neat finish



ECTT2

- For 4.6 & 7.9mm widths
- Automatic cut off of excess tail
- Adjustable tensioning
- Metal body construction
- Low cost solution



ECTT2

- For 4.6 & 7.9mm widths
- Automatic cut off of excess tail
- Adjustable tensioning
- Metal body construction
- Low cost solution



MK9SST

- For ties up to 16mm wide
- Side entry for tie
- Fully adjustable tensioning
- Single handed operation
- Automatic cut off, with no sharp edges
- Non slip ergonomic handle



Technical Datasheet



Colour

Metallic

Material

Marine Grade SS316

Operating temperature

-80°C up to +538°C.

Features

- High tensile strength
- Fast, secure installation
- Unique tail for ease of feeding
- Weather & corrosion resistant
- Halogen free
- UV resistant
- Rounded edges
- Rollerball locking mechanism
- 3 strap widths available

Tensile Strength

4.6mm wide = 900N

7.9mm wide = 2000N

12.3mm wide = 2700N

EBT premium coated SS316 ball-lock ties

The EBT premium polyester coated 316 grade cable ties use a patented, non-releasable, ball locking system, designed to ease installation and provide high tensile strengths. Suitable for general purpose use, construction, automotive, and environments where weather and chemical resistance is necessary. They have excellent salt spray resistance properties and are well suited to the marine environment.



Technical Datasheet



Colour

Black

Material

Marine Grade SS316

Operating temperature

-80°C up to +538°C (base tie)
-80°C up to +150°C (coating)

Features

- High tensile strength
- Fast, secure installation
- Unique tail for ease of feeding
- Weather & corrosion resistant
- Halogen free
- UV resistant
- Rounded edges
- Rollerball locking mechanism
- 3 strap widths available
- Coating provides cable protection

Tensile Strength

4.6mm wide = 540N
7.9mm wide = 1020N
12.3mm wide = 1620N

Ordering information

Part Number	Material	Pack Qty (pcs)	Length (mm)	Width (mm)	Max Bundle Dia (mm)	Min Tensile Strength (N)
EBT8S-FC	SS 316	100	201	4.6	50	540
EBT12S-FC	SS 316	100	300	4.6	80	540
EBT14S-FC	SS 316	100	362	4.6	102	540
EBT20S-FC	SS 316	100	521	4.6	152	540
EBT27S-FC	SS 316	100	681	4.6	203	540
EBT33S-FC	SS 316	100	838	4.6	254	540
EBT8H-FC	SS 316	50	201	7.9	50	1020
EBT14H-FC	SS 316	50	362	7.9	102	1020
EBT20H-FC	SS 316	50	521	7.9	152	1020
EBT27H-FC	SS 316	50	681	7.9	203	1020
EBT33H-FC	SS 316	50	838	7.9	254	1020
EBT14XH-FC	SS 316	50	362	12.3	102	1620
EBT20XH-FC	SS 316	50	521	12.3	152	1620
EBT27XH-FC	SS 316	50	681	12.3	203	1620
EBT33XH-FC	SS 316	50	838	12.3	254	1620

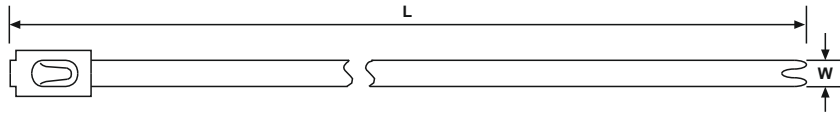

Application tooling

THT

- For 4.6 & 7.9mm widths
- Ergonomic T-Handle design
- Integrated ratchet system
- Simple tensioning mechanism
- Tail coils to a safe' neat finish



ECTT2

- For 4.6 & 7.9mm widths
- Automatic cut off of excess tail
- Adjustable tensioning
- Metal body construction
- Low cost solution



ECTT2

- For 4.6 & 7.9mm widths
- Automatic cut off of excess tail
- Adjustable tensioning
- Metal body construction
- Low cost solution



MK9SST

- For ties up to 16mm wide
- Side entry for tie
- Fully adjustable tensioning
- Single handed operation
- Automatic cut off, with no sharp edges
- Non slip ergonomic handle



ECT nylon cable ties

ECT cable ties have internal serrations allowing for a positive hold on to cable and pipe bundles. The head design ensures a high tensile strength while allowing a very low insertion force.

These general purpose versatile fasteners can be used in countless applications and are regularly used throughout mass transit, shipbuilding, petro-chemical, automotive, construction and electrical contracting.

Ordering information

BLACK Part Number	NATURAL Part Number	Pack Qty (pcs)	Length (mm)	Width (mm)	Max Dia (mm)	Min Tensile (kg)
ECT80X2.4B	ECT80X2.4N	100	80	2.4	15	8.0
ECT100X2.5B	ECT100X2.5N	100	100	2.5	22	8.1
ECT120X2.5B	ECT120X2.5N	100	120	2.5	24	8.1
ECT165X2.5B	ECT165X2.5N	100	165	2.5	40	8.1
ECT200X2.5B	ECT200X2.5N	100	200	2.5	53	8.1
ECT140X3.6B	ECT140X3.6N	100	140	3.6	33	18.2
ECT180X3.6B	ECT180X3.6N	100	180	3.6	53	18.2
ECT200X3.6B	ECT200X3.6N	100	200	3.6	53	18.2
ECT300X3.6B	ECT300X3.6N	100	300	3.6	102	18.2
ECT120X4.8B	ECT120X4.8N	100	120	4.8	24	22.2
ECT160X4.8B	ECT160X4.8N	100	160	4.8	38	22.2
ECT200X4.8B	ECT200X4.8N	100	200	4.8	50	22.2
ECT250X4.8B	ECT250X4.8N	100	250	4.8	60	22.2
ECT300X4.8B	ECT300X4.8N	100	300	4.8	76	22.2
ECT370X4.8B	ECT370X4.8N	100	370	4.8	102	22.2
ECT430X4.8B	ECT430X4.8N	100	430	4.8	110	22.2
ECT150X7.6B	ECT150X7.6N	100	150	7.6	35	54.4
ECT200X7.6B	ECT200X7.6N	100	200	7.6	50	54.4
ECT300X7.6B	ECT300X7.6N	100	300	7.6	76	54.4
ECT380X7.6B	ECT380X7.6N	100	380	7.6	102	54.4
ECT430X9.0B	ECT430X9.0N	100	430	9.0	110	79.4
ECT530X9.0B	ECT530X9.0N	100	530	9.0	140	79.4
ECT610X9.0B	ECT610X9.0N	100	610	9.0	180	79.4
ECT710X9.0B	ECT710X9.0N	100	710	9.0	190	79.4
ECT780X9.0B	ECT780X9.0N	100	780	9.0	228	79.4
ECT914X9.0B	ECT914X9.0N	100	914	9.0	265	79.4
ECT1220X9.0B	ECT1220X9.0N	100	1220	9.0	325	79.4
ECT280X12.7B	ECT280X12.7N	100	280	12.7	70	114.0
ECT380X12.7B	ECT380X12.7N	100	380	12.7	102	114.0
ECT480X12.7B	ECT480X12.7N	100	480	12.7	120	114.0
ECT580X12.7B	ECT580X12.7N	100	580	12.7	204	114.0
ECT730X12.7B	ECT730X12.7N	100	730	12.7	190	114.0
ECT880X12.7B	ECT880X12.7N	100	880	12.7	240	114.0
ECT1030X12.7B	ECT1030X12.7N	100	1030	12.7	295	114.0

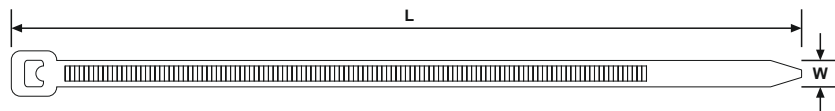

Application tooling

ECTT1

- For fast, safe tensioning and cut off of excess tail
- Suitable for nylon cable tie widths from 2.4 to 4.8mm
- Material : Metal bodied
- Colour : Red
- Dimensions : 178 x 140 x 29mm



Technical Datasheet



Colour

Black or natural

Material

Halogen free Polyamide 6.6

Features

Halogen free

UL94 V2

Fast, secure installation

Smooth round edges

Wide range of sizes

ECT coloured cable ties

The perfect solution for applications such as colour coding, date/year identification, asset tagging, package or area coding, and ensuring a fast and effective visual identifier on site.



Ordering information

Part Number	Colour	Pack Qty (pcs)	Length (mm)	Width (mm)	Max Dia (mm)	Min Tensile (kg)
ECT100X2.5BL	BLUE	100	100	2.5	22	8.1
ECT140X3.6BL	BLUE	100	140	3.6	33	18.2
ECT200X4.8BL	BLUE	100	200	4.8	50	22.2
ECT300X4.8BL	BLUE	100	300	4.8	76	22.2
ECT100X2.5BR	BROWN/ORANGE	100	100	2.5	22	8.1
ECT140X3.6BR	BROWN/ORANGE	100	140	3.6	33	18.2
ECT200X4.8BR	BROWN/ORANGE	100	200	4.8	50	22.2
ECT300X4.8BR	BROWN/ORANGE	100	300	4.8	76	22.2
ECT100X2.5G	GREEN	100	100	2.5	22	8.1
ECT140X3.6G	GREEN	100	140	3.6	33	18.2
ECT200X4.8G	GREEN	100	200	4.8	50	22.2
ECT300X4.8G	GREEN	100	300	4.8	76	22.2
ECT100X2.5R	RED	100	100	2.5	22	8.1
ECT140X3.6R	RED	100	140	3.6	33	18.2
ECT200X4.8R	RED	100	200	4.8	50	22.2
ECT300X4.8R	RED	100	300	4.8	76	22.2
ECT100X2.5Y	YELLOW	100	100	2.5	22	8.1
ECT140X3.6Y	YELLOW	100	140	3.6	33	18.2
ECT200X4.8Y	YELLOW	100	200	4.8	50	22.2
ECT300X4.8Y	YELLOW	100	300	4.8	76	22.2
ECT300X4.8S	SILVER	100	300	4.8	76	22.2
ECT370X4.8S	SILVER	100	370	4.8	102	22.2

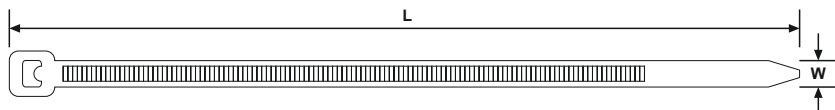

ECT weather resistant cable ties

Weather resistant cable ties have a greater resistance to ultraviolet light which is known to damage natural nylon. This range can be used where adverse outdoor conditions exist.



Ordering information

Part Number	Colour	Pack Qty (pcs)	Length (mm)	Width (mm)	Max Dia (mm)	Min Tensile (kg)
ECT100X2.5WR	Black	100	100	2.5	22	8.1
ECT150X3.6WR	Black	100	150	3.6	35	18.2
ECT200X3.6WR	Black	100	200	3.6	53	18.2
ECT200X4.8WR	Black	100	200	4.8	50	22.2
ECT300X4.8WR	Black	100	300	4.8	76	22.2
ECT370X4.8WR	Black	100	370	4.8	102	22.2
ECT530X4.8WR	Black	100	530	4.8	140	22.2
ECT540X7.6WR	Black	100	540	7.6	140	54.4
ECT1220X9.0WR	Black	100	1220	9.0	365	79.4



Technical Datasheet



Colour

Blue, Brown/Orange, Green, Red, Yellow and Silver

Material

Halogen free Polyamide 6.6

Features

Halogen free
UL94 V2
Fast, secure installation
Smooth round edges
Six colour choices

Colour

Black

Material

Halogen free Polyamide 6.6

Features

Halogen free
UL94 V2
Fast, secure installation
Smooth round edges



U.K. Office : Tel: +44 (0)141 941 3689

sales@expresselectrical.co.uk

www.expresselectrical.co.uk

U.A.E. Office : Tel: +971 (0)4 887 5570

info@expresselectrical.ae

www.expresselectrical.ae

ECTB self adhesive nylon cable tie base

With a self adhesive cable tie base you can create a cable tie mounting point anywhere. Use of a cable tie base ensures cables are routed and fixed safely and in an organised fashion.

Before application please ensure surfaces are clean and grease free. For uneven surfaces you can use the central fixing hole and screw in to position.



Ordering information

BLACK Part Number	NATURAL Part Number	Pack Qty (pcs)	Length (mm)	Width (mm)	Height (mm)	Fixing Hole Dia (mm)	Cable Tie Slot (mm)
ECTB19B	ECTB19N	100	19.0	19.0	4.4	3.5	4.0
ECTB28B	ECTB28N	100	27.7	27.7	5.7	5.7	5.3
ECTB40B	ECTB40N	100	38.1	38.1	5.4	6.0	9.3

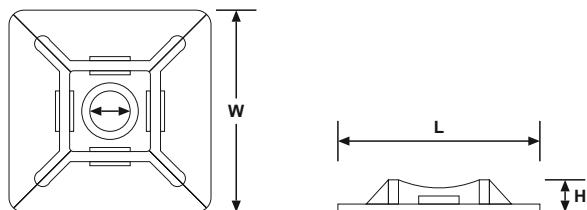

Technical Datasheet



Colour

Black or natural

Material

Halogen free Polyamide 6.6

Features

Halogen free

UL94 V2

Self adhesive backing

Single fixing hole

Operating temperature

-40°C up to +85°C

ESMB screw mount nylon cable tie base

Designed to hold larger cables or cable bundles, these screw mount bases are used across many industries and offer a very secure cable tie mounting point.

The saddles can easily be fixed in place by means of a screw or bolt using the fixing hole, and can accommodate a range of cable ties widths.



Ordering information

BLACK Part Number	NATURAL Part Number	Pack Qty (pcs)	Length (mm)	Width (mm)	Height (mm)	Fixing Hole Dia (mm)	Cable Tie Slot (mm)
ESMB1B	ESMB1N	100	14.9	9.5	7.2	3.7	4.8
ESMB2B	ESMB2N	100	21.9	15.9	9.7	5.0	9.0

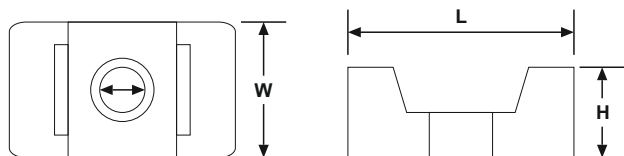

Colour

Black or natural

Material

Halogen free Polyamide 6.6

Features

Halogen free

UL94 V2

Single fixing hole

Suitable for screw or bolt

Operating temperature

-40°C up to +85°C

ESSCM stainless steel “winged” cable tie cradle mount

These “winged” cable tie mounts are suitable for the secure fixing of cables and hoses when used in conjunction with stainless steel cable ties.

Manufactured from 316 grade stainless steel complete with a fixing hole to suit a no.8 screw, and designed to accommodate cable ties up to 8mm wide.



Ordering information

Part Number	Pack Qty (pcs)	Length (mm)	Width (mm)	Tie Width Max (mm)	Fixing Hole (mm)
ESSCM8	100	12.0	16.0	8.0	5.0

Technical Datasheet



Colour

Metallic

Material

Marine Grade SS316

Features

Suitable for ties up to 8mm wide
5mm fixing hole for No.8 screw
Design prevents screw head interference with cable tie
Quick and easy to install

Operating temperature

-80°C up to +538°C

ESSPC cable tie bases

These bases provide a secure fixing point for cables and hoses, in the most arduous of environments, when used in conjunction with stainless steel cable ties.

With a heavy duty design and manufactured from 316 grade stainless, there is a choice of three fixing holes, and are suitable for cable ties up to 10mm wide.



Ordering information

Part Number	Description	Pack Qty (pcs)	Length (mm)	Width (mm)	Tie Width Max (mm)	Fixing Hole (mm)
ESSPC4	Base with 4mm hole	100	23.0	10.0	10.0	4.0
ESSPC5	Base with 5mm hole	100	23.0	10.0	10.0	5.0
ESSPC6	Base with 6mm hole	100	23.0	10.0	10.0	6.0



Colour

Metallic

Material

Marine Grade SS316

Features

Suitable for ties up to 10mm wide
4,5 and 6mm fixing hole options
Simple design
Quick and easy to install

Operating temperature

-80°C up to +538°C

ECC Clingstrap Cable Cleats

A range of one-piece, single-fixing point cable cleats that are suitable for use with cable, conduit and pipes up to 50.8mm diameter.

Clingstrap style cleats provides a simple, but strong fixing point and are suitable for both indoor and outdoor use.

Available in 13 sizes and two materials types.



Ordering information - Polypropylene

Polypropylene Part Number	Pack Qty (pcs)	Length (mm)	Height (mm)	Width (mm)	Hole Size	Diameter Range
ECC04	100	27.0	12.5	15.0	M6	7.7 - 10.0
ECC05	100	29.7	15.0	16.0	M6	10.1 - 12.7
ECC06	100	33.0	17.0	16.5	M6	12.6 - 15.2
ECC07	100	36.0	19.5	19.5	M6	15.1 - 17.6
ECC08	100	38.0	25.0	19.5	M6	17.7 - 20.3
ECC09	100	42.0	26.0	19.5	M6	20.2 - 22.8
ECC10	100	46.0	32.5	22.0	M6	22.7 - 25.4
ECC11	50	50.5	36.0	22.0	M10	25.3 - 27.7
ECC12	50	59.0	40.0	25.0	M10	27.6 - 30.5
ECC14	50	63.0	46.5	25.0	M10	30.4 - 35.5
ECC16	25	69.0	52.0	25.0	M10	35.4 - 40.6
ECC18	25	72.5	58.0	25.0	M10	40.5 - 45.7
ECC20	25	72.0	60.0	25.0	M10	45.6 - 50.8

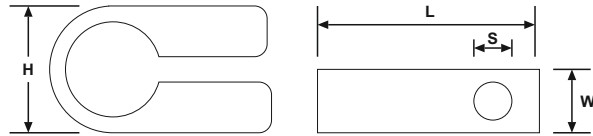

Ordering information - Polypropylene Low Smoke Flame Retardant

Polypropylene LSF Part Number	Pack Qty (pcs)	Length (mm)	Height (mm)	Width (mm)	Hole Size	Diameter Range
ECC04-LSF	100	27.0	12.5	15.0	M6	7.7 - 10.0
ECC05-LSF	100	29.7	15.0	16.0	M6	10.1 - 12.7
ECC06-LSF	100	33.0	17.0	16.5	M6	12.6 - 15.2
ECC07-LSF	100	36.0	19.5	19.5	M6	15.1 - 17.6
ECC08-LSF	100	38.0	25.0	19.5	M6	17.7 - 20.3
ECC09-LSF	100	42.0	26.0	19.5	M6	20.2 - 22.8
ECC10-LSF	100	46.0	32.5	22.0	M6	22.7 - 25.4
ECC11-LSF	50	50.5	36.0	22.0	M10	25.3 - 27.7
ECC12-LSF	50	59.0	40.0	25.0	M10	27.6 - 30.5
ECC14-LSF	50	63.0	46.5	25.0	M10	30.4 - 35.5
ECC16-LSF	25	69.0	52.0	25.0	M10	35.4 - 40.6
ECC18-LSF	25	72.5	58.0	25.0	M10	40.5 - 45.7
ECC20-LSF	25	72.0	60.0	25.0	M10	45.6 - 50.8

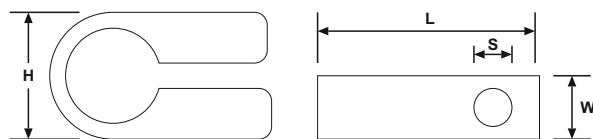

Technical Datasheet



Colour

Black

Material

Polypropylene or
Polypropylene LSF

Features

Fast and simple to install
Provides a strong fixing point
For cables up to 50mm diameter
Suitable for indoor and outdoor use
UV resistant
Large size range

Operating temperature

-35°C up to +105°C