

LV Resin Cable Joints - Straight

Resin filled jointing kits for armoured cables up to 1kV. The clear injection moulded rigid high-impact joint shells allow easy viewing to aid correct installation. Armour continuity bonding components are supplied with every shell and include connectors, earth braid, constant force springs, core separators, 2-part resin, sealing tape, gloves and installation instructions. Filling the joint is easy with a convenient pouring funnel and sealing cap, with proven two-part polyurethane resin supplied in foil packs.



Part Number	Selection Chart Colour	Joint Length (A)	Joint Diameter (B)	Cable Entry Ø (C)	Cable Range (mm ²)	Max 4 Core (mm ²)	2-Part Resin Qty
EJK-RS-06-4	Blue	200	35	5 - 20	1.5 - 10	6	200ml
EJK-RS-16-4	Orange	250	45	8 - 30	10 - 25	16	350ml
EJK-RS-25-4	Purple	320	60	10 - 34	25 - 35	25	750ml
EJK-RS-35-4	Green	355	72	26 - 53	35 - 150	70	1.2 litres

All dimensions are in mm

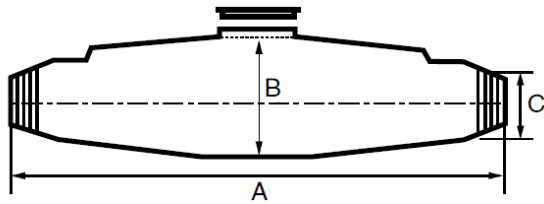

Selection Chart - Straight jointing kits

No of Cores	Armoured Cable Size (mm ²)													
	1.5	2.5	4	6	10	16	25	35	50	70	95	120	150	
1														
2														
3														
4														

Injection Moulded Shells

Rigid and very strong cable jointing shells with snap-lock design provide an excellent seal and prevents any resin leakage.

Mechanical Connectors

Machined brass connectors are included and are suitable for low voltage cables with copper or aluminium conductors.

Earth Braid

The flat, soft braid ensures excellent electrical contact and is insulated for extra protection.

Constant Force Springs

Cable joints are subject to cyclical movement and expansion due to earth shift and heat from electrical current. Constant force springs react to this movement and maintain a sound electrical connection between the steel wire armouring and the earth continuity braid.

Core Separators

Provide safe separation of cable cores and mechanical connectors.

Two-part resin

Cable joint resin is suitable for LV jointing of cables with excellent adhesion to PVC, XLPE, polythene, and paper cables. Resin is supplied in a 2-part easy mix packaging, ensuring both convenience and safety.

Installation Guide

Detailed instruction sheet provided showing the cable jointing procedure.



Technical Datasheet



Applications

LV cable joints
Suitable for SWA cables
(PVC and XLPE)

Rating

Max voltage rating: 1kV

Approvals

Tested to EN 50393:2006-11

Kit contents

- 1 x clear snap-lock shell
- 4 x connectors
- 2 x constant force springs
- 1 x earth braid
- 1 x PVC tape
- 1 x resin pouch
- 1 x pair protective gloves
- 1 x instructions