

ECC Clingstrap Cable Cleats

- A one-piece, single-fixing point range of cable cleats
- Suitable for use with cable, conduit and pipes up to 50.8mm diameter
- Provides a simple, but strong fixing point
- 13 different sizes available within this range
- UV resistant
- Operating temperature range : -35°C to +105°C
- Material options : Polypropylene / Polypropylene LSF

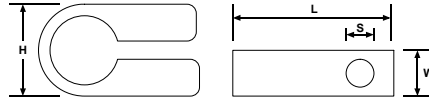

Polypropylene Part Number	Polypropylene LSF Part Number	Pack Qty (pcs)	Length (mm)	Height (mm)	Width (mm)	Fixing Hole Size	Diameter Range
ECC04	ECC04-LSF	100	27.0	12.5	15.0	M6	7.7 - 10.0
ECC05	ECC05-LSF	100	29.7	15.0	16.0	M6	10.1 - 12.7
ECC06	ECC06-LSF	100	33.0	17.0	16.5	M6	12.6 - 15.2
ECC07	ECC07-LSF	100	36.0	19.5	19.5	M6	15.1 - 17.6
ECC08	ECC08-LSF	100	38.0	25.0	19.5	M6	17.7 - 20.3
ECC09	ECC09-LSF	100	42.0	26.0	19.5	M6	20.2 - 22.8
ECC10	ECC10-LSF	100	46.0	32.5	22.0	M6	22.7 - 25.4
ECC11	ECC11-LSF	50	50.5	36.0	22.0	M10	25.3 - 27.7
ECC12	ECC12-LSF	50	59.0	40.0	25.0	M10	27.6 - 30.5
ECC14	ECC14-LSF	50	63.0	46.5	25.0	M10	30.4 - 35.5
ECC16	ECC16-LSF	25	69.0	52.0	25.0	M10	35.4 - 40.6
ECC18	ECC18-LSF	25	72.5	58.0	25.0	M10	40.5 - 45.7
ECC20	ECC20-LSF	25	72.0	60.0	25.0	M10	45.6 - 50.8



U.K. Office: +44 (0)141 941 3689 | sales@expresselectrical.co.uk | www.expresselectrical.co.uk

U.A.E. Office: +971 (0)4 887 5570 | info@expresselectrical.ae | www.expresselectrical.ae