

Part number

# PEW 6363 PQ



Flush-mounting socket outlet, PLUSO series, 2 poles + PE, 6 h (blue), 63 A, 200 ÷ 250 V, straight

| Product description                           |   | Material properties          |   |
|---|---|------------------------------|---|
| <b>Product type</b>                           | Socket<br>Flush-mounting  | <b>Colour</b>                | RAL 7035 grey, RAL 5015 blue  |
| <b>Series</b>                                 | PEW...PQ, PLUSO   | <b>RoHs conformity</b>       | Compliant with exemption<br>6(c): copper alloy containing up to 4% lead by weight |
| <b>N. of poles</b>                            | 2 poles +  | <b>China RoHs - EFUP</b>     | 50  |
| <b>Clock position</b>                         | 6   | <b>REACH SVHC substances</b> | Yes<br>Lead   |
| <b>Specification</b>                          | Straight  | <b>SCIP number</b>           | Ca7de37f-add8-4b77-9861-279c94903ade  |
| Technical data                                |   | Approvals / Standards        |   |
| <b>Current</b>                                | 63 A  | <b>Reference standard</b>    | EN 60309-1 and -2   |
| <b>Voltage</b>                                | 200 ÷ 250 V   | General ordering information |   |
| <b>IP degree of protection</b>                | IP67  | <b>EAN13 code</b>            | 8015747077347   |
| Further technical details                     |   | Packaging Information        |   |
| <b>Weight</b>                                 | 593,00 g  | <b>Packaging length</b>      | 290,00 mm   |
| <b>Operating temperature range (min, max)</b> | -25°C ... +40°C   | <b>Packaging height</b>      | 140,00 mm   |
|   |   | <b>Packaging width</b>       | 215,00 mm   |
|   |   | <b>Packaging weight</b>      | 2,57 kg   |
|   |   | <b>Packaging volume</b>      | 8,73 dm <sup>3</sup>  |
|   |   | <b>Packaging description</b> | Carton box  |
|   |   | <b>Packaging quantity</b>    | 4 Pcs   |
|   |   | <b>Packaging EAN code</b>    | 8015747077354   |

Part number

# PEW 6363 PQ



Catalogue drawings

(63 / 125A) PEW ... PQ

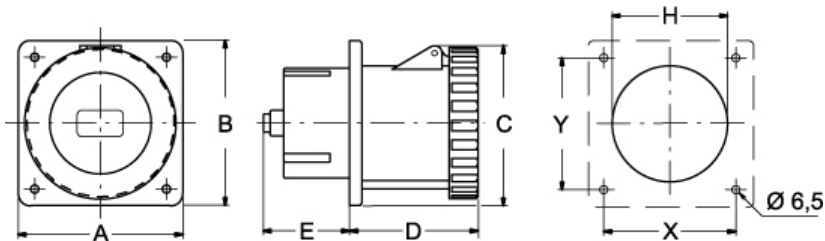

| PEW ... PQ       | A      | B   | C   | D   | E   | H  | X   | Y   |
|------------------|--------|-----|-----|-----|-----|----|-----|-----|
| <b>63A</b> 2P+⊕  | 100    | 107 | 109 | 92  | 30  | 73 | 77  | 85  |
|                  | 100    | 107 | 109 | 92  | 30  | 73 | 77  | 85  |
|                  | 3P+N+⊕ | 100 | 107 | 109 | 92  | 30 | 73  | 77  |
| <b>125A</b> 2P+⊕ | 130    | 130 | 130 | 101 | 68  | 91 | 104 | 104 |
|                  | 130    | 130 | 130 | 101 | 68  | 91 | 104 | 104 |
|                  | 3P+N+⊕ | 130 | 130 | 130 | 101 | 68 | 91  | 104 |

## Notes

Dimensions shown in mm are not binding and may be changed without notice.

- Compliant with EN 60309-1 and -2
- Enclosure, insert and spring lid in insulating, thermoplastic, self-extinguishing material
- RAL 7035 grey enclosure, spring lid colour coded according to the operating voltage
- Flange with anti-ageing gasket
- PE...PQ types (IP44), spring lid
- PEW...PQ types (IP67), spring lid with locking ring and gasket
- Terminals with retained screws
- 63A, 125A: with pilot contact
- Nickel-plated contacts, available on request for 16A and 32A (standard on 63A and 125A). For the code of products with nickel-plated contacts (socket holes, plug pins), add "N" to the pre-code of the corresponding standard product code; for example: PE becomes PEN and PEW becomes PEWN.
- IP44 and IP67 degrees of protection (EN 60529)