

**Cable and Wire Mounting Devices (Used without Cable Ties)**

B1

Wiring accessories are an integral part of the Panduit comprehensive selection of wire management products.

B2

These accessories are one piece solutions that help provide the lowest installed cost for controlling, mounting, and protecting wire and cable. Mounting methods include:

B3

- Adhesive-backed
- Screw applied
- Rivet applied
- Push mounts

C1



C2

C3

**Adhesive Backed Mounting Devices**

**Faster Liner Removal Speeds Installation and Lowers Installed Cost**

- The adhesive backed mounts are offered either as one or two mounts per liner
- The 2-up mounts are easily removed by bending the mounts away from the liner
- The individual mounts have a convenient tear tab for quick removal

C4

D1

**ARC<sup>®</sup> Clincher™ Adjustable Releasable Clamp**

- Adjustable clamp designed to contain a range of cable bundle diameters
- Latch can be released to provide access to cable bundles
- For indoor use only
- Material: Polypropylene

D2

D3

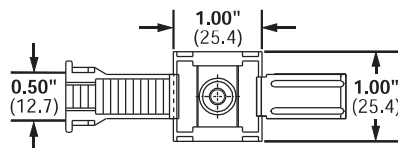

E1

E2

E3

Part Number	Bundle Diameter Range		Color	Mounting Method	Std. Pkg. Qty.	Std. Ctn. Qty.
	In.	mm				
ARC.68-A-Q	0.19 – 0.68	4.8 – 17.3	White	Rubber Adhesive Tape	25	250
ARC.68-A-Q14	0.19 – 0.68	4.8 – 17.3	Gray			
ARC.68-S6-Q	0.19 – 0.69	4.8 – 17.5	White	#6 (M3) Screw		
ARC.68-S6-Q14	0.19 – 0.69	4.8 – 17.5	Gray			

E4

E5

F

G

H