

A-M

RING TONGUE TERMINALS WITH CONTAINED PALM

for L.V. circuit breakers - for Copper conductors

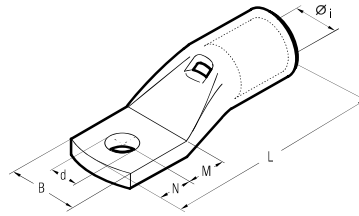

Cond. Size Flexible sqmm	Ø Stud mm	Type	Dimensions mm						Quantity Box/Bag	Mechanical Tools	Hydraulic Tools							
			Øi	B	M	N	L	d			HT45-E	B450ND-BVE	HT51 B50E	B500ND	HT81-U RHU81	HT120 and tools with 130 kN crimping force		
10	5	A2-M5/9	4,6	9,0	6,5	6,0	26,0	5,3	1.000/100	HN5 HN-A25	TN705E	B15WDE	HT45-E	B450ND-BVE	HT51 B50E	B500ND	HT81-U RHU81	HT120 and tools with 130 kN crimping force
16	5	A3-M5/9	5,8	9,0	6,5	6,0	30,5	5,3	1.000/100									
25	5	A5-M5/9	7,0	9,0	6,5	6,0	31,5	5,3	500/100	TN705E	TN120SE	B15WDE	HT45-E	B450ND-BVE	HT51 B50E	B500ND	HT81-U RHU81	HT120 and tools with 130 kN crimping force
35	6	A7B-M6/11.5*	8,9	11,5	8,0	7,0	36,5	6,4	400/100									
50	6	A10B-M6/11.5*	10,0	11,5	8,0	7,0	40,5	6,4	200/50	TN705E	TN120SE	B15WDE	HT45-E	B450ND-BVE	HT51 B50E	B500ND	HT81-U RHU81	HT120 and tools with 130 kN crimping force
70	6	A14B-M6/11.5*	11,3	11,5	8,0	7,0	44,5	6,4	200/50									
95	8	A19B-M8/15.5*	13,5	15,5	9,0	8,0	52,5	8,4	100/25	TN705E	TN120SE	B15WDE	HT45-E	B450ND-BVE	HT51 B50E	B500ND	HT81-U RHU81	HT120 and tools with 130 kN crimping force
120	8	A24B-M8/19*	15,2	19,0	14,0	9,0	60,0	8,4	75/25									
120	10	A24B-M10/19*	15,2	19,0	14,0	9,0	60,0	10,5	75/25	TN705E	TN120SE	B15WDE	HT45-E	B450ND-BVE	HT51 B50E	B500ND	HT81-U RHU81	HT120 and tools with 130 kN crimping force
	8	A30B-M8/19*	16,7	19,0	18,0	9,0	70,0	8,4	50/25									
150	10	A30B-M10/19*	16,7	19,0	18,0	9,0	70,0	10,5	50/25	TN705E	TN120SE	B15WDE	HT45-E	B450ND-BVE	HT51 B50E	B500ND	HT81-U RHU81	HT120 and tools with 130 kN crimping force
	8	A30B-M8/19*	16,7	19,0	18,0	9,0	70,0	8,4	50/25									
185	10	A37B-M10/24.5*	19,2	24,5	18,0	9,0	77,0	10,5	30/15	TN705E	TN120SE	B15WDE	HT45-E	B450ND-BVE	HT51 B50E	B500ND	HT81-U RHU81	HT120 and tools with 130 kN crimping force
240	10	A48-M10/31	21,1	31,0	13,0	9,0	80,0	10,5	20/10									
240	12	A48-M12/31	21,1	31,0	16,0	12,0	86,0	13,2	20/10	TN705E	TN120SE	B15WDE	HT45-E	B450ND-BVE	HT51 B50E	B500ND	HT81-U RHU81	HT120 and tools with 130 kN crimping force
	16	A48-M16/31	21,1	31,0	19,0	17,0	94,0	17,0	20/10									
300	10	A60B-M10/31*	23,7	31,0	16,0	12,0	95,0	10,5	20/10	TN705E	TN120SE	B15WDE	HT45-E	B450ND-BVE	HT51 B50E	B500ND	HT81-U RHU81	HT120 and tools with 130 kN crimping force
	12	A60B-M12/31*	23,7	31,0	16,0	12,0	95,0	13,2	20/10									

*Without inspection hole

This range of terminals features contained palm width and has been specifically developed for application on L.V. circuit breakers with reduced space terminal blocks.

The contained palm width allows an immediate and easier installation.

Cembre terminals are manufactured from electrolytic Copper tube with a purity greater than 99.9%.

The specifically designed section of the barrel and the choice of principal dimensions are optimising the best combination of mechanical strength and electrical conductivity.

These terminals are annealed to guarantee optimum ductility and are electrolytically Tin plated to avoid oxidation.

The barrel is provided with an internal taper to ease the introduction of the conductor; furthermore, its length grants a comfortable and correct positioning between dies, during crimping operations.

Each palm is marked with the Cembre logo and part number.

Details of the appropriate crimping tools and dies are shown on pages 246 to 247.

