

## CW Cable gland kits

CW brass glands are suitable for indoor and outdoor applications and meet IP66 requirements. The gland clamps the cable ensuring electrical continuity and mechanical retention of the cable. Suitable for use with SWA cable. Glands are manufactured to BS6121 : Part 1.



## Technical Datasheet



Part Number	Entry Thread Diameter (A)	Thread Length Minimum (B)	Cable Bedding Diameter (C)	Overall Cable Diameter (D)	Overall Gland Length (E)	Hex Size Across Flat (F)	Hex Size Across Corners (G)	Contents of each Per Kit
<b>CW20S</b>	M20	10	12.5	15.0	42.0	21.8	23.8	2
<b>CW20</b>	M20	10	14.3	19.0	42.0	25.8	29.0	2
<b>CW25</b>	M25	10	20.7	27.0	44.0	36.0	39.0	2
<b>CW32</b>	M32	10	27.0	32.5	46.0	43.5	48.8	2
<b>CW40</b>	M40	15	33.25	39.0	50.0	49.0	54.4	1
<b>CW50</b>	M50	15	44.0	50.0	57.0	62.0	68.8	1
<b>CW63</b>	M63	15	56.0	62.0	61.0	78.9	87.3	1
<b>CW75</b>	M75	15	67.5	78.5	66.0	91.0	110.0	1

All dimensions are in mm

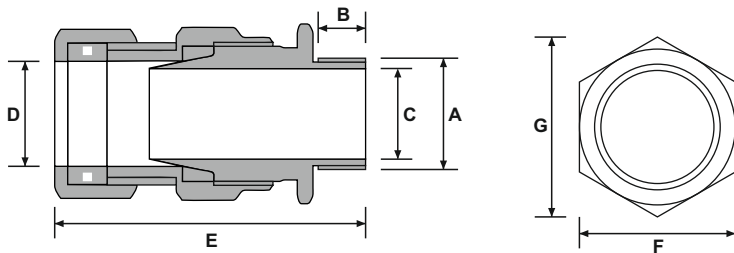

## CW LSF Shrouds

Part Number	Description	Pack
<b>EGS20CW-LSF</b>	M20 LSF Shroud for CW Gland	2
<b>EGS25CW-LSF</b>	M25 LSF Shroud for CW Gland	2
<b>EGS32CW-LSF</b>	M32 LSF Shroud for CW Gland	2
<b>EGS40CW-LSF</b>	M40 LSF Shroud for CW Gland	1
<b>EGS50CW-LSF</b>	M50 LSF Shroud for CW Gland	1
<b>EGS63CW-LSF</b>	M63 LSF Shroud for CW Gland	1
<b>EGS75CW-LSF</b>	M75 LSF Shroud for CW Gland	1



## Brass Earth Tags

Part Number	Description	Pack
<b>EET20B</b>	M20 Brass Earth Tag	1
<b>EET25B</b>	M25 Brass Earth Tag	1
<b>EET32B</b>	M32 Brass Earth Tag	1
<b>EET40B</b>	M40 Brass Earth Tag	1
<b>EET50B</b>	M50 Brass Earth Tag	1
<b>EET63B</b>	M63 Brass Earth Tag	1
<b>EET75B</b>	M75 Brass Earth Tag	1



## Brass Locknuts

Part Number	Description	Pack
<b>ELN20B</b>	M20 Brass Locknut	1
<b>ELN25B</b>	M25 Brass Locknut	1
<b>ELN32B</b>	M32 Brass Locknut	1
<b>ELN40B</b>	M40 Brass Locknut	1
<b>ELN50B</b>	M50 Brass Locknut	1
<b>ELN63B</b>	M63 Brass Locknut	1
<b>ELN75B</b>	M75 Brass Locknut	1



### Applications

Indoor and outdoor use  
Use where waterproof seal is required  
Suitable for SWA cable  
Glands to BS6121:Part 1

### IP Rating

IP66

### Kit contents

#### CW20S to CW32

2 x brass glands  
2 x galvanised steel locknuts  
2 x brass earth tags  
2 x PVC shrouds

#### CW40 to CW75

1 x brass gland  
1 x galvanised steel locknut  
1 x brass earth tag  
1 x PVC shroud

*LSF shrouds, brass locknuts and additional brass earth tags are available to purchase individually.*

### CW LSF Shrouds

Zero Halogen  
Low smoke  
Self-extinguishing  
UL94 V0 rated