

terminate and connect with
expressTERM

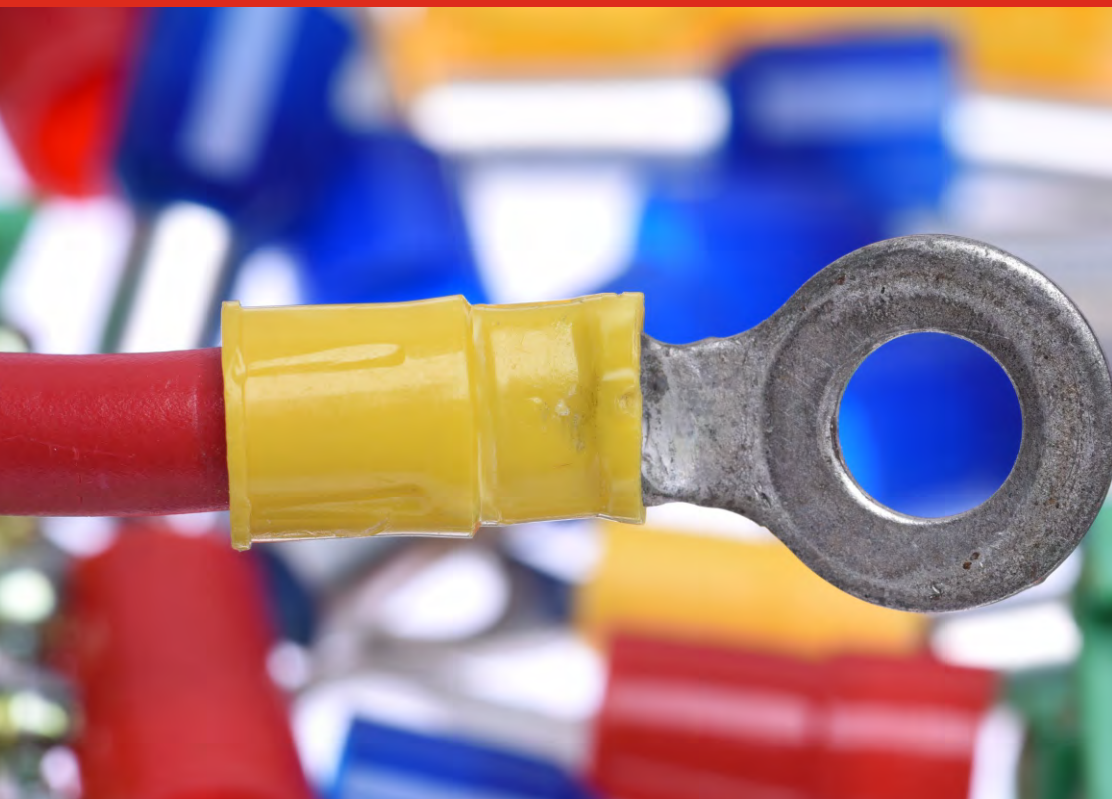

TERMINATE & CONNECT

Ring Pre-insulated terminals

All dimensions are in mm

Part Number	Range (mm ²)	Pack Qty (pcs)	Stud Size	Dia (S)	Width (W)	Length (L)	Dia (d)	
ERR32	0.5 – 1.5	100	3.0	3.3	5.5	17.5	1.7	
ERR37		100	3.5	3.8	5.5	17.5	1.7	
ERR43		100	4.0	4.4	6.6	19.4	1.7	
ERR53		100	5.0	5.4	8.0	20.8	1.7	
ERR64		100	6.0	6.5	11.6	26.7	1.7	
ERR84		100	8.0	8.5	11.6	26.7	1.7	
ERR105		100	10.0	10.5	13.0	30.5	1.7	
ERR13		100	12.0	12.0	13.0	18.0	35.4	1.7
EBR32		1.5 – 2.5	100	3.0	3.3	6.6	17.8	2.3
EBR37	100		3.5	3.8	6.6	17.8	2.3	
EBR43	100		4.0	4.4	6.6	21.8	2.3	
EBR53	100		5.0	5.4	8.5	21.8	2.3	
EBR64	100		6.0	6.4	12.0	26.8	2.3	
EBR84	100		8.0	8.4	12.0	26.8	2.3	
EBR105	100		10.0	10.5	13.6	30.5	2.3	
EBR13	100		12.0	12.0	13.0	19.2	35.4	2.3
EYR37	4.0 – 6.0		100	3.5	3.7	7.2	23.2	3.4
EYR43		100	4.0	4.4	7.2	23.2	3.4	
EYR53		100	5.0	5.4	9.5	27.3	3.4	
EYR64		100	6.0	6.4	12.0	29.5	3.4	
EYR84		100	8.0	8.5	15.0	34.5	3.4	
EYR105		100	10.0	10.6	15.0	34.5	3.4	
EYR13		100	12.0	12.0	13.0	19.2	39.1	3.4



Technical Datasheet



Material

Conductor: Copper
 Plating: Tin
 Insulation: Vinyl

Operating temperature

-10°C to +75°C

Ratings

Max voltage rating: 600V
 Max. current rating:
 Red : 19A
 Blue : 27A
 Yellow : 48A

Features

- Zero Halogen
- Flared barrel
- Simple wire insertion
- Low insertion force
- Easy to crimp
- Secure termination

Tooling

Ratchet action crimp tool
 For pre-insulated terminals
 Range : 0.5mm² to 6.0mm²
 Tool length: 242mm
 Weight: 0.5 kgs
 Part Number : **ERT6**

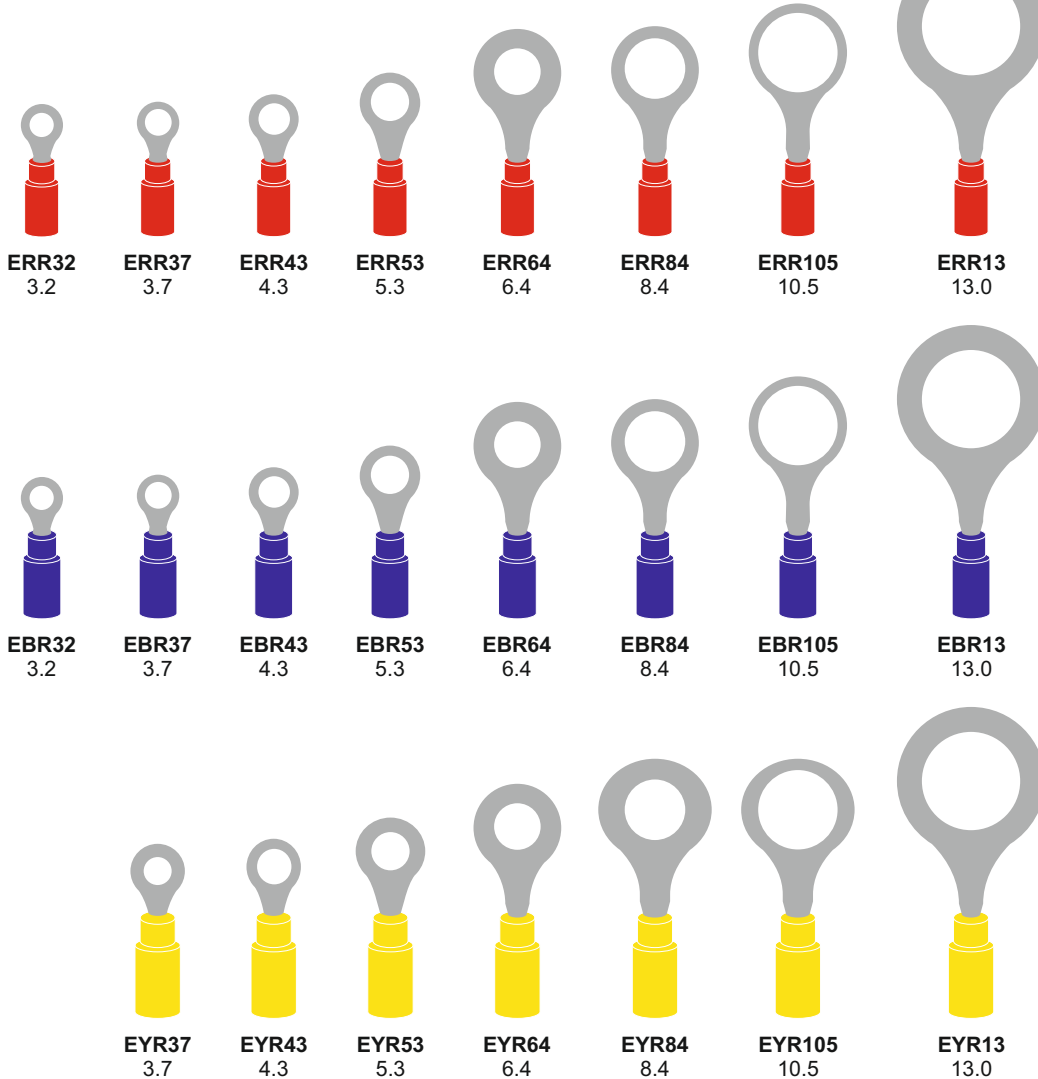
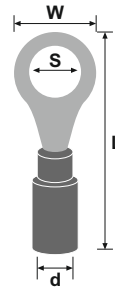

Fork Pre-insulated terminals

All dimensions are in mm

Part Number	Range (mm ²)	Pack Qty (pcs)	Stud Size	Dia (S)	Width (W)	Length (L)	Dia (d)
ERF32	0.5 – 1.5	100	3.0	3.2	5.7	21.0	1.7
ERF37		100	3.5	3.7	5.7	21.0	1.7
ERF43N		100	4.0	4.3	6.4	21.0	1.7
ERF53		100	5.0	5.3	8.1	21.0	1.7
ERF64		100	6.0	6.0	9.5	21.0	1.7
EBF32	1.5 – 2.5	100	3.0	3.2	5.7	21.0	2.3
EBF37		100	3.5	3.7	5.7	21.0	2.3
EBF43N		100	4.0	4.3	6.4	21.0	2.3
EBF53		100	5.0	5.3	7.9	21.0	2.3
EBF64		100	6.0	6.0	9.3	21.0	2.3
EYF37	4.0 – 6.0	100	3.5	3.7	8.3	25.5	3.4
EYF43		100	4.0	4.3	8.3	25.5	3.4
EYF53		100	5.0	5.3	9.0	25.5	3.4
EYF64		100	6.0	6.0	9.0	25.5	3.4

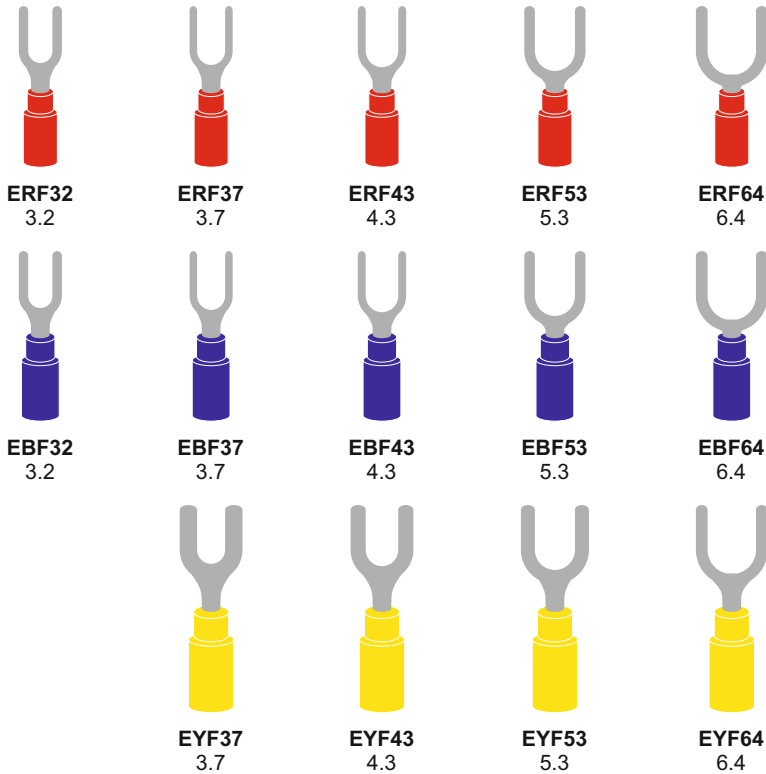
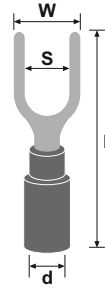

Push-on Tab Pre-insulated terminals

All dimensions are in mm

Part Number	Range (mm ²)	Pack Qty (pcs)	Width (W)	Thick (T)	Length (L)	Dia (d)
ERPOM63-8	0.5 – 1.5	100	6.3	0.8	21.8	1.7
EBPOM63-8	1.5 – 2.5	100	6.3	0.8	21.8	2.3
EYPOM63-8	4.0 – 6.0	100	6.3	0.8	24.0	3.4

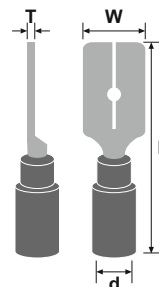
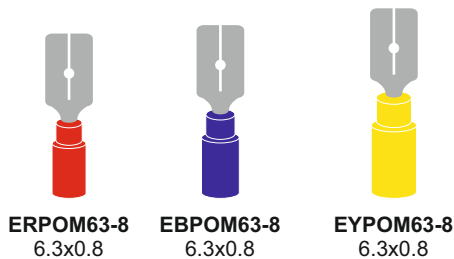

Technical Datasheet



Material

Conductor: Copper
Plating: Tin
Insulation: Vinyl

Operating temperature

-10°C to +75°C

Ratings

Max voltage rating: 600V

Max. current rating:

Red : 19A

Blue : 27A

Yellow : 48A

Features

- Zero Halogen
- Flared barrel
- Simple wire insertion
- Low insertion force
- Easy to crimp
- Secure termination

Tooling

- Ratchet action crimp tool
- For pre-insulated terminals
- Range : 0.5mm² to 6.0mm²
- Tool length: 242mm
- Weight: 0.5 kgs
- Part Number : **ERT6**



U.K. Office : Tel: +44 (0)141 941 3689

sales@expresselectrical.co.uk

www.expresselectrical.co.uk

U.A.E. Office : Tel: +971 (0)4 887 5570

info@expresselectrical.ae

www.expresselectrical.ae

Push-on Female Spade Pre-insulated terminals

All dimensions are in mm

Part Number	Range (mm ²)	Pack Qty (pcs)	Width (W)	Thick (T)	Length (L)	Dia (d)
ERFS28-5	0.5 – 1.5	100	2.8	0.5	19.0	1.7
ERFS28-8		100	2.8	0.8	19.0	1.7
ERFS48-5		100	4.8	0.5	19.4	1.7
ERFS48-8		100	4.8	0.8	19.4	1.7
ERFS63-8		100	6.3	0.8	19.4	1.7
EBFS48-5	1.5 – 2.5	100	4.8	0.5	19.4	2.3
EBFS48-8		100	4.8	0.8	19.4	2.3
EBFS63-8		100	6.3	0.8	20.8	2.3
EBFS83-5		100	8.3	0.5	24.5	2.3
EYFS63-8	4.0 – 6.0	100	6.3	0.8	23.3	3.4
EYFS95-12		100	9.5	1.2	28.6	3.4

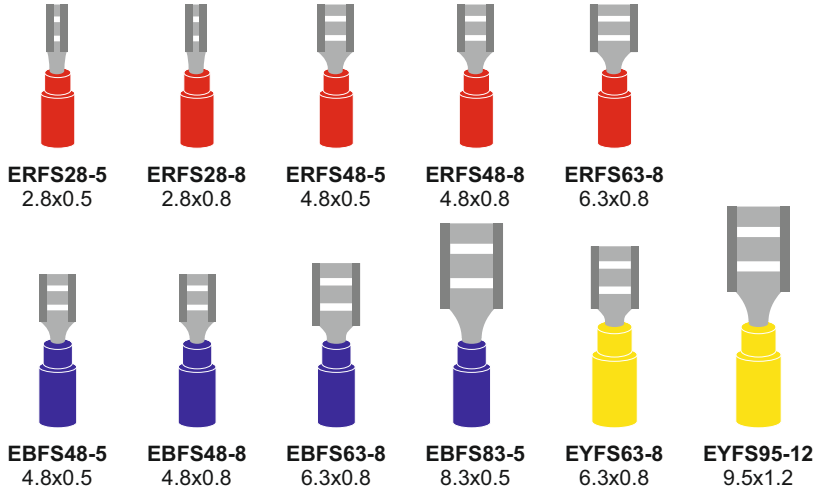
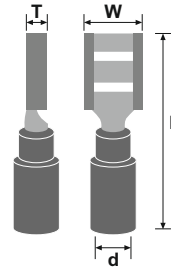

Push-on Fully insulated terminals

All dimensions are in mm

Part Number	Range (mm ²)	Pack Qty (pcs)	Width (W)	Thick (T)	Length (L)	Dia (d)
ERFSFI28-5	0.5 – 1.5	100	2.8	0.5	19.0	1.7
ERFSFI28-8		100	2.8	0.8	19.0	1.7
ERFSFI48-5		100	4.8	0.5	20.5	1.7
ERFSFI48-8		100	4.8	0.8	20.5	1.7
ERFSFI63-8		100	6.3	0.8	21.8	1.7
EBFSFI48-5	1.5 – 2.5	100	4.8	0.5	20.2	2.3
EBFSFI48-8		100	4.8	0.8	20.2	2.3
EBFSFI63-8		100	6.3	0.8	22.2	2.3
EYFSFI63-8		4.0 – 6.0	100	6.3	0.8	24.2
EYFSFI95-12	100		9.5	1.2	30.5	3.4

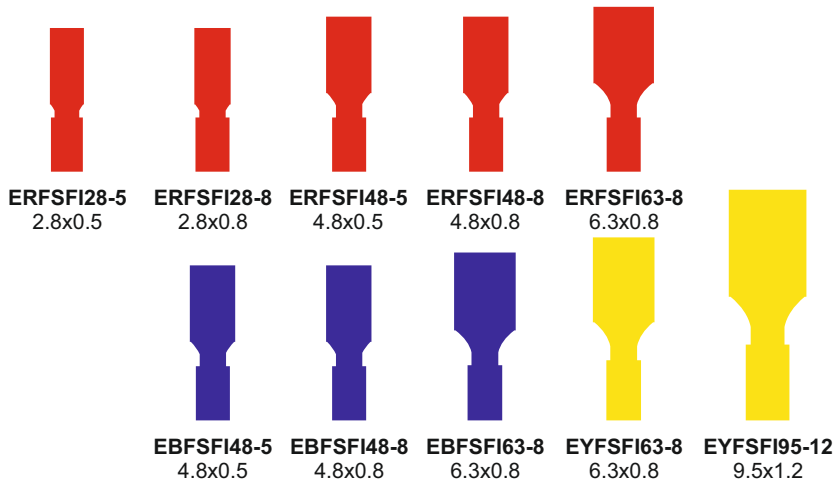
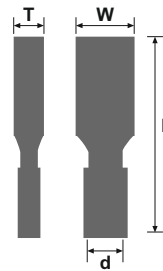

Technical Datasheet



Material

Conductor: Copper
Plating: Tin
Insulation: Vinyl

Operating temperature

-10°C to +75°C

Ratings

Max voltage rating: 600V
Max. current rating:
Red : 19A
Blue : 27A
Yellow : 48A

Features

Zero Halogen
Flared barrel
Simple wire insertion
Low insertion force
Easy to crimp
Secure termination

Tooling

Ratchet action crimp tool
For pre-insulated terminals
Range : 0.5mm² to 6.0mm²
Tool length: 242mm
Weight: 0.5 kgs
Part Number : **ERT6**



Pin Pre-insulated terminals

All dimensions are in mm

Part Number	Range (mm ²)	Pack Qty (pcs)	Width (W)	Pin (P)	Length (L)	Dia (d)
ERP9	0.5 – 1.5	100	1.9	9.0	18.8	1.7
ERP12		100	1.9	12.0	21.8	1.7
EBP9	1.5 – 2.5	100	1.9	9.0	18.8	2.3
EBP12		100	1.9	12.0	21.8	2.3
EYP14	4.0 – 6.0	100	2.8	14.0	27.0	3.4

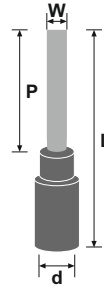
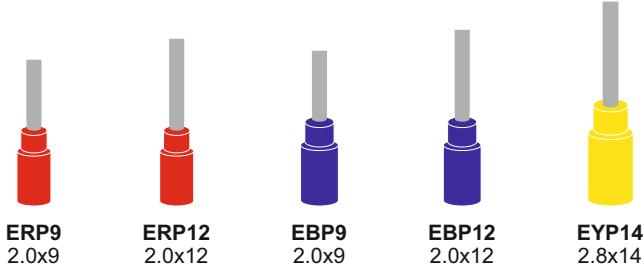

Technical Datasheet



Material

Conductor: Copper
Plating: Tin
Insulation: Vinyl

Operating temperature
-10°C to +75°C

Ratings

Max voltage rating: 600V
Max. current rating:
Red : 19A
Blue : 27A
Yellow : 48A

Features

Zero Halogen
Flared barrel
Simple wire insertion
Low insertion force
Easy to crimp
Secure termination



Blade Pre-insulated terminals

All dimensions are in mm

Part Number	Range (mm ²)	Pack Qty (pcs)	Blade (W)	Blade (B)	Length (L)	Dia (d)
ERFB9	0.5 – 1.5	100	2.8	9.0	19.3	1.7
ERFB14		100	3.0	14.0	24.3	1.7
ERFB18		100	2.3	18.0	27.8	1.7
EBFB9	1.5 – 2.5	100	2.8	9.0	19.3	2.3
EBFB18		100	2.3	18.0	27.8	2.3
EYFB10	4.0 – 6.0	100	2.8	10.5	23.5	3.4
EYFB18		100	4.5	18.0	23.0	3.4

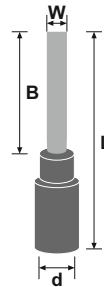
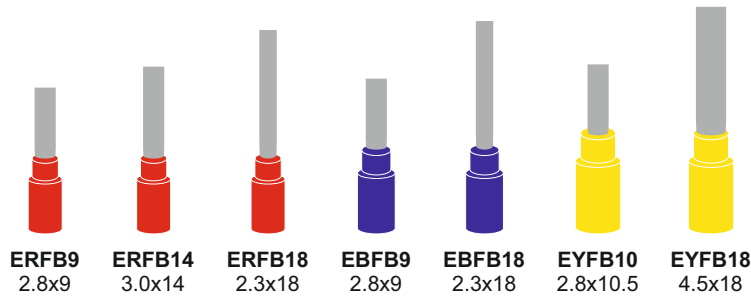

Tooling

Ratchet action crimp tool
For pre-insulated terminals
Range : 0.5mm² to 6.0mm²
Tool length: 242mm
Weight: 0.5 kgs
Part Number : **ERT6**



Hooked Blade Pre-insulated terminals

All dimensions are in mm

Part Number	Range (mm ²)	Pack Qty (pcs)	Blade (W)	Blade (B)	Length (L)	Dia (d)
ERHB3	0.5 – 1.5	100	3.0	13.0	27.7	1.7
ERHB46		100	4.6	13.0	27.7	1.7
EBHB3	1.5 – 2.5	100	3.0	13.0	27.7	2.3
EBHB46		100	4.6	13.0	27.7	2.3
EYHB46	4.0 – 6.0	100	4.6	13.0	30.7	3.4

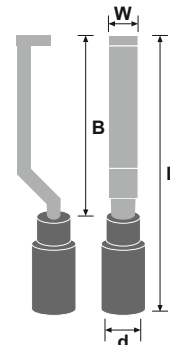
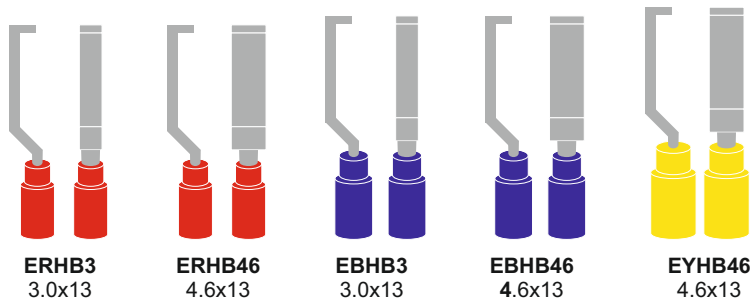

U.K. Office : Tel: +44 (0)141 941 3689

sales@expresselectrical.co.uk

www.expresselectrical.co.uk

U.A.E. Office : Tel: +971 (0)4 887 5570

info@expresselectrical.ae

www.expresselectrical.ae

Piggyback Pre-insulated terminals

All dimensions are in mm

Part Number	Range (mm ²)	Pack Qty (pcs)	Width (W)	Thick (T)	Length (L)	Dia (d)
ERPBF63-8	0.5 – 1.5	100	6.3	0.8	22.5	1.7
EBPBF63-8	1.5 – 2.5	100	6.3	0.8	22.5	2.3
EYPBF63-8	4.0 – 6.0	100	6.3	0.8	24.0	3.4



ERPBF63-8
6.3x0.8



EBPBF63-8
6.3x0.8



EYPBF63-8
6.3x0.8

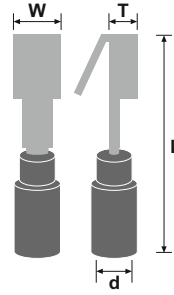

Bullet Connectors Male Pre-insulated terminals

All dimensions are in mm

Part Number	Range (mm ²)	Pack Qty (pcs)	Dia (D)	Bullet (B)	Length (L)	Dia (d)
ERBM4	0.5 – 1.5	100	4.0	10.5	21.5	1.7
EBBM4	1.5 – 2.5	100	4.0	10.5	21.7	2.3
EBBM5	1.5 – 2.5	100	5.0	10.5	21.2	2.3
EYBM5	4.0 – 6.0	100	5.0	13.0	24.0	3.4



ERBM4
4.0x11



EBBM4
4.0x11



EBBM5
5.0x11



EYBM5
5.0x13

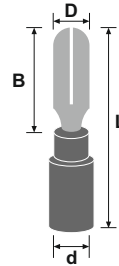

Bullet Connectors Female Pre-insulated terminals

All dimensions are in mm

Part Number	Range (mm ²)	Pack Qty (pcs)	Dia (D)	Bullet (B)	Length (L)	Dia (d)
ERBF4	0.5 – 1.5	100	4.0	10.5	23.3	1.7
EBBF4	1.5 – 2.5	100	4.0	10.5	23.3	2.3
EBBF5	1.5 – 2.5	100	5.0	10.5	23.3	2.3
EYBF5	4.0 – 6.0	100	5.0	13.0	25.1	3.4



ERBF4
4.0x23



EBBF4
4.0x23



EBBF5
5.0x23



EYBF4
5.0x25

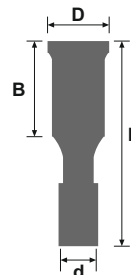

Technical Datasheet



Material

Conductor: Copper
Plating: Tin
Insulation: Vinyl

Operating temperature

-10°C to +75°C

Ratings

Max voltage rating: 600V

Max. current rating:

Red : 19A

Blue : 27A

Yellow : 48A

Features

Zero Halogen
Flared barrel
Simple wire insertion
Low insertion force
Easy to crimp
Secure termination

Tooling

Ratchet action crimp tool
For pre-insulated terminals
Range : 0.5mm² to 6.0mm²
Tool length: 242mm
Weight: 0.5 kgs
Part Number : **ERT6**



Butt Connector Pre-insulated terminals

All dimensions are in mm

Part Number	Range (mm ²)	Pack Qty (pcs)	Dia (D)	Length (L)	Dia (d)
ERBC	0.5 – 1.5	100	4.0	24.6	1.7
EBBC	1.5 – 2.5	100	4.5	24.6	2.3
EYBC	4.0 – 6.0	100	6.3	26.5	3.4



ERBC
1.7x24



EBBC
2.3x24



EYBC
3.4x27

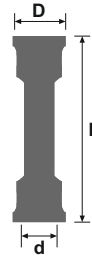

Closed End Connectors Pre-insulated terminals

All dimensions are in mm

Part Number	Range (mm ²)	Pack Qty (pcs)	Dia (D)	Length (L)	Dia (d)
ERCEC	0.5 – 1.5	100	8.0	21.0	2.3
EBCEC	1.5 – 2.5	100	8.0	21.0	3.1
EYCEC	4.0 – 6.0	100	10.0	25.5	4.0



ERCEC
2.3x21



EBCEC
3.1x21



EYCEC
4.0x26



Push-on Flag Pre-insulated terminals

All dimensions are in mm

Part Number	Range (mm ²)	Pack Qty (pcs)	Width (W)	Thick (T)	Length (L)	Dia (d)
ERFLAG63-8	0.5 – 1.5	100	6.3	0.8	16.0	1.7
EBFLAG63-8	1.5 – 2.5	100	6.3	0.8	16.5	3.4



ERFLAG63-8
6.3x0.8



EBFLAG63-8
6.3x0.8

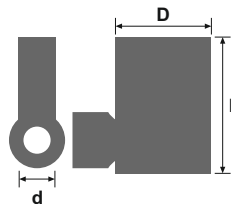

Technical Datasheet



Material

Conductor: Copper
Plating: Tin
Insulation: Vinyl

Operating temperature

-10°C to +75°C

Ratings

Max voltage rating: 600V
Max. current rating:
Red : 19A
Blue : 27A
Yellow : 48A

Features

Zero Halogen
Flared barrel
Simple wire insertion
Low insertion force
Easy to crimp
Secure termination

Tooling

Ratchet action crimp tool
For pre-insulated terminals
Range : 0.5mm² to 6.0mm²
Tool length: 242mm
Weight: 0.5 kgs
Part Number : **ERT6**



Ratchet action crimp tool
For pre-insulated **flag** terminals only
Range : 0.5mm² to 6.0mm²
Tool length: 205mm
Weight: 0.5 kgs
Part Number : **EFTCT1**



Cord End Terminals French colour coding

All dimensions are in mm

Part Number	Colour (French)	Wire (mm ²)	Pack Qty (pcs)	Width (W)	Length (L)	Ferrule (F)	Dia (d)
ECE0.25VIO	VIOLET	0.20	100	1.9	10.4	6.5	0.8
ECE0.5WHT	WHITE	0.50	100	3.3	14.0	8.0	1.0
ECE0.75BLU	BLUE	0.75	100	3.6	14.3	8.0	1.2
ECE1.0RED	RED	1.00	100	3.8	14.6	8.0	1.5
ECE1.5BLK	BLACK	1.50	100	4.5	14.6	8.0	1.8
ECE2.5GREY	GREY	2.50	100	5.1	15.4	8.0	2.3
ECE4.0ORA	ORANGE	4.00	100	5.5	16.5	9.0	2.5
ECE6.0GRN	GREEN	6.00	100	6.9	20.5	12.0	3.5
ECE10BRN	BROWN	10.00	100	8.4	21.5	12.0	4.5
ECE16IVY	IVORY	16.00	100	9.4	22.2	12.0	5.8
ECE25BLK	BLACK	25.00	100	11.8	29.0	16.0	7.5
ECE35RED	RED	35.00	100	13.1	30.0	16.0	8.3
ECE50BLU	BLUE	50.00	100	15.0	36.0	19.0	10.3
ECE70YEL	YELLOW	70.00	100	16.0	37.0	20.0	13.5

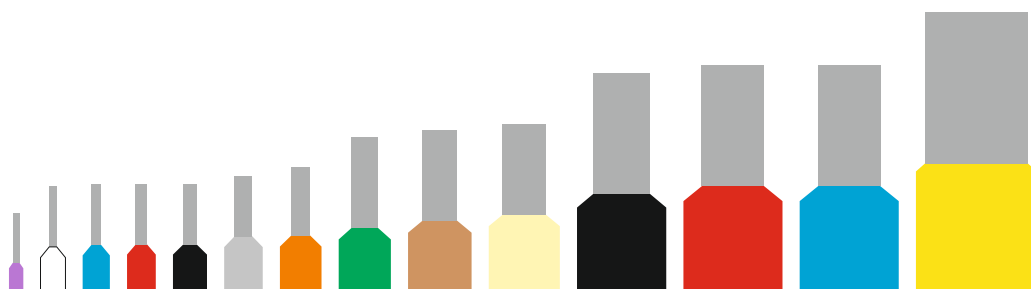
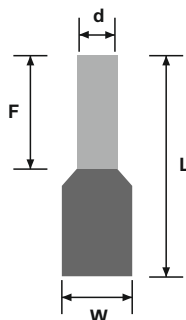

Cord End Terminals German colour coding

All dimensions are in mm

Part Number	Colour (German)	Wire (mm ²)	Pack Qty (pcs)	Width (W)	Length (L)	Ferrule (F)	Dia (d)
ECE0.25BLU	BLUE	0.20	100	1.9	10.4	6.5	0.8
ECE0.5ORA	ORANGE	0.50	100	3.3	14.0	8.0	1.0
ECE0.75WHT	WHITE	0.75	100	3.6	14.3	8.0	1.2
ECE1.0YEL	YELLOW	1.00	100	3.8	14.6	8.0	1.5
ECE1.5RED	RED	1.50	100	4.5	14.6	8.0	1.8
ECE2.5BLU	BLUE	2.50	100	5.1	15.4	8.0	2.3
ECE4.0GREY	GREY	4.00	100	5.5	16.5	9.0	2.5
ECE6.0BLK	BLACK	6.00	100	6.9	20.5	12.0	3.5
ECE10IVY	IVORY	10.00	100	8.4	21.5	12.0	4.5
ECE16GRN	GREEN	16.00	100	9.4	22.2	12.0	5.8
ECE25BRN	BROWN	25.00	100	11.8	29.0	16.0	7.5
ECE35BEI	BEIGE	35.00	100	13.1	30.0	16.0	8.3
ECE50OLV	OLIVE	50.00	100	15.0	36.0	19.0	10.3

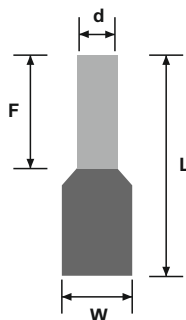

Technical Datasheet



Material

Conductor: Copper

Plating: Tin

Insulation: Vinyl

Operating temperature

-40°C to +105°C

Ratings

Max voltage rating: 600V

Features

Zero Halogen

Flared barrel

Easy wire insertion

Tooling

Ratchet action crimp tools

Ergonomic anti-slip handles

Pressure adjustable tensioner

Cord end terminals : 0.5 to 10mm²

Tool length: 230mm

Weight: 0.6 kgs

Part Number : **ECET6**



Cord end terminals : 4 to 16mm²

Tool length: 230mm

Weight: 0.6 kgs

Part Number : **ECET16**



Cord end terminals : 16 to 35mm²

Tool length: 240mm

Weight: 0.6 kgs

Part Number : **ECET35**



Cord End Terminals Dual entry

All dimensions are in mm

Part Number	Colour (mm ²)	Wire (mm ²)	Pack Qty (pcs)	Width (W)	Length (L)	Ferrule (F)	Dia (d)
EDET0.5WHT	WHITE	0.50	100	5.0	14.5	8.0	1.5
EDET0.75GREY	GREY	0.75	100	5.1	14.7	8.0	1.8
EDET1.0RED	RED	1.00	100	5.5	15.1	8.0	2.0
EDET1.5BLK	BLACK	1.50	100	6.6	15.5	8.0	2.3
EDET2.5BLU	BLUE	2.50	100	7.9	18.5	10.0	2.9
EDET4.0GREY	GREY	4.00	100	8.9	23.1	12.0	3.8
EDET6.0YEL	YELLOW	6.00	100	14.5	26.1	14.0	4.9
EDET10.0RED	RED	10.00	100	12.5	26.6	14.0	6.5
EDET16.0BLU	BLUE	16.00	100	23.7	31.3	16.0	8.3

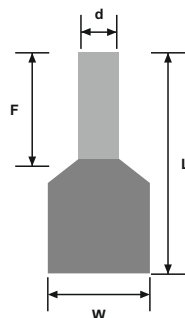

Technical Datasheet



Material

Conductor: Copper

Plating: Tin

Insulation: Vinyl

Operating temperature

-40°C to +105°C

Ratings

Max voltage rating: 600V

Features

Zero Halogen

Flared barrel

Easy wire insertion

Tooling

Ratchet action crimp tools

Ergonomic anti-slip handles

Pressure adjustable tensioner

Dual entry terminals : 0.5 to 16mm²

Tool length: 230mm

Weight: 0.6 kgs

Part Number : **EDCET35**



Cord End Un-insulated terminals

All dimensions are in mm

Part Number	Wire (mm ²)	Pack Qty (pcs)	Width (W)	Length (L)	Dia (d)
EUCE0.5-6	0.5	100	1.7	6.0	1.0
EUCE0.75-6	0.75	100	1.9	6.0	1.2
EUCE0.75-10	0.75	100	1.9	10.0	1.2
EUCE1.0-6	1.00	100	2.2	6.0	1.5
EUCE1.0-10	1.00	100	2.2	10.0	1.5
EUCE1.5-7	1.50	100	2.5	7.0	1.8
EUCE1.5-10	1.50	100	2.5	10.0	1.8
EUCE2.5-7	2.5	100	3.3	7.0	2.3
EUCE2.5-12	2.5	100	3.3	12.0	2.3
EUCE4.0-9	4.0	100	3.9	9.0	2.8
EUCE4.0-12	4.0	100	3.9	12.0	2.8
EUCE6.0-12	6.0	100	4.8	12.0	3.5
EUCE6.0-15	6.0	100	4.8	15.0	3.5
EUCE10-12	10.0	100	5.8	12.0	4.5
EUCE10-18	10.0	100	5.8	18.0	4.5
EUCE16-12	16.0	100	7.2	12.0	5.8
EUCE25-15	25.0	100	9.1	15.0	7.5
EUCE35-18	35.0	100	10.2	18.0	8.3

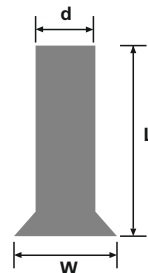

U.K. Office : Tel: +44 (0)141 941 3689

sales@expresselectrical.co.uk

www.expresselectrical.co.uk

U.A.E. Office : Tel: +971 (0)4 887 5570

info@expresselectrical.ae

www.expresselectrical.ae

Heat Shrink Solder sleeve connectors

Transparent insulation sleeve provides encapsulation, inspectability, strain relief, and insulation. Prefluxe solder preform provides a controlled soldering process. One-piece design offers easy installation and lower installed cost.



Part Number	Range (mm ²)	Pack (pcs)	Dia (d)	Length (L)	Wire A (Min)	Wire A+B (Max)	Wire B (Min)
EHSBC-CLR	0.25 – 0.34	100	1.7	26.0	0.4	1.7	0.76
EHSBC-RED	0.5 – 1.0	100	2.7	40.0	1.3	2.7	1.2
EHSBC-BLU	1.5 – 2.5	100	4.5	40.0	1.8	4.5	2.0
EHSBC-YEL	4.0 – 6.0	100	6.0	40.0	2.8	6.0	3.4

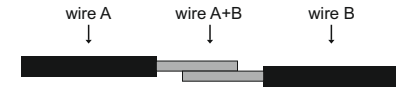
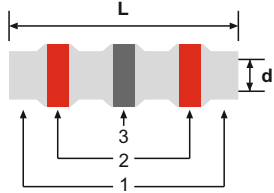

1. Heat shrinkable clear sleeve
2. Glue rings
3. Solder ring with flux

Quick Splice Low voltage connectors

Quick Splices are a fast and easy way to splice into an existing wire. No stripping of the wires is necessary, and no special tools are required. Simply insert both wires into the splice, squeeze down on the metal insert with pliers, and close the cap. An ideal solution and can be used in many low voltage applications. A fast and dependable connection.



Part Number	Range (mm ²)	Pack (pcs)	Width (W)	Length (L)
ERCT	0.5 – 1.0	100	20.0	27.0
EBCT	1.5 – 2.5	100	20.0	27.0
EYCT	4.0 – 6.0	100	20.5	34.5

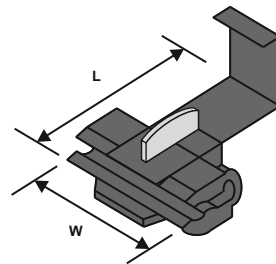
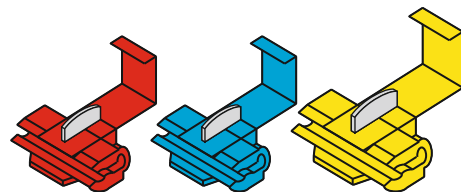

Technical Datasheet



Material

Transparent radiation cross linked modified polyolefin
Insulation: Polyethylene
Solder ring with flux
Glue ring adhesive

Operating temperature

-45°C to +125°C

Shrink temperature

+125°C >

Ratings

Max voltage rating: 600V
Dielectric strength : 25 Kv/mm



Material

Conductor : Brass
Insulation : Nylon
Plating : Tin

Operating temperature

-45°C to +105°C

Ratings

Max voltage rating: 600V

12 Way Connector Strips

Connector strips provide a simple and secure solution to protect and insulate electrical connections. Manufactured from Polyethylene with brass insert connectors and galvanised screws. They are flexible, easy to cut, low-cost with raised captive screws for easy wiring.



Part Number	Cross Section	Current Rating	Rated Voltage	Dimensions (mm)							
				L	W	Ø1	Ø2	D	d1	H	h
CS12X05A	6mm ²	5-32A	380V	115	18.8	3.3	2.6	10.0	8.0	15.0	8.8
CS12X15A	12mm ²	15-61A	400V	137	22.5	4.5	2.8	12.0	10.0	18.8	10.2
CS12X30A	16mm ²	30-76A	400V	165	25.5	5.5	3.0	14.0	11.0	19.8	11.2
CS12X60A	25mm ²	60-101A	400V	187	31.2	6.5	3.8	16.5	13.0	25.5	14.8
CS12X05A-B	6mm ²	5-32A	380V	115	18.8	3.3	2.6	10.0	8.0	15.0	8.8
CS12X15A-B	12mm ²	15-61A	400V	137	22.5	4.5	2.8	12.0	10.0	18.8	10.2
CS12X30A-B	16mm ²	30-76A	400V	165	25.5	5.5	3.0	14.0	11.0	19.8	11.2
CS12X60A-B	25mm ²	60-101A	400V	187	31.2	6.5	3.8	16.5	13.0	25.5	14.8

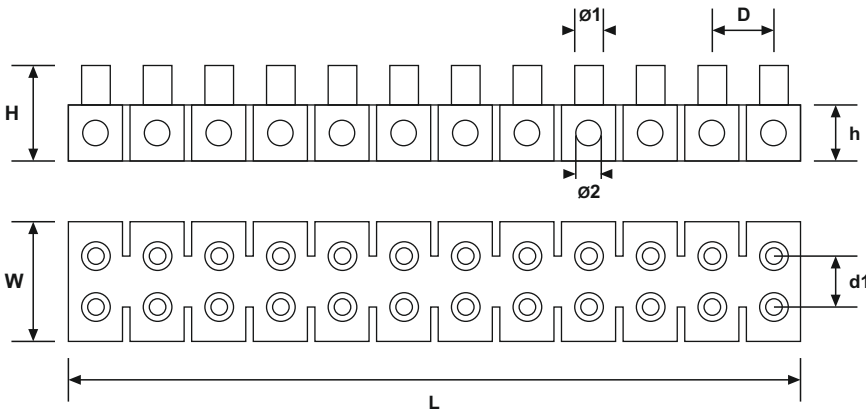

Cable Preparation Tooling

ECT1 - Multi-purpose tool to cut, strip and crimp

Wire stripper for 0.75 to 6.0mm² c/w wire cutter option
Bolt cutter for M2.6, M3, M3.5, M4 and M5
Crimps pre-insulated and non-insulated terminals 1.5 to 6.0mm²



ECT1

Length : 240mm
Weight : 0.4kgs

EWS6 - Wire stripper

Strip and cut wire 0.15 to 6.0mm²
Crimps pre-insulated and non-insulated terminals 1.5 to 6.0mm²
Robust metal construction and easy grip handle



EWS6

Length : 205mm
Weight : 0.25kgs

ECC38 - Light duty cable cutter up to 38mm²

Suitable for copper and aluminium cable up to 38mm²
The blade design ensures a clean cut without distortion
Easy grip, soft-feel insulated handles.



ECC38

Length : 205mm
Weight : 0.3kgs

ECC80 - Medium duty cable cutter up to 80mm²

Suitable for copper and aluminium non-armoured cable
The precision blade design ensures a clean cut
Easy grip, cushioned handles to reduce operator fatigue



ECC80

Length : 320mm
Weight : 0.75kgs

ECC250 - Heavy duty cable cutter up to 250mm²

Suitable for copper and aluminium non-armoured cable
The precision blade design ensures a clean cut
Extra long handles to reduce operator effort and fatigue



ECC250

Length : 600mm
Weight : 1.6kgs

Technical Datasheet



Material

Polyethylene
Brass insert connectors
Galvanised steel captive screws

Operating temperature

-15°C to +80°C

Standard

CE

Colours

Black or Natural

Pack size

1 x 12 way strip

Copper Tube Terminals

Part Number	Wire Size (mm ²)	Pack Qty (pcs)	Stud Size (mm)	Dia (D) (mm)	Width (W) (mm)	Length (L) (mm)	Barrel (B) (mm)	To Edge (F) (mm)	Palm (P) (mm)
ECL6-4	6	20	4	4.5	10	23	3.8	5.0	11.0
ECL6-5	6	20	5	5.2	10	23	3.8	5.0	11.0
ECL6-6	6	20	6	6.5	10	23	3.8	5.0	11.0
ECL6-8	6	20	8	8.2	12	27	3.8	6.0	15.0
ECL6-10	6	20	10	10.5	12	27	3.8	6.0	15.0
ECL10-5	10	20	5	5.2	12	30	4.5	6.0	13.0
ECL10-6	10	20	6	6.5	12	30	4.5	6.0	13.0
ECL10-8	10	20	8	8.2	12	30	4.5	6.0	15.0
ECL10-10	10	20	10	10.5	15	34	4.5	8.5	19.0
ECL10-12	10	20	12	12.7	15	34	4.5	8.5	19.0
ECL16-5	16	20	5	5.2	12	30	5.4	7.0	14.0
ECL16-6	16	20	6	6.5	12	30	5.4	7.0	14.0
ECL16-8	16	20	8	8.2	12	32	5.4	7.0	16.0
ECL16-10	16	20	10	10.5	15	36	5.4	8.0	20.0
ECL16-12	16	20	12	12.7	16	36	5.4	8.0	20.0
ECL25-6	25	20	6	6.5	13	32	6.8	6.0	13.0
ECL25-8	25	20	8	8.2	13	32	6.8	6.0	13.0
ECL25-10	25	20	10	10.5	16	37	6.8	9.0	20.0
ECL25-12	25	20	12	12.7	18	37	6.8	11.0	24.0
ECL35-6	35	10	6	6.5	15	35	8.2	9.0	18.0
ECL35-8	35	10	8	8.2	15	35	8.2	9.0	18.0
ECL35-10	35	10	10	10.5	15	41.5	8.2	9.0	18.0
ECL35-12	35	10	12	12.7	18	41.5	8.2	9.0	18.0
ECL35-14	35	10	14	14.7	18	41.5	8.2	9.0	18.0
ECL50-6	50	10	6	6.5	18	43	9.5	10.0	21.0
ECL50-8	50	10	8	8.2	18	43	9.5	10.0	21.0
ECL50-10	50	10	10	10.5	18	43	9.5	10.0	21.0
ECL50-12	50	10	12	12.7	18	43	9.5	10.0	21.0
ECL50-14	50	10	14	14.7	18	43	9.5	10.0	21.0
ECL50-16	50	10	16	17.0	18	43	9.5	10.0	21.0
ECL70-6	70	10	6	6.5	21	50	11.2	12.0	25.0
ECL70-8	70	10	8	8.2	21	50	11.2	12.0	25.0
ECL70-10	70	10	10	10.5	21	50	11.2	12.0	25.0
ECL70-12	70	10	12	12.7	21	50	11.2	12.0	25.0
ECL70-14	70	10	14	14.7	21	50	11.2	12.0	25.0
ECL70-16	70	10	16	17.0	21	50	11.2	12.0	25.0
ECL95-8	95	10	8	8.2	25	55	13.5	13.0	26.0
ECL95-10	95	10	10	10.5	25	55	13.5	13.0	26.0
ECL95-12	95	10	12	12.7	25	55	13.5	13.0	26.0
ECL95-14	95	10	14	14.7	25	55	13.5	13.0	26.0
ECL95-16	95	10	16	17.0	25	55	13.5	13.0	26.0
ECL95-20	95	10	20	21.0	25	55	13.5	13.0	26.0
ECL120-8	120	10	8	8.2	28	60	15.0	14.0	28.0
ECL120-10	120	10	10	10.5	28	60	15.0	14.0	28.0
ECL120-12	120	10	12	12.7	28	60	15.0	14.0	28.0
ECL120-14	120	10	14	14.7	28	60	15.0	14.0	28.0
ECL120-16	120	10	16	17.0	28	60	15.0	14.0	28.0

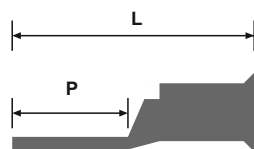
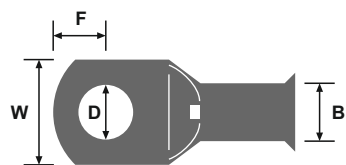

Technical Datasheet



Material

Body : Copper

Plating : Bright electro tin

Rating

Max voltage rating: 3.3kV

Features

Bell mouth for easy cable entry

Excellent conductivity

Corrosion resistant

Suitable for heavy duty applications

Inspection hole

Tooling

Ratchet action crimp tools

Ergonomic anti-slip handles

Terminal range : 1.5 to 10mm²

Tool length: 275mm

Weight: 0.6 kgs

Part Number : **ECT16**



Terminal range : 6 to 50mm²

Tool length: 390mm

Weight: 1.3 kgs

Part Number : **ECT50**



Terminal range : 25 to 150mm²

Tool length: 620mm

Weight: 4.0 kgs

Part Number : **ECT150**



To purchase these products visit us online at www.expresselectrical.co.uk

Copper Tube Terminals (continued)

Part Number	Wire Size (mm ²)	Pack Qty (pcs)	Stud Size (mm)	Dia (D) (mm)	Width (W) (mm)	Length (L) (mm)	Barrel (B) (mm)	To Edge (F) (mm)	Palm (P) (mm)
ECL150-8	150	5	8	8.2	30	69	16.5	16.0	32.0
ECL150-10	150	5	10	10.5	30	69	16.5	16.0	32.0
ECL150-12	150	5	12	12.7	39	69	16.5	16.0	32.0
ECL150-14	150	5	14	14.7	30	69	16.5	16.0	32.0
ECL150-16	150	5	16	17.0	30	69	16.5	16.0	32.0
ECL150-20	150	5	20	21.0	30	69	16.5	16.0	32.0
ECL185-10	185	5	10	10.5	34	78	18.5	17.0	34.0
ECL185-12	185	5	12	12.7	34	78	18.5	17.0	34.0
ECL185-14	185	5	14	14.7	34	78	18.5	17.0	34.0
ECL185-16	185	5	16	17.0	34	78	18.5	17.0	34.0
ECL185-20	185	5	20	21.0	34	78	18.5	17.0	34.0
ECL240-10	240	5	10	10.5	38	92	21.0	20.0	40.0
ECL240-12	240	5	12	12.7	38	92	21.0	20.0	40.0
ECL240-14	240	5	14	14.7	38	92	21.0	20.0	40.0
ECL240-16	240	5	16	17.0	38	92	21.0	20.0	40.0
ECL240-20	240	5	20	21.0	38	92	21.0	20.0	40.0
ECL300-10	300	1	10	10.5	41	97	23.0	22.0	40.0
ECL300-12	300	1	12	12.7	41	97	23.0	22.0	40.0
ECL300-14	300	1	14	14.7	41	97	23.0	22.0	40.0
ECL300-16	300	1	16	17.0	41	97	23.0	22.0	40.0
ECL400-12	400	1	12	12.7	48	108	27.0	24.0	44.0
ECL400-14	400	1	14	14.7	48	108	27.0	24.0	44.0
ECL400-16	400	1	16	17.0	48	108	27.0	24.0	44.0
ECL500-14	500	1	14	14.7	53.5	124	30.0	25.0	56.5
ECL500-16	500	1	16	17.0	53.5	124	30.0	25.0	56.5
ECL500-20	500	1	20	21.0	53.5	124	30.0	25.0	56.5

Copper Tube Butt connectors

Part Number	Wire Size (mm ²)	Pack Qty (pcs)	Dia (D)	Width (W)	Length (L)
ECB6	6	50	3.8	5.5	15
ECB10	10	25	4.5	6.2	20
ECB16	16	25	5.4	7.1	20
ECB25	25	25	6.8	8.8	32
ECB35	35	25	8.2	10.6	36
ECB50	50	10	9.5	12.4	40
ECB70	70	10	11.2	14.7	45
ECB95	95	10	13.5	17.4	45
ECB120	120	4	15.0	19.4	45
ECB150	150	4	16.5	21.2	55
ECB185	185	4	18.5	23.5	60
ECB240	240	4	21.0	26.5	80
ECB300	300	4	23.5	30.0	85
ECB400	400	4	28.5	36.5	85
ECB500	500	2	30.0	39.0	100
ECB630	630	2	35.0	45.0	110



Technical Datasheet



Material

Body : Copper
Plating : Bright electro tin

Rating

Max voltage rating: 3.3kV

Features

Bell mouth for easy cable entry
Excellent conductivity
Corrosion resistant
Suitable for heavy duty applications
Inspection hole

Tooling

Ratchet action crimp tools
Ergonomic anti-slip handles

Terminal range : 1.5 to 10mm²

Tool length: 275mm

Weight: 0.6 kgs

Part Number : **ECT16**



Terminal range : 6 to 50mm²

Tool length: 390mm

Weight: 1.3 kgs

Part Number : **ECT50**



Terminal range : 25 to 150mm²

Tool length: 620mm

Weight: 4.0 kgs

Part Number : **ECT150**



Copper Tube 4 hole transformer terminals

With a 4 x M8 stud fixing these transformer lugs are suitable for use with termination connections requiring holes with 25 x 35mm centres, found on the most common transformers. Manufactured from high grade electro tin plated copper tube and with a flared entry barrel to allow flexible and stranded cables to be inserted with ease.



Part Number	Wire Size (mm ²)	Pack Size (pcs)	Stud Size	Stud Centres (S1)	Stud Centres (S2)	Barrel Dia. (B)	Palm Width (W)	Palm Length (P)	Total Length (L)
ETL185-4	185	1	4 x M8	25	35	18.5	34.0	34.0	78.0
ETL240-4	240	1	4 x M8	25	35	21.0	38.0	40.0	92.0
ETL300-4	300	1	4 x M8	25	35	23.0	41.0	40.0	97.0
ETL400-4	400	1	4 x M8	25	35	27.0	48.0	44.0	108.0
ETL500-4	500	1	4 x M8	25	35	30.0	53.5	56.5	124.0
ETL630-4	630	1	4 x M8	25	35	33.5	61.0	60.0	144.0

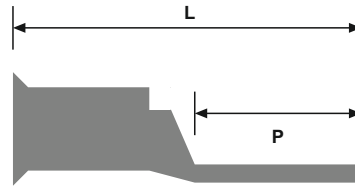
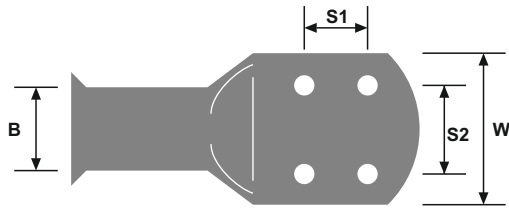

Technical Datasheet



Material

Body : Copper

Plating : Bright electro tin

Features

Bell mouth for easy cable entry

Excellent conductivity

Corrosion resistant

Suitable for heavy duty applications

Capatible with most transformer

Four hole lug design

Suits most transformer fixings

BW Cable gland kits

BW brass glands are suitable for indoor applications when a waterproof seal is not required. The gland clamps the cable ensuring electrical continuity and mechanical retention of the cable. Suitable for use with SWA cable. Glands are manufactured to BS6121:Part 1 and IP54 rated.



Part Number	Entry Thread Diameter (A)	Thread Length Minimum (B)	Cable Bedding Diameter (C)	Overall Cable Diameter (D)	Overall Gland Length (E)	Hex Size Across Flat (F)	Hex Size Across Corners (G)	Contents of each Per Kit
BW20S	M20	10	12.3	17.0	27.0	21.0	23.2	2
BW20	M20	10	14.3	20.0	28.0	23.5	26.0	2
BW25	M25	10	20.4	27.0	29.75	31.5	35.5	2
BW32	M32	10	26.5	33.5	36.35	40.0	44.3	2
BW40	M40	15	33.0	41.5	43.5	49.5	55.0	1
BW50	M50	15	44.0	54.0	46.75	62.5	70.0	1
BW63	M63	15	56.0	65.0	49.0	76.0	84.0	1
BW75	M75	15	67.5	78.5	52.0	89.5	100.0	1

All dimensions are in mm

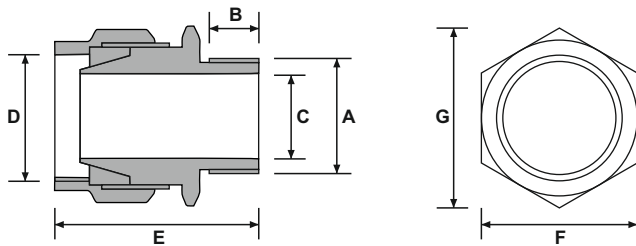

BW LSF Shrouds

Part Number	Description	Pack
EGS20BW-LSF	M20 LSF Shroud for BW Gland	2
EGS25BW-LSF	M25 LSF Shroud for BW Gland	2
EGS32BW-LSF	M32 LSF Shroud for BW Gland	2
EGS40BW-LSF	M40 LSF Shroud for BW Gland	1
EGS50BW-LSF	M50 LSF Shroud for BW Gland	1
EGS63BW-LSF	M63 LSF Shroud for BW Gland	1
EGS75BW-LSF	M75 LSF Shroud for BW Gland	1



Brass Earth Tags

Part Number	Description	Pack
EET20B	M20 Brass Earth Tag	1
EET25B	M25 Brass Earth Tag	1
EET32B	M32 Brass Earth Tag	1
EET40B	M40 Brass Earth Tag	1
EET50B	M50 Brass Earth Tag	1
EET63B	M63 Brass Earth Tag	1
EET75B	M75 Brass Earth Tag	1



Brass Locknuts

Part Number	Description	Pack
ELN20B	M20 Brass Locknut	1
ELN25B	M25 Brass Locknut	1
ELN32B	M32 Brass Locknut	1
ELN40B	M40 Brass Locknut	1
ELN50B	M50 Brass Locknut	1
ELN63B	M63 Brass Locknut	1
ELN75B	M75 Brass Locknut	1



Technical Datasheet



Applications

Indoor use
When waterproof seal NOT required
Suitable for SWA cable
Glands to BS6121:Part 1

IP Rating

IP54

Kit contents

BW20S to BW32

2 x brass glands
2 x galvanised steel locknuts
2 x brass earth tags
2 x PVC shrouds

BW40 to BW75

1 x brass gland
1 x galvanised steel locknut
1 x brass earth tag
1 x PVC shroud

LSF shrouds, brass locknuts and additional brass earth tags are available to purchase individually.

BW LSF Shrouds

Zero Halogen
Low smoke
Self-extinguishing
UL94 V0 rated

CW Cable gland kits

CW brass glands are suitable for indoor and outdoor applications and meet IP66 requirements. The gland clamps the cable ensuring electrical continuity and mechanical retention of the cable. Suitable for use with SWA cable. Glands are manufactured to BS6121 : Part 1.



Technical Datasheet



Part Number	Entry Thread Diameter (A)	Thread Length Minimum (B)	Cable Bedding Diameter (C)	Overall Cable Diameter (D)	Overall Gland Length (E)	Hex Size Across Flat (F)	Hex Size Across Corners (G)	Contents of each Per Kit
CW20S	M20	10	12.5	15.0	42.0	21.8	23.8	2
CW20	M20	10	14.3	19.0	42.0	25.8	29.0	2
CW25	M25	10	20.7	27.0	44.0	36.0	39.0	2
CW32	M32	10	27.0	32.5	46.0	43.5	48.8	2
CW40	M40	15	33.25	39.0	50.0	49.0	54.4	1
CW50	M50	15	44.0	50.0	57.0	62.0	68.8	1
CW63	M63	15	56.0	62.0	61.0	78.9	87.3	1
CW75	M75	15	67.5	78.5	66.0	91.0	110.0	1

All dimensions are in mm

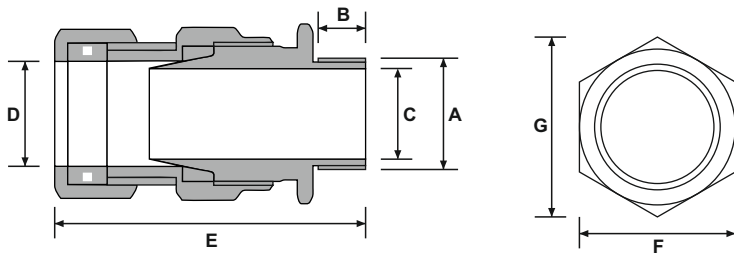

CW LSF Shrouds

Part Number	Description	Pack
EGS20CW-LSF	M20 LSF Shroud for CW Gland	2
EGS25CW-LSF	M25 LSF Shroud for CW Gland	2
EGS32CW-LSF	M32 LSF Shroud for CW Gland	2
EGS40CW-LSF	M40 LSF Shroud for CW Gland	1
EGS50CW-LSF	M50 LSF Shroud for CW Gland	1
EGS63CW-LSF	M63 LSF Shroud for CW Gland	1
EGS75CW-LSF	M75 LSF Shroud for CW Gland	1



Brass Earth Tags

Part Number	Description	Pack
EET20B	M20 Brass Earth Tag	1
EET25B	M25 Brass Earth Tag	1
EET32B	M32 Brass Earth Tag	1
EET40B	M40 Brass Earth Tag	1
EET50B	M50 Brass Earth Tag	1
EET63B	M63 Brass Earth Tag	1
EET75B	M75 Brass Earth Tag	1



Brass Locknuts

Part Number	Description	Pack
ELN20B	M20 Brass Locknut	1
ELN25B	M25 Brass Locknut	1
ELN32B	M32 Brass Locknut	1
ELN40B	M40 Brass Locknut	1
ELN50B	M50 Brass Locknut	1
ELN63B	M63 Brass Locknut	1
ELN75B	M75 Brass Locknut	1



Applications

Indoor and outdoor use
Use where waterproof seal is required
Suitable for SWA cable
Glands to BS6121:Part 1

IP Rating

IP66

Kit contents

CW20S to CW32

2 x brass glands
2 x galvanised steel locknuts
2 x brass earth tags
2 x PVC shrouds

CW40 to CW75

1 x brass gland
1 x galvanised steel locknut
1 x brass earth tag
1 x PVC shroud

LSF shrouds, brass locknuts and additional brass earth tags are available to purchase individually.

CW LSF Shrouds

Zero Halogen
Low smoke
Self-extinguishing
UL94 V0 rated

CWLK "Long thread" Cable gland kits

CW brass glands are suitable for indoor and outdoor applications and meet IP66 requirements. The gland clamps the cable ensuring electrical continuity and mechanical retention of the cable. Suitable for use with SWA cable. These glands have a longer thread than standard CW glands.



Part Number	Entry Thread Diameter (A)	Thread Length Minimum (B)	Cable Bedding Diameter (C)	Overall Cable Diameter (D)	Overall Gland Length (E)	Hex Size Across Flat (F)	Hex Size Across Corners (G)	Contents of each Per Kit
CWLK16/20	M20	16	8.4	13.5	74.0	24.0	26.5	2
CWLK20S	M20	16	11.7	16.0	74.0	24.0	26.5	2
CWLK20	M20	16	14.0	21.1	74.0	30.0	33.0	2
CWLK25	M25	16	20.0	27.4	74.0	37.6	41.4	2
CWLK32	M32	16	26.3	34.0	81.0	46.0	50.6	2
CWLK40	M40	16	32.2	40.6	88.0	55.0	60.5	1
CWLK50	M50	16	44.1	53.2	89.0	65.0	71.5	1
CWLK63	M63	19	56.0	68.5	95.0	80.0	88.0	1

All dimensions are in mm

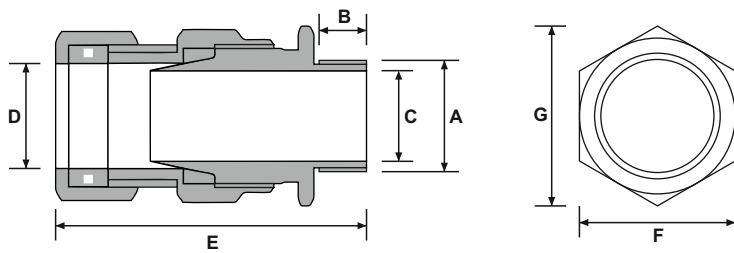

CW LSF Shrouds

Part Number	Description	Pack
EGS20CW-LSF	M20 LSF Shroud for CW Gland	2
EGS25CW-LSF	M25 LSF Shroud for CW Gland	2
EGS32CW-LSF	M32 LSF Shroud for CW Gland	2
EGS40CW-LSF	M40 LSF Shroud for CW Gland	1
EGS50CW-LSF	M50 LSF Shroud for CW Gland	1
EGS63CW-LSF	M63 LSF Shroud for CW Gland	1
EGS75CW-LSF	M75 LSF Shroud for CW Gland	1



Brass Earth Tags

Part Number	Description	Pack
EET20B	M20 Brass Earth Tag	1
EET25B	M25 Brass Earth Tag	1
EET32B	M32 Brass Earth Tag	1
EET40B	M40 Brass Earth Tag	1
EET50B	M50 Brass Earth Tag	1
EET63B	M63 Brass Earth Tag	1
EET75B	M75 Brass Earth Tag	1



Brass Locknuts

Part Number	Description	Pack
ELN20B	M20 Brass Locknut	1
ELN25B	M25 Brass Locknut	1
ELN32B	M32 Brass Locknut	1
ELN40B	M40 Brass Locknut	1
ELN50B	M50 Brass Locknut	1
ELN63B	M63 Brass Locknut	1
ELN75B	M75 Brass Locknut	1



Technical Datasheet



Applications

Indoor and outdoor use
Use where waterproof seal is required
Suitable for SWA cable
Glands to BS6121:Part 1

IP Rating

IP66

Kit contents

CWLK16/20 to CWLK32

2 x brass glands
2 x galvanised steel locknuts
2 x brass earth tags
2 x PVC shrouds

CWLK40 to CWLK63

1 x brass gland
1 x galvanised steel locknut
1 x brass earth tag
1 x PVC shroud

LSF shrouds, brass locknuts and additional brass earth tags are available to purchase individually.

CW LSF Shrouds

Zero Halogen
Low smoke
Self-extinguishing
UL94 V0 rated

E1W Weatherproof Cable gland kits

E1W brass glands are suitable for indoor and outdoor applications and meet IP rating IP66. The glands outer seal grips the sheath of the cable, and the inner seal grips the bedding layer of the cable. Suitable for use with SWA cable. Glands are manufactured to BS6121 : Part 1.



Part Number	Entry Thread Diameter (A)	Thread Length Minimum (B)	Cable Bedding Diameter (C)	Overall Cable Diameter (D)	Overall Gland Length (E)	Hex Size Across Flat (F)	Hex Size Across Corners (G)	Contents of each Per Kit
E1W20SK	M20	15	11.7	16.1	57.0	24.0	27.0	2
E1W20K	M20	15	13.9	21.1	63.0	27.0	30.0	2
E1W25K	M25	15	19.9	27.2	67.0	34.0	38.0	2
E1W32K	M32	15	26.2	33.9	70.0	40.5	45.0	2
E1W40K	M40	15	32.1	40.6	70.0	49.4	55.0	1
E1W50K	M50	15	44.0	55.7	84.0	62.0	69.0	1
E1W63K	M63	15	55.9	65.3	84.0	75.5	84.5	1

All dimensions are in mm

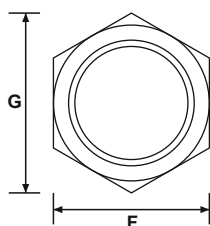
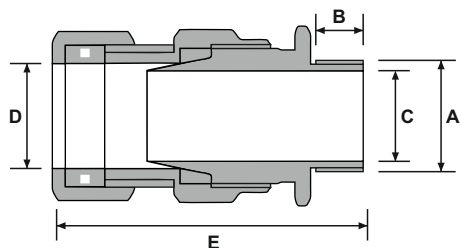

Technical Datasheet



Applications

Indoor and outdoor use
For exposed outdoor environments
Suitable for SWA cable
Glands to BS6121:Part 1

IP Rating

IP66

Kit contents

E1W20SK to E1W32K

2 x brass glands
2 x brass locknuts
2 x brass earth tags
2 x PVC shrouds

E1W40K to E1W63K

1 x brass gland
1 x brass locknut
1 x brass earth tag
1 x PVC shroud

E1WF ATEX, flameproof & weatherproof cable gland kits

E1WF double compression glands provide a controlled Ex d and IP seal on the cable inner sheath, an environmental seal on the outer sheath and a detachable armour specific clamping system for wire armoured cables. These glands have been tested to IP66 and IP68 to 50 metres. This range of glands are certified Flameproof Ex d, Increased Safety EX e, Restricted Breathing EX nR and Dust Protected Ex ta.



Part Number	Entry Thread Diameter (A)	Thread Length Minimum (B)	Cable Bedding Diameter (C)	Overall Cable Diameter (D)	Overall Gland Length (E)	Hex Size Across Flat (F)	Hex Size Across Corners (G)	Contents of each Per Kit
E1WFCK16/20	M20	16	8.4	13.5	74.0	24.0	26.5	2
E1WFCK20S	M20	16	11.7	16.0	74.0	24.0	26.5	2
E1WFCK20	M20	16	14.0	21.1	74.0	30.0	33.0	2
E1WFCK25	M25	16	20.0	27.4	74.0	38.0	41.4	2
E1WFCK32	M32	16	26.3	34.0	81.0	46.0	50.6	2
E1WFCK40	M40	16	32.2	40.6	88.0	55.0	60.5	1
E1WFCK50	M50	16	44.1	53.2	89.0	65.0	71.5	1
E1WFCK63S	M63	19	50.1	59.5	95.0	80.0	88.0	1
E1WFCK63	M63	19	56.0	65.8	95.0	80.0	88.0	1

All dimensions are in mm

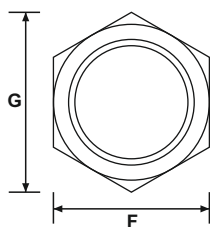
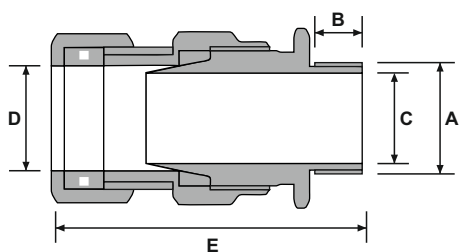

Technical Datasheet



Applications

Indoor and outdoor use
ATEX, flameproof and weatherproof
Suitable for SWA cable
Glands to BS6121:Part 1

IP Rating

IP66 and IP68 to 50 metres

Kit contents

E1WFCK16/20 to E1WFCK32

2 x brass glands
2 x brass locknuts
2 x brass earth tags
2 x PVC shrouds
2 x Nylon IP washer

E1WFCK40 to E1WFCK63

1 x brass gland
1 x brass locknut
1 x brass earth tag
1 x PVC shroud
1 x Nylon IP washer

Approvals

Certified Flameproof Ex d,
Increased Safety EX e,
Restricted Breathing EX nR and
Dust Protected Ex ta.

Suitable for Zone 1 and 2 for Gas Groups IIA, IIB and IIC and for use in Zones 20, 21 and 22 for Dust Groups IIIA, IIIB and IIIC.

Certified for Class I Zone 1 & Class I Div 2 installations for use with Marine Shipboard & Tray Cables under NEC and CEC.

A2 Brass Stuffing Cable gland kits

A2 brass glands are suitable for indoor and outdoor applications and are IP66 rated. Often referred to as “stuffing” glands they are suitable for use with all types of circular unarmoured cables. The single compression gland ensures electrical continuity and mechanical retention of the cable.



Part Number	Entry Thread Diameter (A)	Thread Length Minimum (B)	Minimum Cable Diameter (C)	Maximum Cable Diameter (D)	Overall Gland Length (E)	Hex Size Across Flat (F)	Hex Size Across Corners (G)	Contents of each Per Kit
A2-20S	M20	14	6.1	11.6	37.0	21.5	24.5	2
A2-20	M20	14	6.5	13.9	39.0	26.8	31.0	2
A2-25	M25	15	11.1	19.9	46.0	31.5	35.5	2
A2-32	M32	15	17.0	26.2	48.0	41.7	46.0	2
A2-40	M40	15	22.0	32.1	49.0	51.5	56.5	1
A2-50	M50	15	35.6	44.0	51.0	65.0	70.0	1
A2-63	M63	15	47.2	55.9	51.0	75.5	83.0	1

All dimensions are in mm

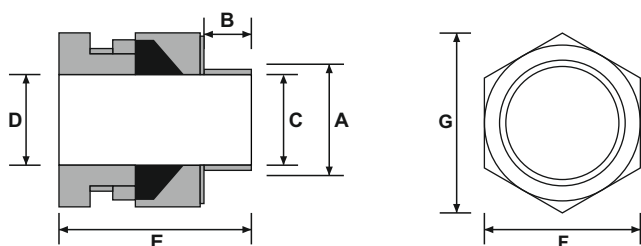

Technical Datasheet



Applications

Indoor and outdoor use
Use where waterproof seal is required
Suitable for unarmoured cable
Glands to BS6121:Part 1

IP Rating

IP66

Kit contents

A2-20S to A2-32

2 x brass glands
2 x locknuts
2 x brass earth tags
2 x PVC shrouds

A2-40 to A2-63

1 x brass gland
1 x locknut
1 x brass earth tag
1 x PVC shroud

Hexagonal Stopping Plugs Nylon 6

Stopping (or blanking) plugs are designed to blank off any unused entries in electrical junction boxes and equipment. Manufactured from halogen free Nylon 6 and supplied in metric threads with a sealing ring to ensure the IP rating of the installation is maintained.



Part Number	Colour	Thread Entry (M)	Thread Length (L)	Pack
SP12B	Black	M12	11	1
SP16B	Black	M16	12	1
SP20B	Black	M20	13	1
SP25B	Black	M25	15	1
SP32B	Black	M32	16.5	1
SP40B	Black	M40	18	1
SP50B	Black	M50	21	1
SP63B	Black	M63	24.5	1

All dimensions are in mm

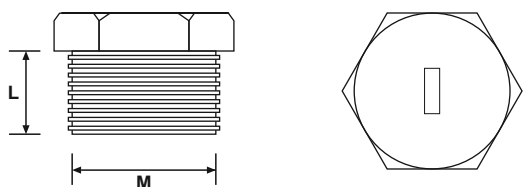

Hexagonal Stopping Plugs Brass Ex e

Brass stopping plugs are designed to close any unused entries in electrical equipment. Supplied with an 'O' ring to ensure the IP rating of the installation is maintained. Inserted from the outside and tightened with a spanner. Plugs are marked with the appropriate approvals.



Part Number	Material	Thread Entry (M)	Thread Length (L)	Pack
CON12HSPB	Brass	M12	12	1
CON16HSPB	Brass	M16	12	1
CON20HSPB	Brass	M20	12	1
CON25HSPB	Brass	M25	12	1
CON32HSPB	Brass	M32	12	1
CON40HSPB	Brass	M40	15	1
CON50HSPB	Brass	M50	15	1
CON63HSPB	Brass	M63	19	1

All dimensions are in mm

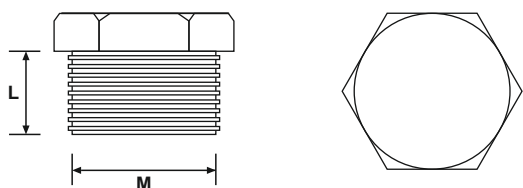

Technical Datasheet



Material

Halogen Free Polyamide 6 glassfibre with neoprene seal

Operating temperature

-30°C to +120°C

Compliance

EN 60 423

IP Rating

IP68

Technical Datasheet



Material

Brass nickel plated with Nitrile sealing ring

Operating temperature

-40°C to +100°C

Standards

Ex e & TD
 EN 60079-0 (2012) + A11 (2013)
 EN 60079-7 (2007)
 EN 60079-31 (2009)
 Device group : II
 Category : 2 and 3
 Atmospheres : G/D
 Zones : 1, 2, 21, 22

IP Rating

IP68

U.K. Office : Tel: +44 (0)141 941 3689

sales@expresselectrical.co.uk

www.expresselectrical.co.uk

U.A.E. Office : Tel: +971 (0)4 887 5570

info@expresselectrical.ae

www.expresselectrical.ae

LV Resin Cable Joints - Straight

Resin filled jointing kits for armoured cables up to 1kV. The clear injection moulded rigid high-impact joint shells allow easy viewing to aid correct installation. Armour continuity bonding components are supplied with every shell and include connectors, earth braid, constant force springs, core separators, 2-part resin, sealing tape, gloves and installation instructions. Filling the joint is easy with a convenient pouring funnel and sealing cap, with proven two-part polyurethane resin supplied in foil packs.



Part Number	Selection Chart Colour	Joint Length (A)	Joint Diameter (B)	Cable Entry Ø (C)	Cable Range (mm ²)	Max 4 Core (mm ²)	2-Part Resin Qty
EJK-RS-06-4		200	35	5 - 20	1.5 - 10	6	200ml
EJK-RS-16-4		250	45	8 - 30	10 - 25	16	350ml
EJK-RS-25-4		320	60	10 - 34	25 - 35	25	750ml
EJK-RS-35-4		355	72	26 - 53	35 - 150	70	1.2 litres

All dimensions are in mm

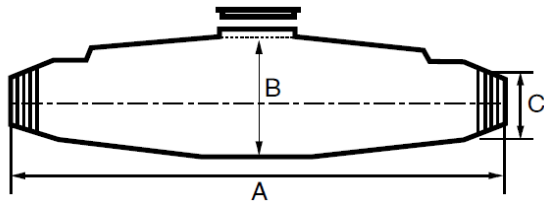

Selection Chart - Straight jointing kits

No of Cores	Armoured Cable Size (mm ²)												
	1.5	2.5	4	6	10	16	25	35	50	70	95	120	150
1													
2													
3													
4													

Injection Moulded Shells

Rigid and very strong cable jointing shells with snap-lock design provide an excellent seal and prevents any resin leakage.

Mechanical Connectors

Machined brass connectors are included and are suitable for low voltage cables with copper or aluminium conductors.

Earth Braid

The flat, soft braid ensures excellent electrical contact and is insulated for extra protection.

Constant Force Springs

Cable joints are subject to cyclical movement and expansion due to earth shift and heat from electrical current. Constant force springs react to this movement and maintain a sound electrical connection between the steel wire armouring and the earth continuity braid.

Core Separators

Provide safe separation of cable cores and mechanical connectors.

Two-part resin

Cable joint resin is suitable for LV jointing of cables with excellent adhesion to PVC, XLPE, polythene, and paper cables. Resin is supplied in a 2-part easy mix packaging, ensuring both convenience and safety.

Installation Guide

Detailed instruction sheet provided showing the cable jointing procedure.



Technical Datasheet



Applications

LV cable joints
Suitable for SWA cables
(PVC and XLPE)

Rating

Max voltage rating: 1kV

Approvals

Tested to EN 50393:2006-11

Kit contents

- 1 x clear snap-lock shell
- 4 x connectors
- 2 x constant force springs
- 1 x earth braid
- 1 x PVC tape
- 1 x resin pouch
- 1 x pair protective gloves
- 1 x instructions

LV Resin Cable Joints - Branch

Resin filled branch jointing kits are ideal for LV cable joints in trench or cable tray. The fully waterproof, no resin leakage shell can be used in direct burial applications and outdoor exposed cables. Suitable for armoured cables up to 1kV, the clear shell allows easy viewing to aid correct installation. Armour continuity bonding components are supplied with every shell and include connectors, earth braid, constant force springs, core separators, 2-part resin, sealing tape, gloves and installation instructions.



Part Number	Selection Chart Colour	Joint Length (A)	Joint Diameter (B)	Cable Entry Ø (C)	Cable Range (mm ²)	Max 4 Core (mm ²)	2-Part Resin Qty
EJK-RB-16-4		335	110	10 - 30	10 - 16	16	1.85 litres
EJK-RB-35-4		420	120	15 - 30	25 - 35	35	2.65 litres

All dimensions are in mm

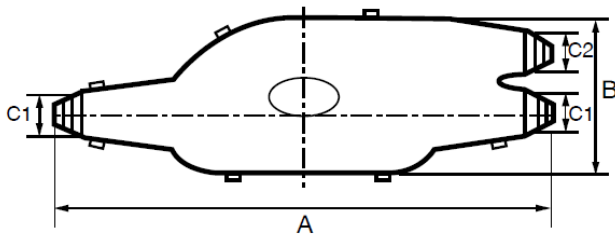

Selection Chart - Branch jointing kits

No of Cores	Armoured Cable Size (mm ²)												
	1.5	2.5	4	6	10	16	25	35	50	70	95	120	150
1													
2													
3													
4													

Injection Moulded Shells

Rigid and very strong cable jointing shells with snap-lock design provide an excellent seal and prevents any resin leakage.

Mechanical Connectors

Machined brass connectors are included and are suitable for low voltage cables with copper or aluminium conductors.

Earth Braid

The flat, soft braid ensures excellent electrical contact and is insulated for extra protection.

Constant Force Springs

Cable joints are subject to cyclical movement and expansion due to earth shift and heat from electrical current. Constant force springs react to this movement and maintain a sound electrical connection between the steel wire armouring and the earth continuity braid.

Core Separators

Provide safe separation of cable cores and mechanical connectors.

Two-part resin

Cable joint resin is suitable for LV jointing of cables with excellent adhesion to PVC, XLPE, polythene, and paper cables. Resin is supplied in a 2-part easy mix packaging, ensuring both convenience and safety.

Installation Guide

Detailed instruction sheet provided showing the cable jointing procedure.



Technical Datasheet



Applications

LV cable joints
Suitable for SWA cables
(PVC and XLPE)

Rating

Max voltage rating: 1kV

Approvals

Tested to EN 50393:2006-11

Kit contents

- 1 x clear snap-lock shell
- 4 x connectors
- 3 x constant force springs
- 2 x earth braid
- 1 x PVC tape
- 1 x resin pouch
- 1 x pair protective gloves
- 1 x instructions