

## How to install the printer driver

Follow these steps for the printer models shown opposite.

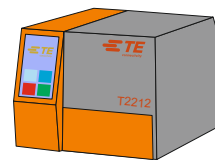

**T2212**

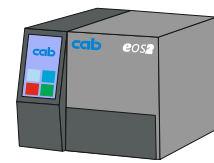

**EOS2**

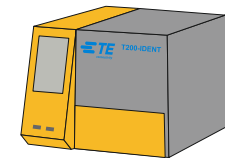

**T200-IDENT**

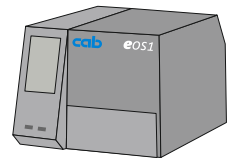

**EOS1**

### 1. Connect T200 or EOS1

#### T200-IDENT and EOS1

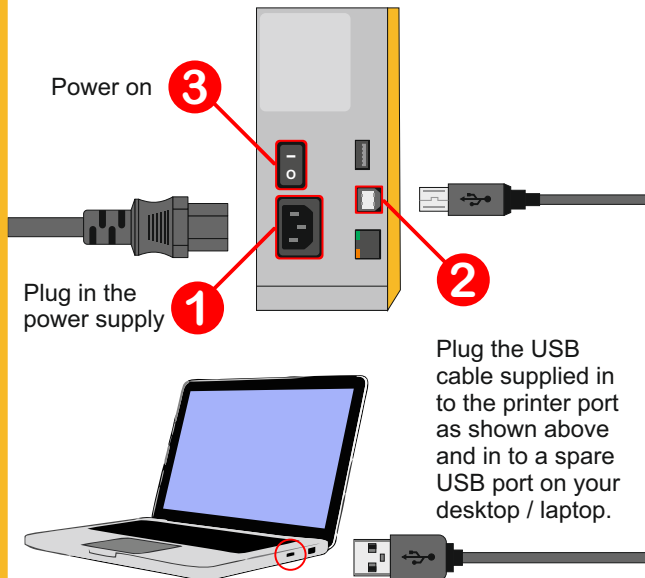
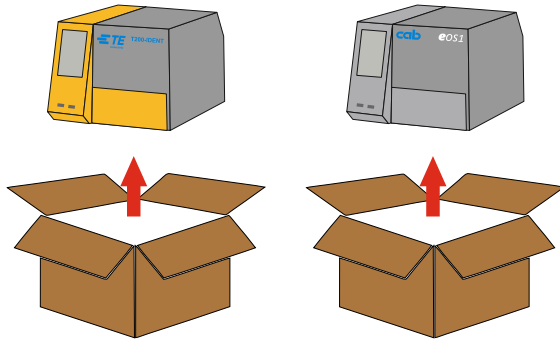

**Note :** Always use the same USB port on your PC for the printer you are installing.

### 1. Connect T2212 or EOS2

#### T2212 and EOS2

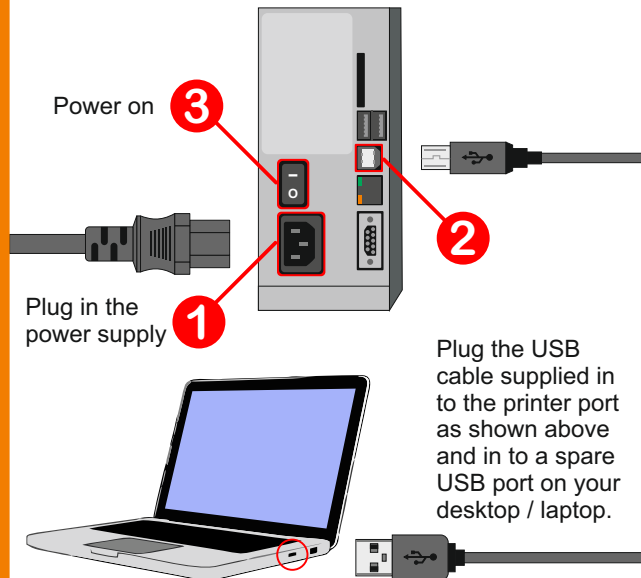
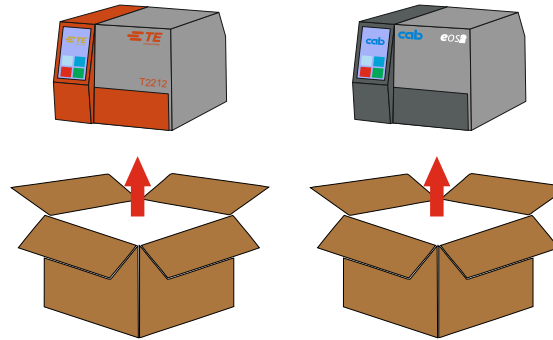

**Note :** Always use the same USB port on your PC for the printer you are installing.

### 2. Install Printer Driver

#### Power on your printer

- Download the TE driver. (V1.3.0.1)
- Extract the zip file.
- Open the folder, and double click to run the driver.

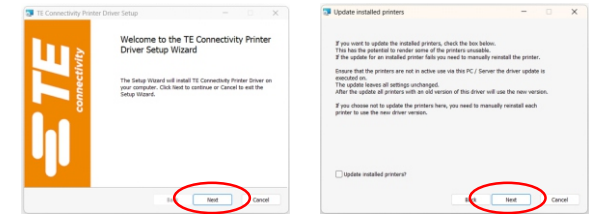

**1**

**2**

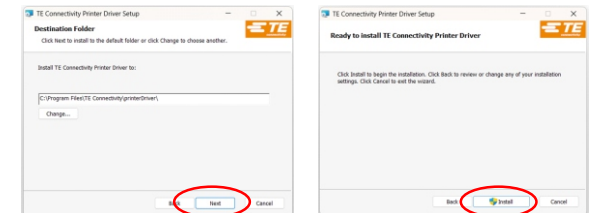

**3**

**4**

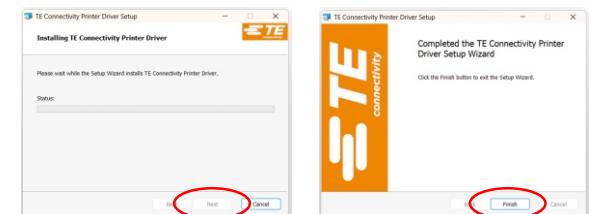

**5**

**6**

If your company settings require it, you will be asked for admin password here.

## How to install WinTotal v7.2.01

Follow these steps for the printer models shown opposite.

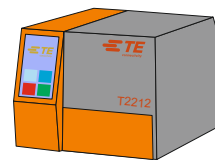

**T2212**

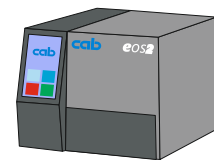

**EOS2**

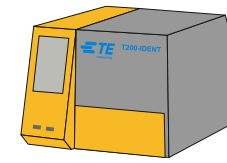

**T200-IDENT**

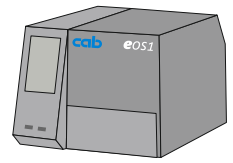

**EOS1**

### 3. Install WinTotal Software

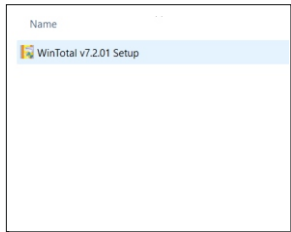

**1** Double click the WinTotal setup icon.

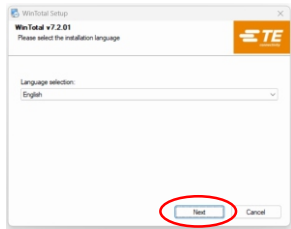

**2** Select language  
Click "Next".

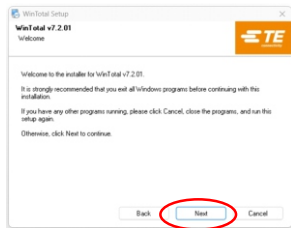

**3** Click "Next".

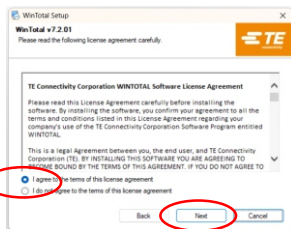

**4** Select "I Agree ..."  
Click "Next".

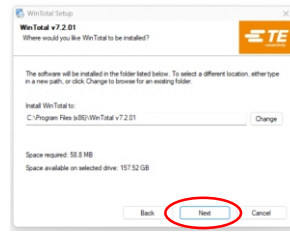

**5** Click "Next".

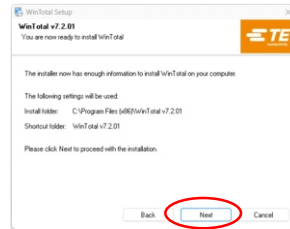

**6** Click "Next".

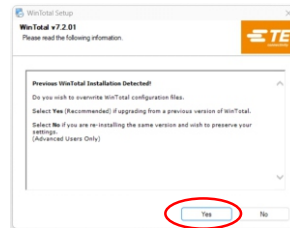

**7** Click "Yes".

*This stage only appears if you have a previous version of WinTotal installed.*

Please note you now have two options at stage **8**  
Option 1 is designed for T200-IDENT and EOS1 printers  
Option 2 is designed for T2212 and EOS2 printers  
Follow the correct settings for your printer model

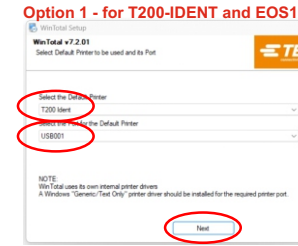

**8** Select "T200-IDENT".  
Select correct USB port.



**T200-IDENT**

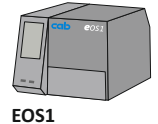

**EOS1**

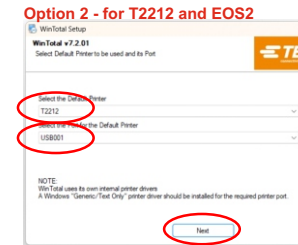

**8** Select "T2212".  
Select correct USB port.

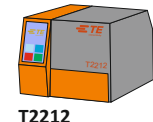

**T2212**

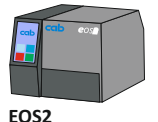

**EOS2**

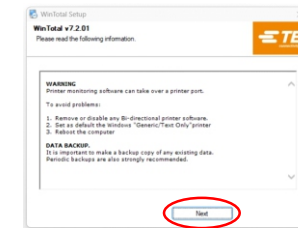

**9** Click "Next".

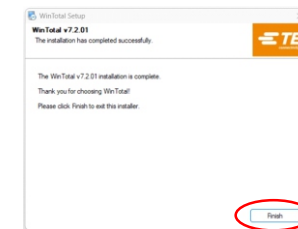

**10** Click "Finish".

## How to add expressMARK products and settings

Follow these steps for the printer models shown opposite.

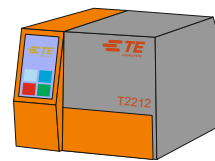

T2212

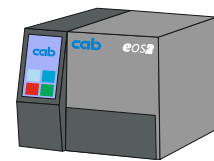

EOS2

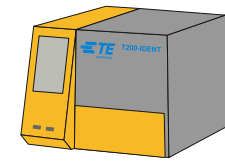

T200-IDENT

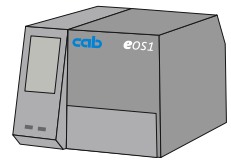

EOS1

### 4. Add expressMARK Products

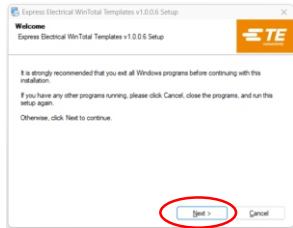

- 1 Double click the Express Electrical WinTotal Templates v1.0.0.06 Setup icon.

The "Welcome" install window will open. Click "Next".

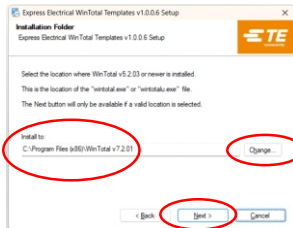

- 2 Click "Change" and ensure the "Install to" file location is set to "WinTotal v7.2.01".

Click "Next".

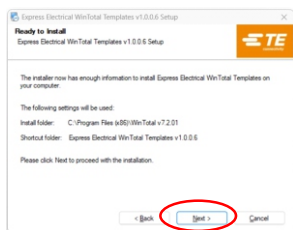

- 3 Click "Next".

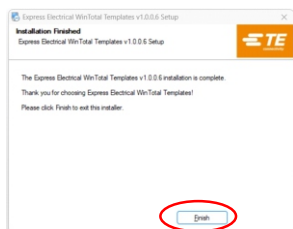

- 4 Click "Finish".

### 5. Set "ETM" Print Settings

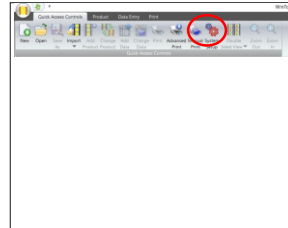

- 1 Open WinTotal  
Click "System Setup" icon on the toolbar

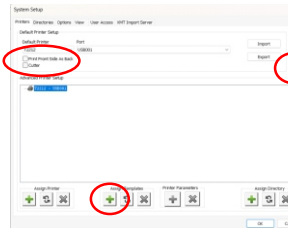

- 2 Ensure the circled settings are correct.  
Highlight the printer  
Click the + icon under "Assign Templates".

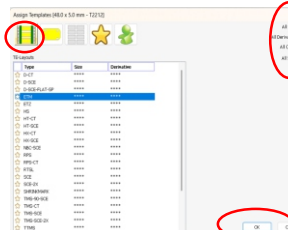

- 3 Select "Sleeve" icon  
Tick all options top right  
Highlight ETM  
Click "OK"

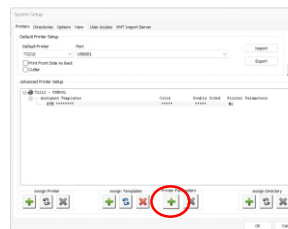

- 4 Highlight "ETM"  
Click the + icon under "Printer Parameters".

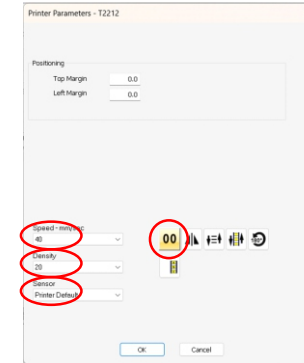

- 5 Setting these parameters now ensures they become default for this family of products. These settings will auto populate when printing ETM markers.

Ensure all settings are as circled and then click "OK"

Speed = 40

Density = 20

Sensor = Printer Default

Select "Leading zeros"

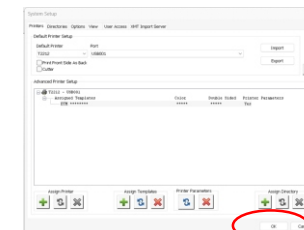

- 6 Click "OK"

## How to create non-standard expressMARK products

Follow these steps for the printer models shown opposite.

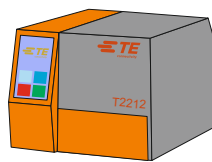

T2212

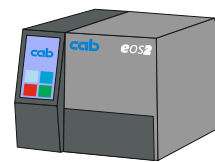

EOS2

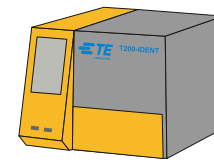

T200-IDENT

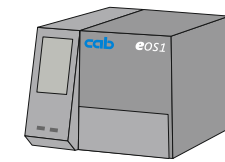

EOS1

### 6. Create "ETC" Ladder Markers

This step is only required for ETC "ladder format" markers. Skip to Step 7 if not printing the part numbers shown below.

Applicable part numbers are :

ETC- (COLOUR) -012040-D

ETC- (COLOUR) -012055-D

ETC- (COLOUR) -025055-C

ETC- (COLOUR) -010070-D

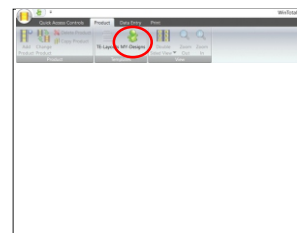
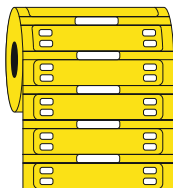

**1** Use the "My Designs" function within the WinTotal software to create non-standard products such as ETC ladder format.

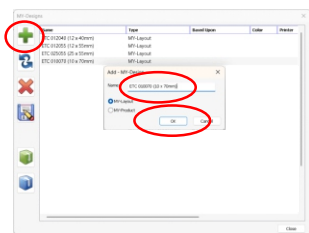

**2** Click the + icon.  
Type the part number in "Name" box  
Click "OK"

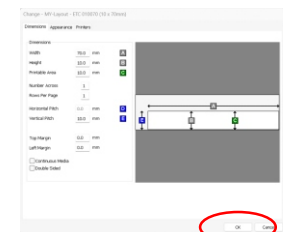

**3** "Dimensions" tab  
Ensure the printable area dimensions of the ETC markers are entered correctly.  
Click "OK"

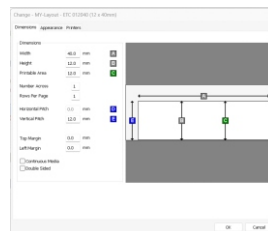

**3** **ETC-X-012040-D** settings :  
Width = 40.0  
Height = 12.0  
Printable Area = 12.0  
Number Across = 1  
Rows Per Page = 1  
Horizontal Pitch = 0.0  
Vertical Pitch = 12.0  
Top Margin = 0.0  
Left Margin = 0.0

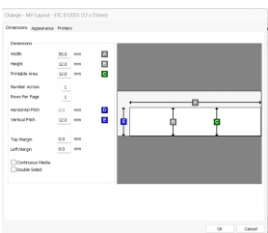

**3** **ETC-X-012055-D** settings :  
Width = 55.0  
Height = 12.0  
Printable Area = 12.0  
Number Across = 1  
Rows Per Page = 1  
Horizontal Pitch = 0.0  
Vertical Pitch = 12.0  
Top Margin = 0.0  
Left Margin = 0.0



**3** **ETC-X-025055-D** settings :  
Width = 55.0  
Height = 25.0  
Printable Area = 25.0  
Number Across = 1  
Rows Per Page = 1  
Horizontal Pitch = 0.0  
Vertical Pitch = 25.0  
Top Margin = 0.0  
Left Margin = 0.0



**3** **ETC-X-010070-D** settings :  
Width = 70.0  
Height = 10.0  
Printable Area = 10.0  
Number Across = 1  
Rows Per Page = 1  
Horizontal Pitch = 0.0  
Vertical Pitch = 10.0  
Top Margin = 0.0  
Left Margin = 0.0

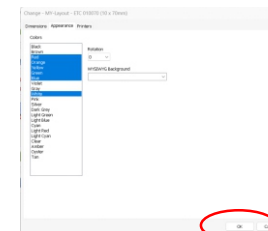

**4** "Appearance" tab  
Select the colours of the product you wish to print.  
Click "OK"

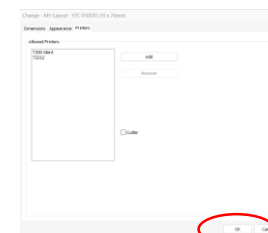

**5** "Printers" tab  
Add T200 Ident and T2212 to the list.  
Click "OK"

Repeat the process for each size if you are using multiple sizes of ETC ladder format cable markers.

## How to set expressMARK ETC print settings

Follow these steps for the printer models shown opposite.

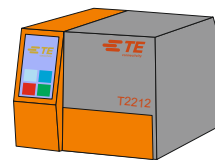

T2212

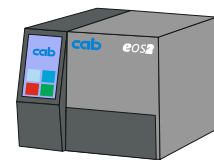

EOS2

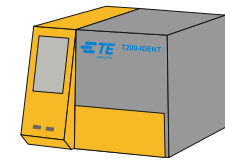

T200-IDENT

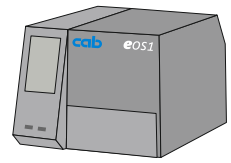

EOS1

### 7. Set "ETC" Print Settings

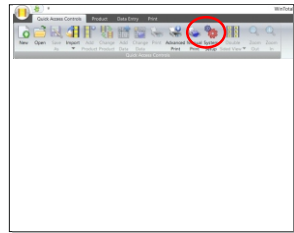

- 1 Open WinTotal  
Click "System Setup"  
icon on the toolbar

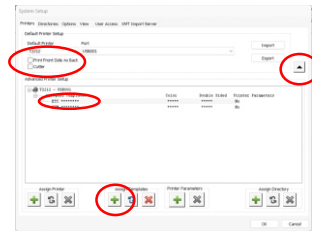

- 2 Ensure the circled settings are correct.  
Highlight the printer  
Click the + icon under  
"Assign Templates".

#### Option 1 - for Continuous ETC Markers

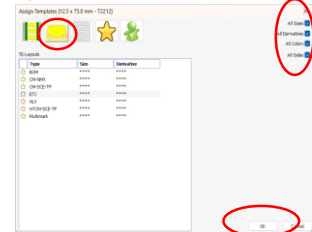

- 3 Select "Cable Marker" icon  
Tick all options top right  
Highlight ETC  
Click "OK"

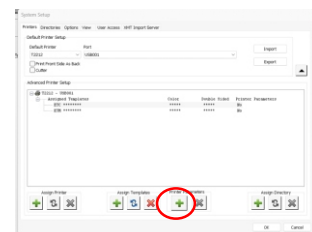

- 4 Highlight "ETC"  
Click the + icon under  
"Printer Parameters".

#### Step 3 Option 1 - for ETC "Continuous" format cable markers.

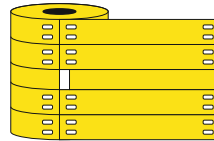

ETC- (COLOUR) -012060-C  
ETC- (COLOUR) -025080-B  
ETC- (COLOUR) -060080-B

#### Step 3 Option 2 - for ETC "Ladder" format cable markers.

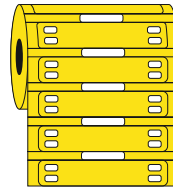

ETC- (COLOUR) -012040-D  
ETC- (COLOUR) -012055-D  
ETC- (COLOUR) -025055-C  
ETC- (COLOUR) -010070-D

#### Option 2 - for Ladder ETC Markers

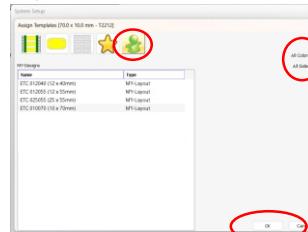

- 3 Select "MY-Designs" icon  
Tick all options top right  
Highlight one ETC marker  
Click "OK"

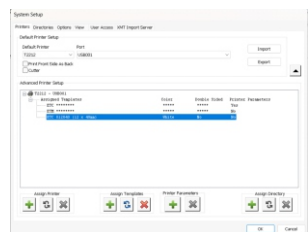

- 4 Highlight the "ETC"  
Click the + icon under  
"Printer Parameters".

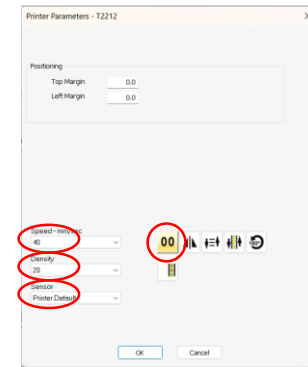

- 5 Setting these parameters  
now ensures they become  
default for this family of  
products. These settings  
will auto populate when  
printing ETM markers.

Ensure all settings are as  
circled and then click "OK"

Speed = 40

Density = 20

Sensor = Printer Default

Select "Leading zeros"

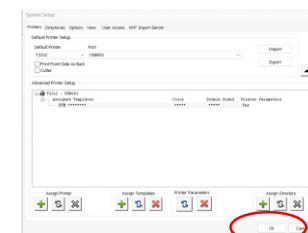

- 6 Click "OK"

#### IMPORTANT NOTE FOR LADDER FORMAT CABLE MARKER USERS.

If you are printing multiple ladder format ETC part numbers please repeat  
steps 3 to 6 for each part number you intend to print.

## How to install multiple printers to one PC

Follow these steps for the printer models shown opposite.

This set up is ideal for volume users who wish to dedicate printers to different products.

### Example

Printer 1 - for ETM sleeves

Printer 2 - for yellow ETC cable markers

Printer 3 - for white ETC cable markers

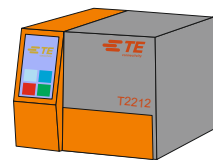
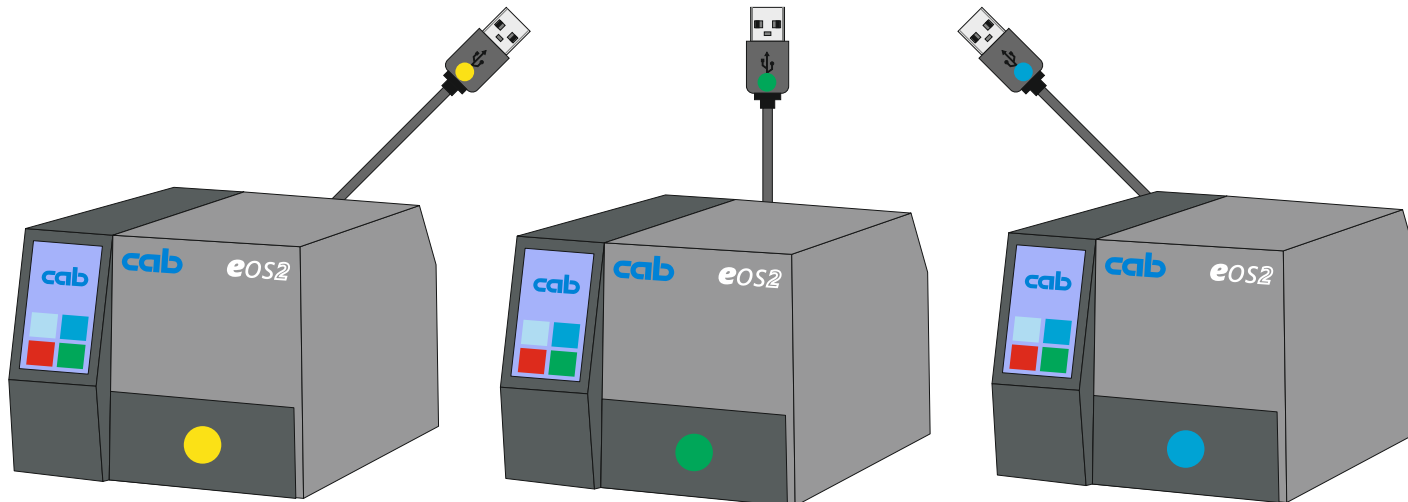
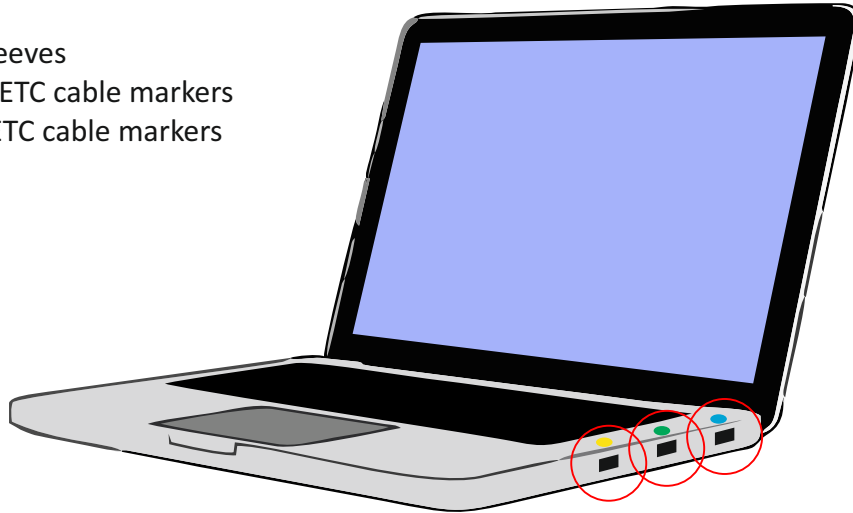

T2212

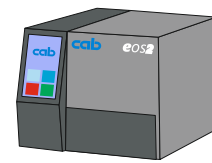

EOS2

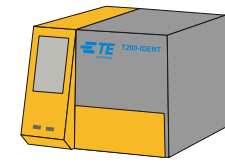

T200-IDENT

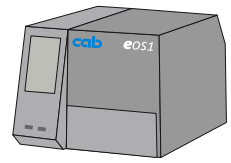

EOS1

### Install driver for each printer

Only connect one printer at a time

Step 1 : Plug into a free USB port.

Step 2 : Install the printer driver

Step 3 : Take note of the USB port

Step 4 : Mark the port and printer

Repeat the above process for each printer in separate USB ports.

Please ensure you **ALWAYS** plug installed printers in to the same USB port to avoid errors when printing from WinTotal.

You can now install WinTotal and allocate different products to each installed printer.

Open WinTotal.

Click "System Setup"

Use the "Assign Printer" feature to add printers, ports and then assign products to each printer.

If you are unable to set this up please contact our office and ask for assistance setting up WinTotal to print to multiple printers.