

## expressTERM Terminal Kits

### ECL-KIT1 Copper Tube Terminals Kit

A copper tube terminals kit supplied in a robust carry case with removable compartments. Kit includes:

- ECSB-L** large compartment storage box 1pc
- ECT16** copper tube crimp tool for 2.5-16.0mm<sup>2</sup> 1pc
- TAPE-0-19X33M-PVC** 19mm x 33M PVC Black 2pcs

- ECL6-6** terminal 6mm<sup>2</sup> with 6mm stud 50pcs
- ECL6-8** terminal 6mm<sup>2</sup> with 8mm stud 50pcs
- ECL10-6** terminal 10mm<sup>2</sup> with 6mm stud 50pcs
- ECL10-8** terminal 10mm<sup>2</sup> with 8mm stud 50pcs
- ECL16-6** terminal 16mm<sup>2</sup> with 6mm stud 50pcs
- ECL16-8** terminal 16mm<sup>2</sup> with 8mm stud 50pcs

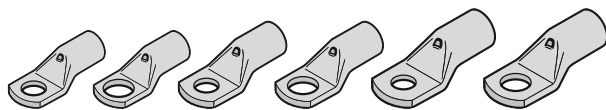

### ECL Copper Tube Terminals Selection Chart

A full range of copper tube terminals are available to order using the part numbers shown below.

Cable mm <sup>2</sup>	Stud Size							
	M5	M6	M8	M10	M12	M14	M16	M20
6	ECL6-5	ECL6-6	ECL6-8	ECL6-10				
10	ECL10-5	ECL10-6	ECL10-8	ECL10-10				
16	ECL16-5	ECL16-6	ECL16-8	ECL16-10	ECL16-12			
25		ECL25-6	ECL25-8	ECL25-10	ECL25-12			
35		ECL35-6	ECL35-8	ECL35-10	ECL35-12	ECL35-14		
50		ECL50-6	ECL50-8	ECL50-10	ECL50-12	ECL50-14	ECL50-16	
70		ECL70-6	ECL70-8	ECL70-10	ECL70-12	ECL70-14	ECL70-16	
95			ECL95-8	ECL95-10	ECL95-12	ECL95-14	ECL95-16	
120			ECL120-8	ECL120-10	ECL120-12	ECL120-14	ECL120-16	
150			ECL150-8	ECL150-10	ECL150-12	ECL150-14	ECL150-16	
185				ECL185-10	ECL185-12	ECL185-14	ECL185-16	ECL185-20
240				ECL240-10	ECL240-12	ECL240-14	ECL240-16	ECL240-20
300				ECL300-10	ECL300-12	ECL300-14	ECL300-16	ECL300-20
400					ECL400-12	ECL400-14	ECL400-16	ECL400-20
500					ECL500-12	ECL500-14	ECL500-16	ECL500-20
630					ECL630-12	ECL630-14	ECL630-16	ECL630-20

### Professional empty compartment storage boxes

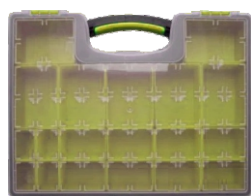

**ECSB-L**  
19 removable compartments  
420 x 330 x 55mm (WxDxH)



**ECSB-M**  
15 removable compartments  
200 x 300 x 50mm (WxDxH)



**ECSB-S**  
15 removable dividers  
212 x 138 x 43mm (WxDxH)

## Technical Data



### Material

Body : Copper  
Plating : Bright electro tin

### Rating

Max voltage rating: 3.3kV

### Features

Bell mouth for easy cable entry  
Excellent conductivity  
Corrosion resistant  
Suitable for heavy duty applications  
Inspection hole

### Tooling

Ratchet action crimp tool  
Ergonomic anti-slip handles  
Terminal range : 1.5 to 10mm<sup>2</sup>  
Tool length: 275mm  
Weight: 0.6 kgs  
Part Number : **ECT16**

Order additional terminals to personalise your own kit

Create your own kits with these professional compartment boxes

To purchase these products visit us online at [www.expresselectrical.co.uk](http://www.expresselectrical.co.uk)