

Copper Tube 4 hole transformer terminals

With a 4 x M8 stud fixing these transformer lugs are suitable for use with termination connections requiring holes with 25 x 35mm centres, found on the most common transformers. Manufactured from high grade electro tin plated copper tube and with a flared entry barrel to allow flexible and stranded cables to be inserted with ease.

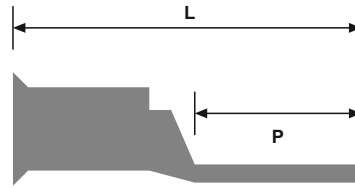

| Part Number | Wire Size (mm ²) | Pack Size (pcs) | Stud Size | Stud Centres (S1) | Stud Centres (S2) | Barrel Dia. (B) | Palm Width (W) | Palm Length (P) | Total Length (L) |
|-----------------|------------------------------|-----------------|-----------|-------------------|-------------------|-----------------|----------------|-----------------|------------------|
| ETL185-4 | 185 | 1 | 4 x M8 | 25 | 35 | 18.5 | 34.0 | 34.0 | 78.0 |
| ETL240-4 | 240 | 1 | 4 x M8 | 25 | 35 | 21.0 | 38.0 | 40.0 | 92.0 |
| ETL300-4 | 300 | 1 | 4 x M8 | 25 | 35 | 23.0 | 41.0 | 40.0 | 97.0 |
| ETL400-4 | 400 | 1 | 4 x M8 | 25 | 35 | 27.0 | 48.0 | 44.0 | 108.0 |
| ETL500-4 | 500 | 1 | 4 x M8 | 25 | 35 | 30.0 | 53.5 | 56.5 | 124.0 |
| ETL630-4 | 630 | 1 | 4 x M8 | 25 | 35 | 33.5 | 61.0 | 60.0 | 144.0 |

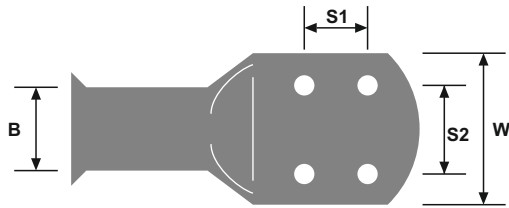

Technical Datasheet



Material

Body : Copper

Plating : Bright electro tin

Features

Bell mouth for easy cable entry

Excellent conductivity

Corrosion resistant

Suitable for heavy duty applications

Capatible with most transformer

Four hole lug design

Suits most transformer fixings