

E1W Weatherproof Cable gland kits

E1W brass glands are suitable for indoor and outdoor applications and meet IP rating IP66. The glands outer seal grips the sheath of the cable, and the inner seal grips the bedding layer of the cable. Suitable for use with SWA cable. Glands are manufactured to BS6121 : Part 1.



Part Number	Entry Thread Diameter (A)	Thread Length Minimum (B)	Cable Bedding Diameter (C)	Overall Cable Diameter (D)	Overall Gland Length (E)	Hex Size Across Flat (F)	Hex Size Across Corners (G)	Contents of each Per Kit
E1W20SK	M20	15	11.7	16.1	57.0	24.0	27.0	2
E1W20K	M20	15	13.9	21.1	63.0	27.0	30.0	2
E1W25K	M25	15	19.9	27.2	67.0	34.0	38.0	2
E1W32K	M32	15	26.2	33.9	70.0	40.5	45.0	2
E1W40K	M40	15	32.1	40.6	70.0	49.4	55.0	1
E1W50K	M50	15	44.0	55.7	84.0	62.0	69.0	1
E1W63K	M63	15	55.9	65.3	84.0	75.5	84.5	1

All dimensions are in mm

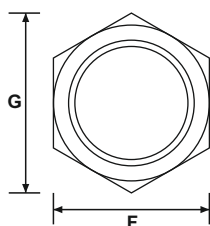
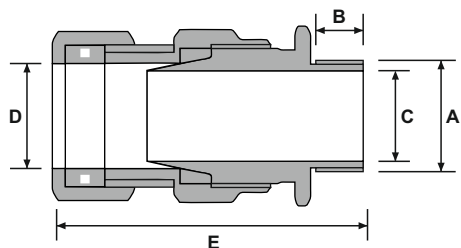

Technical Datasheet



Applications

Indoor and outdoor use
For exposed outdoor environments
Suitable for SWA cable
Glands to BS6121:Part 1

IP Rating

IP66

Kit contents

E1W20SK to E1W32K

2 x brass glands
2 x brass locknuts
2 x brass earth tags
2 x PVC shrouds

E1W40K to E1W63K

1 x brass gland
1 x brass locknut
1 x brass earth tag
1 x PVC shroud