

## ECG IP68 Nylon cable glands

The ECG range of nylon glands are suitable for indoor and outdoor applications, meet the requirements of IP68 and are suitable for use with unarmoured cables. The gland clamps to the cable and the finger-locking seal provides superior cable retention & strain relief.

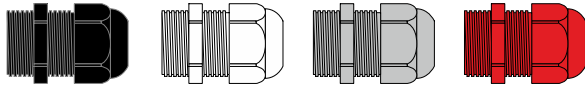

Part Number Black	Part Number White	Part Number Grey	Part Number Red	Thread Dia (A)	Thread Length (B)	Cable Dia (C)	Gland Length (D)	Across Flats (E)
ECG12BLK	ECG12WHT	ECG12GRY	ECG12RED	M12	8	2.5 - 6	32	16
ECG16BLK	ECG16WHT	ECG16GRY	ECG16RED	M16	10	5 - 10	34	22
ECG20BLK	ECG20WHT	ECG20GRY	ECG20RED	M20	10	6 - 12	43	24
ECG25BLK	ECG25WHT	ECG25GRY	ECG25RED	M25	10	13 - 18	47	33
ECG32BLK	ECG32WHT	ECG32GRY	ECG32RED	M32	15	18 - 25	54	42
ECG40BLK	ECG40WHT	ECG40GRY	ECG40RED	M40	18	22 - 32	62	53
ECG50BLK	ECG50WHT	ECG50GRY	ECG50RED	M50	18	30 - 38	67	60
ECG63BLK	ECG63WHT	ECG63GRY	ECG63RED	M63	18	34 - 44	68	70

All dimensions are in mm

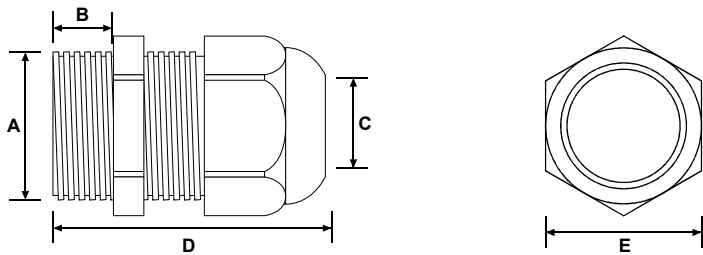

## LN Nylon locknuts

The LN range of nylon locknuts are designed for use with nylon cable glands. Secures the glands in place and can be tightened by hand or with use of a spanner.

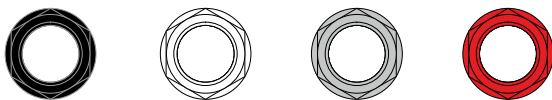

Part Number Black	Part Number White	Part Number Grey	Part Number Red	Description
LN12B	LN12W	LN12G	LN12R	M12 x 1.5mm nylon locknut
LN16B	LN16W	LN16G	LN16R	M16 x 1.5mm nylon locknut
LN20B	LN20W	LN20G	LN20R	M20 x 1.5mm nylon locknut
LN25B	LN25W	LN25G	LN25R	M25 x 1.5mm nylon locknut
LN32B	LN32W	LN32G	LN32R	M32 x 1.5mm nylon locknut
LN40B	LN40W	LN40G	LN40R	M40 x 1.5mm nylon locknut
LN50B	LN50W	LN50G	LN50R	M50 x 1.5mm nylon locknut
LN63B	LN63W	LN63G	LN63R	M63 x 1.5mm nylon locknut

All dimensions are in mm

## Technical Data



### Applications

Indoor and outdoor use

Use where waterproof seal is required

Suitable for unarmoured cable

### IP Rating

IP68

### Colours

Black

White

Grey (Ral 7035)

Red (Ral 3020)

### Material

Polyamide

### Operating temperature

-20°C up to 80°C

(intermittent up to 120°C)

### Features

IP68 rating

UL94 V2 low smoke and fume

Sizes from M12 to M63

To purchase these products visit us online at [www.expresselectrical.co.uk](http://www.expresselectrical.co.uk)

TERMINATE & CONNECT