

# THROUGH CONNECTORS

for Copper conductors

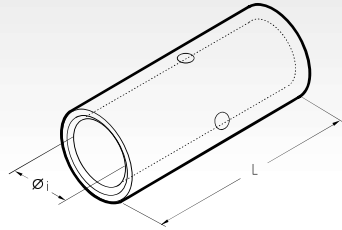

Conductor Size sqmm		Type	Dimensions mm		Quantity Box/Bag	Mechanical Tools	Hydraulic Tools
Low Stranded	Flexible		øi	L			
0,25÷1,5	0,25÷1,5	L03-M*	1,8	15	6.000/100		
1,5÷2,5	1,5÷2,5	L06-M*	2,4	15	4.000/100		
4÷6	4÷6	L1-M*	3,6	22	2.000/100	HN1	
10	10	L2-M	4,6	25	1.000/100	HN5	
16	16	L3-M	5,8	27	1.000/100	HN-A25	
25	25	L5-M	7,0	29	500/100	TN70SE	
35	25÷35	L7-M	8,9	33	400/100	TN120 SE*	B15MDE
50	35÷50	L10-M	10,0	37	200/50		HT45-E B450ND-BVE
70	50÷70	L14-M	11,3	39	200/50		HT51 B550E
95	70÷95	L19-M	13,5	43	100/25		RH50 B500E B500NDE
120	95÷120	L24-M	15,2	47	100/25		HT81-U RHU81
150	120÷150	L30-M	16,7	58	50/25		HT120 and tools and heads with 130 kN crimping force ECW-H3D RHU520
185	150÷185	L37-M	19,2	64	50/25		
240	185÷240	L48-M	21,1	75	30/15		
300	240÷300	L60-M	23,7	90	20/10		
400	300÷400	L80-M	27,0	94	15/5		
500	400÷500	L100-M	30,3	98	12/1		
630	500÷630	L120-M*	33,4	105	12/1		
800	600	L160-M*	38,0	112	9/1		
1000	800	L200-M*	44,0	120	6/1		

\*See page 121

## L-M

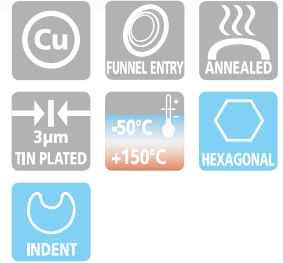

L-M range of connectors are designed for jointing low voltage conductors.

Made of electrolytic Copper tube having the same dimension as A-M series lugs: L-M connectors are annealed and electrolytically Tin plated. They feature an internal taper at both ends to ease the introduction of the conductor and a central stop to ensure correct positioning.

Details of the appropriate crimping tools and dies are shown on pages 206 to 207.

# PARALLEL CONNECTORS

for Copper conductors

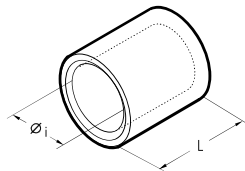

Total Conductor Size sqmm		Type	Dimensions mm		Quantity Box/Bag	Mechanical Tools	Hydraulic Tools
Low Stranded	Flexible		øi	L			
0,25÷1,5	0,25÷1,5	L03-P	1,8	6,0	10.000/100		
1,5÷2,5	1,5÷2,5	L06-P	2,4	6,0	5.000/100		
4÷6	4÷6	L1-P	3,6	9,0	3.000/100	HN1	
10	10	L2-P	4,6	10,5	3.000/100	HN5	
16	16	L3-P	5,8	11,5	2.000/100	HN-A25	
25	25	L5-P	7,0	13,0	1.500/100	TN70SE	
35	25÷35	L7-P	8,9	14,0	500/100	TN120 SE*	B15MDE
50	35÷50	L10-P	10,0	16,0	500/100		HT45-E B450ND-BVE
70	50÷70	L14-P	11,3	18,0	500/100		HT51 B550E
95	70÷95	L19-P	13,5	19,0	300/50		RH50 B500E B500NDE
120	95÷120	L24-P	15,2	22,0	200/50		HT81-U RHU81
150	120÷150	L30-P	16,7	26,5	100/50		HT120 and tools and heads with 130 kN crimping force ECW-H3D RHU520
185	150÷185	L37-P	19,2	26,5	100/50		
240	185÷240	L48-P	21,1	34,0	60/15		
300	240÷300	L60-P	23,7	43,0	50/25		

\*See page 121

## L-P



Made of electrolytic Copper tube, having the same dimensions as A-M series lugs, L-P connectors are annealed and electrolytically Tin plated. They feature an internal taper to ease the introduction of the conductor.

Details of the appropriate crimping tools and dies are shown on pages 206 to 207.

\*Not UL approved