

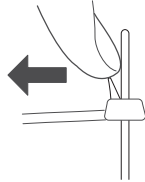

### Pan-Ty® Releasable Cable Ties – Nylon 6.6

- For indoor use
- Extended release tab permits easy release and re-use where changes are anticipated during development, production, or servicing in the field
- One-piece construction for consistent performance and reliability
- Curved tip is easy to pick up from flat surfaces and allows faster initial threading to speed installation
- UL Listed for use in plenum or air handling spaces per NEC except PRT2H/3H/4H



To release, grasp the head of the cable tie, deflect release tab, and pull the cable tie away from the bundle.

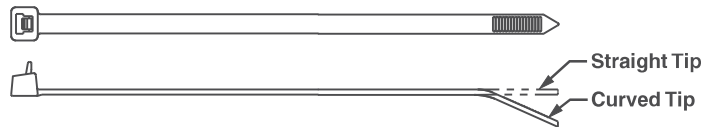

| Part Number   | Length |     | Width |     | Thickness |     | Max. Bundle Dia. |     | Min. Loop Tensile Str. |     | Recommended Installation Tool | Std. Pkg. Qty. | Std. Ctn. Qty. |
|---|--------|-----|-------|-----|-----------|-----|------------------|-----|------------------------|-----|-------------------------------|----------------|----------------|
|   | In.    | mm  | In.   | mm  | In.       | mm  | In.              | mm  | Lbs.                   | N   |                               |                |                |
| <b>Standard Cross Section — Plenum Rated UL Type 2S Rated</b> |        |     |       |     |           |     |                  |     |                        |     |                               |                |                |
| PRT1S-C   | 4.8    | 122 | 0.190 | 4.8 | 0.052     | 1.3 | 1.00             | 25  | 50                     | 222 | Hand install only             | 100            | 1000           |
| PRT1.5S-C   | 6.3    | 160 | 0.190 | 4.8 | 0.052     | 1.3 | 1.50             | 38  |                        |     |                               |                |                |
| PRT2S-C   | 7.4    | 188 | 0.190 | 4.8 | 0.052     | 1.3 | 1.88             | 48  |                        |     |                               |                |                |
| PRT3S-C   | 11.5   | 292 | 0.190 | 4.8 | 0.052     | 1.3 | 3.00             | 76  |                        |     |                               |                |                |
| PRT4S-C   | 14.5   | 368 | 0.190 | 4.8 | 0.052     | 1.3 | 4.00             | 102 |                        |     |                               |                |                |
| <b>Light-Heavy Cross Section (Straight Tip)</b>               |        |     |       |     |           |     |                  |     |                        |     |                               |                |                |
| PRT2H-L   | 8.4    | 213 | 0.300 | 7.6 | 0.075     | 1.9 | 2.00             | 51  | 80                     | 356 | Hand install only             | 50             | 500            |
| PRT3H-L   | 11.4   | 290 | 0.300 | 7.6 | 0.075     | 1.9 | 3.00             | 76  |                        |     |                               |                |                |
| PRT4H-L   | 14.5   | 368 | 0.300 | 7.6 | 0.075     | 1.9 | 4.00             | 102 |                        |     |                               |                |                |



### Pan-Ty® Releasable Lashing Ties – Nylon 6.6

- For indoor use
- Release tab permits easy release and re-use where changes are anticipated during development, production, or servicing in the field
- Typically used for heavy duty applications
- Among the strongest Pan-Ty® Cable Tie available
- Can be used with MCEH mounting clip, see page B1.22

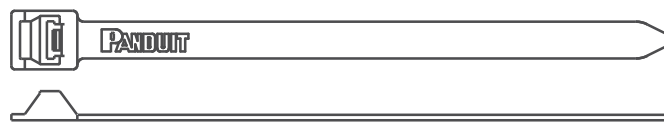

| Part Number                                     | Length |      | Width |      | Thickness |     | Max. Bundle Dia. |     | Min. Loop Tensile Str. |      | Recommended Installation Tool | Std. Pkg. Qty. | Std. Ctn. Qty. |
|---|--------|------|-------|------|-----------|-----|------------------|-----|------------------------|------|-------------------------------|----------------|----------------|
|   | In.    | mm   | In.   | mm   | In.       | mm  | In.              | mm  | Lbs.                   | N    |                               |                |                |
| <b>Extra-Heavy Cross Section — Plenum Rated</b> |        |      |       |      |           |     |                  |     |                        |      |                               |                |                |
| PRT2EH-C  | 9.0    | 229  | 0.500 | 12.7 | 0.075     | 1.9 | 2.00             | 51  | 250                    | 1112 | Hand install only             | 100            | 1000           |
| PRT5EH-Q  | 20.1   | 511  | 0.500 | 12.7 | 0.075     | 1.9 | 5.00             | 127 | 250                    | 1112 | Hand install only             | 25             | 250            |
| PRT6EH-Q  | 22.2   | 564  | 0.500 | 12.7 | 0.075     | 1.9 | 6.00             | 152 |                        |      |                               |                |                |
| PRT8EH-C  | 28.3   | 719  | 0.500 | 12.7 | 0.085     | 2.2 | 8.00             | 203 | 250                    | 1112 | Hand install only             | 100            | 1000           |
| PRT10EH-C                                       | 34.2   | 869  | 0.500 | 12.7 | 0.085     | 2.2 | 10.00            | 254 | 250                    | 1112 | Hand install only             | 100            | 500            |
| PRT12EH-C                                       | 40.1   | 1019 | 0.500 | 12.7 | 0.085     | 2.2 | 12.00            | 305 | 250                    | 1112 | Hand install only             | 50             | 500            |



## Pan-Ty® Releasable Cable Ties – Weather Resistant and Heat Stabilized Nylon 6.6

- Weather resistant material has greater resistance to damage caused by ultraviolet light – indoor or outdoor use
- Heat stabilized material for high temperature applications up to 239°F (115°C) – indoor use
- Extended release tab permits easy release and re-use where changes are anticipated during development, production, or servicing in the field
- One-piece construction for consistent performance and reliability
- Curved tip is easy to pick up from flat surfaces and allows faster initial threading to speed installation

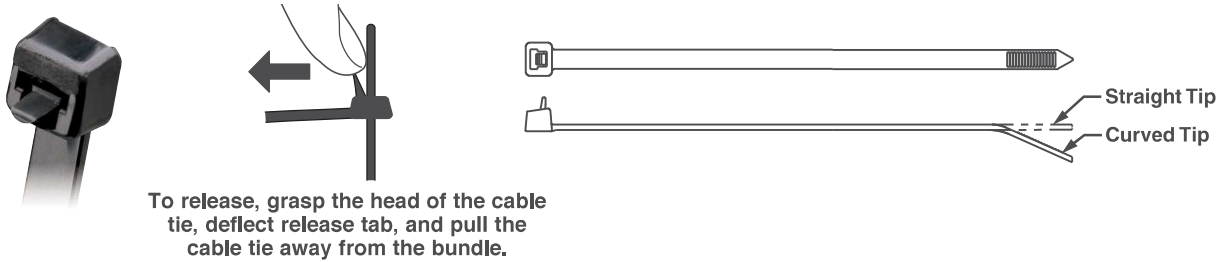

| Part Number | Length |    | Width |    | Thickness |    | Max. Bundle Dia. |    | Min. Loop Tensile Str. |   | Recommended Installation Tool | Std. Pkg. Qty. | Std. Ctn. Qty. |
|-------------|--------|----|-------|----|-----------|----|------------------|----|------------------------|---|-------------------------------|----------------|----------------|
|             | In.    | mm | In.   | mm | In.       | mm | In.              | mm | Lbs.                   | N |                               |                |                |

### Weather Resistant Nylon 6.6

#### Standard Cross Section ★ NEW! Plenum Rated ★ UL Type 2S Rated

| Part Number | Length (In.) | Length (mm) | Width (In.) | Width (mm) | Thickness (In.) | Thickness (mm) | Max. Bundle Dia. (In.) | Max. Bundle Dia. (mm) | Min. Loop Tensile Str. (Lbs.) | Min. Loop Tensile Str. (N) | Recommended Installation Tool | Std. Pkg. Qty. | Std. Ctn. Qty. |
|-------------|--------------|-------------|-------------|------------|-----------------|----------------|------------------------|-----------------------|-------------------------------|----------------------------|-------------------------------|----------------|----------------|
| PRT1S-C0    | 4.8          | 122         | 0.190       | 4.8        | 0.052           | 1.3            | 1.00                   | 25                    | 50                            | 222                        | Hand install only             | 100            | 1000           |
| PRT1.5S-C0  | 6.3          | 160         | 0.190       | 4.8        | 0.052           | 1.3            | 1.50                   | 38                    |                               |                            |                               |                |                |
| PRT2S-C0    | 7.4          | 188         | 0.190       | 4.8        | 0.052           | 1.3            | 1.88                   | 48                    |                               |                            |                               |                |                |
| PRT3S-C0    | 11.5         | 292         | 0.190       | 4.8        | 0.052           | 1.3            | 3.00                   | 76                    |                               |                            |                               |                |                |
| PRT4S-C0    | 14.5         | 368         | 0.190       | 4.8        | 0.052           | 1.3            | 4.00                   | 102                   |                               |                            |                               |                |                |

#### Light-Heavy Cross Section (Straight Tip)

| Part Number | Length (In.) | Length (mm) | Width (In.) | Width (mm) | Thickness (In.) | Thickness (mm) | Max. Bundle Dia. (In.) | Max. Bundle Dia. (mm) | Min. Loop Tensile Str. (Lbs.) | Min. Loop Tensile Str. (N) | Recommended Installation Tool | Std. Pkg. Qty. | Std. Ctn. Qty. |
|-------------|--------------|-------------|-------------|------------|-----------------|----------------|------------------------|-----------------------|-------------------------------|----------------------------|-------------------------------|----------------|----------------|
| PRT2H-L0    | 8.4          | 213         | 0.300       | 7.6        | 0.075           | 1.9            | 2.00                   | 51                    | 80                            | 356                        | Hand install only             | 50             | 500            |
| PRT3H-L0    | 11.4         | 290         | 0.300       | 7.6        | 0.075           | 1.9            | 3.00                   | 76                    |                               |                            |                               |                |                |
| PRT4H-L0    | 14.5         | 368         | 0.300       | 7.6        | 0.075           | 1.9            | 4.00                   | 102                   |                               |                            |                               |                |                |

### Heat Stabilized Nylon 6.6

#### Standard Cross Section

|             |     |     |       |     |       |     |      |    |    |     |                   |      |      |
|-------------|-----|-----|-------|-----|-------|-----|------|----|----|-----|-------------------|------|------|
| PRT1.5S-M30 | 6.3 | 160 | 0.190 | 4.8 | 0.052 | 1.3 | 1.50 | 38 | 50 | 222 | Hand install only | 1000 | 1000 |
|-------------|-----|-----|-------|-----|-------|-----|------|----|----|-----|-------------------|------|------|

### **UL US** **CS** **Pan-Ty® Releasable Lashing Ties – Weather Resistant and Heat Stabilized Nylon 6.6**

- Weather resistant material has greater resistance to damage caused by ultraviolet light – indoor or outdoor use
- Heat stabilized material for high temperature applications up to 239°F (115°C) – indoor use
- Release tab permits easy release and re-use where changes are anticipated during development, production, or servicing in the field
- Typically used for heavy duty applications
- Among the strongest Pan-Ty® Cable Tie available
- Can be used with MCEH mounting clip shown below

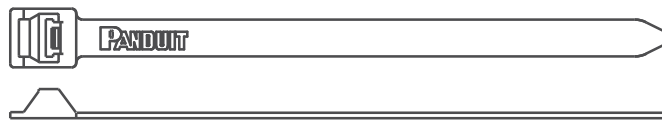

| Part Number                        | Length |      | Width |      | Thickness |     | Max. Bundle Dia. |     | Min. Loop Tensile Str. |      | Recommended Installation Tool | Std. Pkg. Qty. | Std. Ctn. Qty. |
|------------------------------------|--------|------|-------|------|-----------|-----|------------------|-----|------------------------|------|-------------------------------|----------------|----------------|
|                                    | In.    | mm   | In.   | mm   | In.       | mm  | In.              | mm  | Lbs.                   | N    |                               |                |                |
| <b>Weather Resistant Nylon 6.6</b> |        |      |       |      |           |     |                  |     |                        |      |                               |                |                |
| <b>Extra-Heavy Cross Section</b>   |        |      |       |      |           |     |                  |     |                        |      |                               |                |                |
| PRT2EH-Q0                          | 9.0    | 229  | 0.500 | 12.7 | 0.075     | 1.9 | 2.00             | 51  | 250                    | 1112 | Hand install only             | 25             | 250            |
| PRT5EH-Q0                          | 20.1   | 511  | 0.500 | 12.7 | 0.075     | 1.9 | 5.00             | 127 |                        |      |                               |                |                |
| PRT6EH-Q0                          | 22.2   | 564  | 0.500 | 12.7 | 0.075     | 1.9 | 6.00             | 152 |                        |      |                               |                |                |
| PRT8EH-Q0                          | 28.3   | 719  | 0.500 | 12.7 | 0.085     | 2.2 | 8.00             | 203 |                        |      |                               |                |                |
| PRT10EH-Q0                         | 34.2   | 869  | 0.500 | 12.7 | 0.085     | 2.2 | 10.00            | 254 |                        |      |                               |                |                |
| PRT12EH-Q0                         | 40.1   | 1019 | 0.500 | 12.7 | 0.085     | 2.2 | 12.00            | 305 |                        |      |                               |                |                |

|                                  |      |     |       |      |       |     |      |     |     |      |                   |     |      |
|----------------------------------|------|-----|-------|------|-------|-----|------|-----|-----|------|-------------------|-----|------|
| <b>Heat Stabilized Nylon 6.6</b> |      |     |       |      |       |     |      |     |     |      |                   |     |      |
| <b>Extra-Heavy Cross Section</b> |      |     |       |      |       |     |      |     |     |      |                   |     |      |
| PRT5EH-C30*                      | 20.1 | 511 | 0.500 | 12.7 | 0.075 | 1.9 | 5.00 | 127 | 250 | 1112 | Hand install only | 100 | 1000 |

\*PRT5EH-C30 not UL or CSA certified

### **UL US LISTED** **Lashing Tie Mounting Clip – Weather Resistant Nylon 6.6**

- Greater resistance to damage caused by ultraviolet light – indoor or outdoor use
- Converts Panduit® lashing ties into clamps
- Easily snaps in place for a secure clamp
- Use with lashing ties shown on pages B1.9, B1.11, B1.20, B1.22 and B1.23

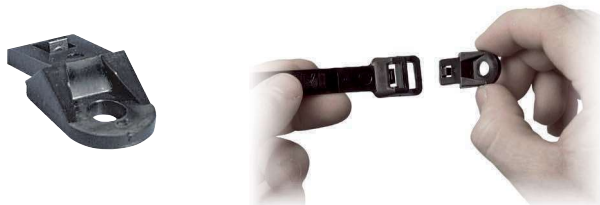

| Part Number | Height A |     | Width B |      | Length C |    | Mounting Method                | Std. Pkg. Qty. | Std. Ctn. Qty. |
|-------------|----------|-----|---------|------|----------|----|--------------------------------|----------------|----------------|
|             | In.      | mm  | In.     | mm   | In.      | mm |                                |                |                |
| MCEH-S25-C0 | .13      | 3.3 | .67     | 17.0 | 1.38     | 35 | 1/4" (M6) screw (not flathead) | 100            | 1000           |

### Pan-Ty® Releasable Lashing Ties – Weather Resistant Polypropylene

- For chemical resistance where high loop tensile strength is not required especially in the presence of hydrochloric acid, salts, and bases
- Greater resistance to damage caused by ultraviolet light – indoor or outdoor use
- Release tab permits easy release and re-use where changes are anticipated during development, production, or servicing in the field
- Typically used for heavy duty applications
- Can be used with MCEH mounting clip, see page B1.22

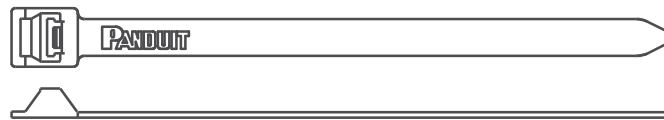

| Part Number                      | Length |     | Width |      | Thickness |     | Max. Bundle Dia. |     | Min. Loop Tensile Str. |     | Recommended Installation Tool | Std. Pkg. Qty. | Std. Ctn. Qty. |
|----------------------------------|--------|-----|-------|------|-----------|-----|------------------|-----|------------------------|-----|-------------------------------|----------------|----------------|
|                                  | In.    | mm  | In.   | mm   | In.       | mm  | In.              | mm  | Lbs.                   | N   |                               |                |                |
| <b>Extra-Heavy Cross Section</b> |        |     |       |      |           |     |                  |     |                        |     |                               |                |                |
| PRT2EH-C100                      | 9.0    | 229 | 0.500 | 12.7 | 0.075     | 1.9 | 2.00             | 51  | 90                     | 400 | Hand install only             | 100            | 1000           |
| PRT5EH-C100                      | 20.1   | 511 | 0.500 | 12.7 | 0.075     | 1.9 | 5.00             | 127 |                        |     |                               |                |                |
| PRT6EH-C100                      | 22.2   | 564 | 0.500 | 12.7 | 0.075     | 1.9 | 6.00             | 152 |                        |     |                               |                |                |
| PRT8EH-C100                      | 28.3   | 719 | 0.500 | 12.7 | 0.085     | 2.2 | 8.00             | 203 |                        |     |                               |                |                |