

terminate and connect with
expressTERM



TERMINATE & CONNECT



Ring Pre-insulated terminals

Part Number	Range (mm ²)	Pack Qty (pcs)	Stud Size	Dia (S)	Width (W)	Length (L)	Dia (d)	
ERR32	0.5 – 1.5	100	3.0	3.3	5.5	17.5	1.7	
ERR37		100	3.5	3.8	5.5	17.5	1.7	
ERR43		100	4.0	4.4	6.6	19.4	1.7	
ERR53		100	5.0	5.4	8.0	20.8	1.7	
ERR64		100	6.0	6.5	11.6	26.7	1.7	
ERR84		100	8.0	8.5	11.6	26.7	1.7	
ERR105		100	10.0	10.5	13.0	30.5	1.7	
ERR13		100	12.0	13.0	18.0	35.4	1.7	
EBR32		1.5 – 2.5	100	3.0	3.3	6.6	17.8	2.3
EBR37			100	3.5	3.8	6.6	17.8	2.3
EBR43	100		4.0	4.4	6.6	21.8	2.3	
EBR53	100		5.0	5.4	8.5	21.8	2.3	
EBR64	100		6.0	6.4	12.0	26.8	2.3	
EBR84	100		8.0	8.4	12.0	26.8	2.3	
EBR105	100		10.0	10.5	13.6	30.5	2.3	
EBR13	100		12.0	13.0	19.2	35.4	2.3	
EYR37	4.0 – 6.0		100	3.5	3.7	7.2	23.2	3.4
EYR43			100	4.0	4.4	7.2	23.2	3.4
EYR53		100	5.0	5.4	9.5	27.3	3.4	
EYR64		100	6.0	6.4	12.0	29.5	3.4	
EYR84		100	8.0	8.5	15.0	34.5	3.4	
EYR105		100	10.0	10.6	15.0	34.5	3.4	
EYR13		100	12.0	13.0	19.2	39.1	3.4	

All dimensions are in mm

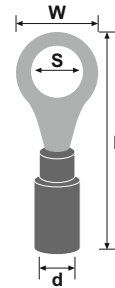
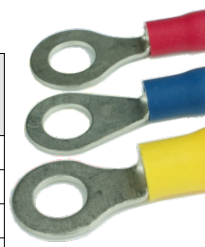
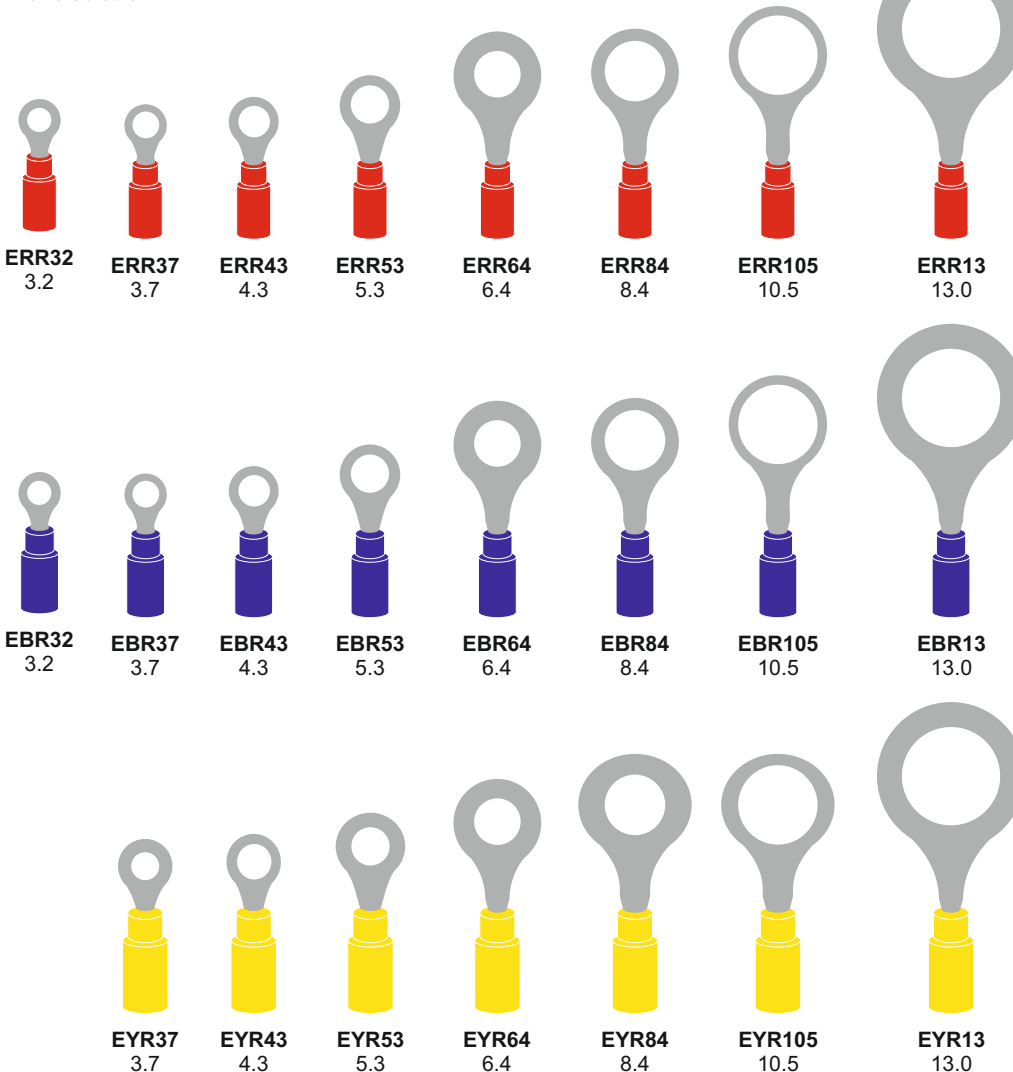

Technical Data



Material

Conductor: Copper
 Plating: Tin
 Insulation: Vinyl

Operating temperature

-10°C to +75°C

Ratings

Max voltage rating: 600V
 Max. current rating:
 Red : 19A
 Blue : 27A
 Yellow : 48A

Features

- Zero Halogen
- Flared barrel
- Simple wire insertion
- Low insertion force
- Easy to crimp
- Secure termination

Tooling

Ratchet action crimp tool
 For pre-insulated terminals
 Range : 0.5mm² to 6.0mm²
 Tool length: 242mm
 Weight: 0.5 kgs
 Part Number : **ERT6**



Fork Pre-insulated terminals

Part Number	Range (mm ²)	Pack Qty (pcs)	Stud Size	Dia (S)	Width (W)	Length (L)	Dia (d)
ERF32	0.5 – 1.5	100	3.0	3.2	5.7	21.0	1.7
ERF37		100	3.5	3.7	5.7	21.0	1.7
ERF43N		100	4.0	4.3	6.4	21.0	1.7
ERF53		100	5.0	5.3	8.1	21.0	1.7
ERF64		100	6.0	6.4	9.5	21.0	1.7
EBF32	1.5 – 2.5	100	3.0	3.2	5.7	21.0	2.3
EBF37		100	3.5	3.7	5.7	21.0	2.3
EBF43N		100	4.0	4.3	6.4	21.0	2.3
EBF53		100	5.0	5.3	7.9	21.0	2.3
EBF64		100	6.0	6.4	9.3	21.0	2.3
EYF37	4.0 – 6.0	100	3.5	3.7	8.3	25.5	3.4
EYF43		100	4.0	4.3	8.3	25.5	3.4
EYF53		100	5.0	5.3	9.0	25.5	3.4
EYF64		100	6.0	6.4	9.0	25.5	3.4

All dimensions are in mm

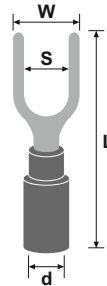
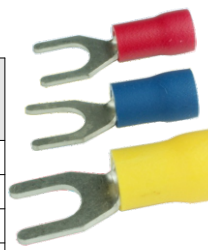
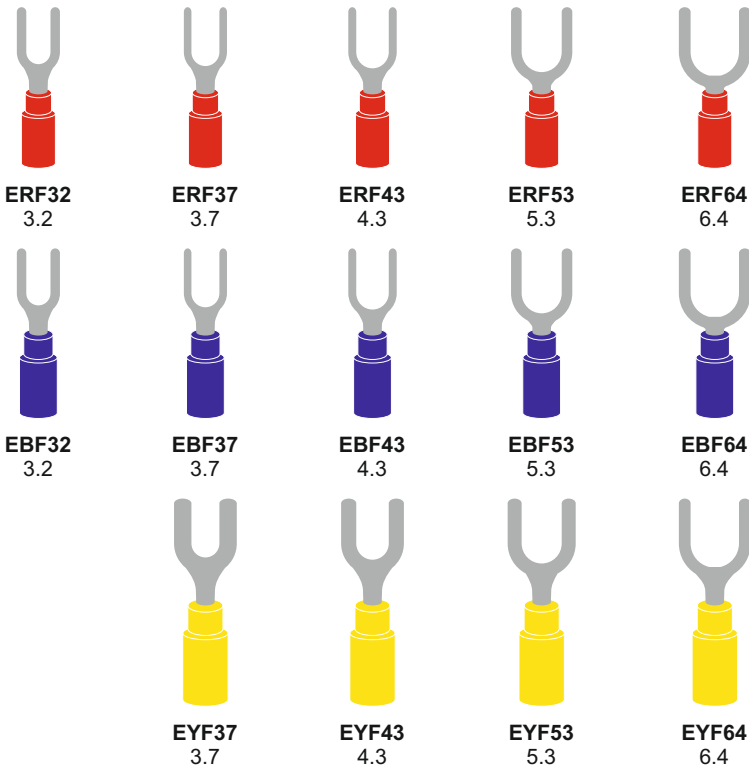

Technical Data



Material

Conductor: Copper

Plating: Tin

Insulation: Vinyl

Operating temperature

-10°C to +75°C

Ratings

Max voltage rating: 600V

Max. current rating:

Red : 19A

Blue : 27A

Yellow : 48A

Features

Zero Halogen

Flared barrel

Simple wire insertion

Low insertion force

Easy to crimp

Secure termination

Tooling

Ratchet action crimp tool

For pre-insulated terminals

Range : 0.5mm² to 6.0mm²

Tool length: 242mm

Weight: 0.5 kgs

Part Number : **ERT6**



Push-on Tab Pre-insulated terminals

Part Number	Range (mm ²)	Pack Qty (pcs)	Width (W)	Thick (T)	Length (L)	Dia (d)
ERPOM63-8	0.5 – 1.5	100	6.3	0.8	21.8	1.7
EBPOM63-8	1.5 – 2.5	100	6.3	0.8	21.8	2.3
EYPOM63-8	4.0 – 6.0	100	6.3	0.8	24.0	3.4

All dimensions are in mm

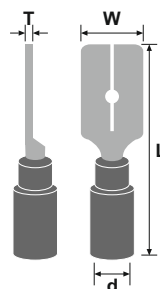
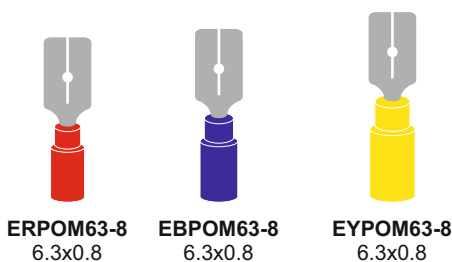

Push-on Female Spade Pre-insulated terminals

Part Number	Range (mm ²)	Pack Qty (pcs)	Width (W)	Thick (T)	Length (L)	Dia (d)
ERFS28-5	0.5 – 1.5	100	2.8	0.5	19.0	1.7
ERFS28-8		100	2.8	0.8	19.0	1.7
ERFS48-5		100	4.8	0.5	19.4	1.7
ERFS48-8		100	4.8	0.8	19.4	1.7
ERFS63-8		100	6.3	0.8	19.4	1.7
EBFS48-5	1.5 – 2.5	100	4.8	0.5	19.4	2.3
EBFS48-8		100	4.8	0.8	19.4	2.3
EBFS63-8		100	6.3	0.8	20.8	2.3
EBFS83-5		100	8.3	0.5	24.5	2.3
EYFS63-8	4.0 – 6.0	100	6.3	0.8	23.3	3.4
EYFS95-12		100	9.5	1.2	28.6	3.4

All dimensions are in mm

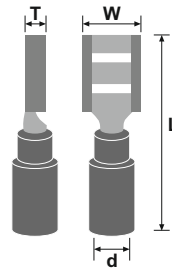
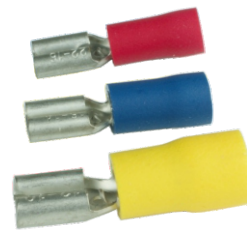
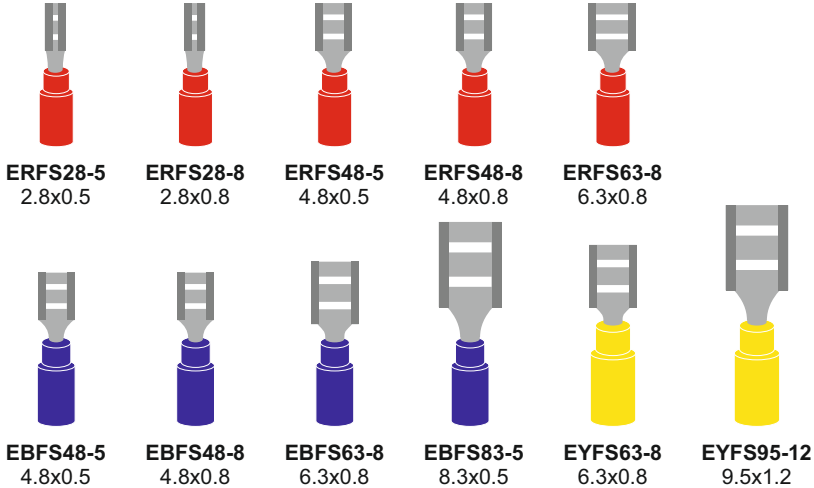

Technical Data



Material

Conductor: Copper
Plating: Tin
Insulation: Vinyl

Operating temperature

-10°C to +75°C

Ratings

Max voltage rating: 600V

Max. current rating:

Red : 19A

Blue : 27A

Yellow : 48A

Features

Zero Halogen
Flared barrel
Simple wire insertion
Low insertion force
Easy to crimp
Secure termination

Tooling

Ratchet action crimp tool
For pre-insulated terminals
Range : 0.5mm² to 6.0mm²
Tool length: 242mm
Weight: 0.5 kgs
Part Number : **ERT6**



Push-on Fully insulated terminals

Part Number	Range (mm ²)	Pack Qty (pcs)	Width (W)	Thick (T)	Length (L)	Dia (d)
ERFSFI28-5	0.5 – 1.5	100	2.8	0.5	19.0	1.7
ERFSFI28-8		100	2.8	0.8	19.0	1.7
ERFSFI48-5		100	4.8	0.5	20.5	1.7
ERFSFI48-8		100	4.8	0.8	20.5	1.7
ERFSFI63-8		100	6.3	0.8	21.8	1.7
EBFSFI48-5	1.5 – 2.5	100	4.8	0.5	20.2	2.3
EBFSFI48-8		100	4.8	0.8	20.2	2.3
EBFSFI63-8		100	6.3	0.8	22.2	2.3
EYFSFI63-8	4.0 – 6.0	100	6.3	0.8	24.2	3.4
EYFSFI95-12		100	9.5	1.2	30.5	3.4

All dimensions are in mm

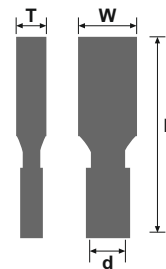
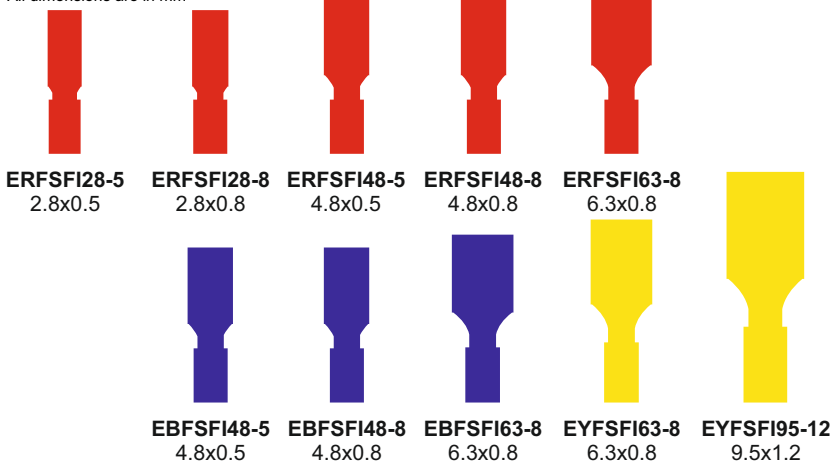

Telephone : +44 (0)141 941 3689 Email : sales@expresselectrical.co.uk

Pin Pre-insulated terminals

Part Number	Range (mm ²)	Pack Qty (pcs)	Width (W)	Pin (P)	Length (L)	Dia (d)
ERP9	0.5 – 1.5	100	1.9	9.0	18.8	1.7
ERP12		100	1.9	12.0	21.8	1.7
EBP9	1.5 – 2.5	100	1.9	9.0	18.8	2.3
EBP12		100	1.9	12.0	21.8	2.3
EYP14	4.0 – 6.0	100	2.8	14.0	27.0	3.4

All dimensions are in mm

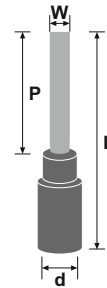
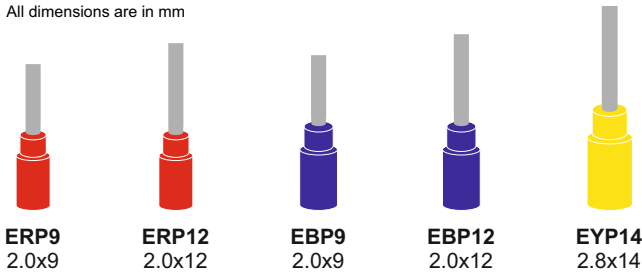

Technical Data



Material

Conductor: Copper
Plating: Tin
Insulation: Vinyl

Operating temperature

-10°C to +75°C

Ratings

Max voltage rating: 600V

Max. current rating:

Red : 19A

Blue : 27A

Yellow : 48A

Features

Zero Halogen
Flared barrel
Simple wire insertion
Low insertion force
Easy to crimp
Secure termination

Tooling

Ratchet action crimp tool
For pre-insulated terminals
Range : 0.5mm² to 6.0mm²
Tool length: 242mm
Weight: 0.5 kgs
Part Number : **ERT6**

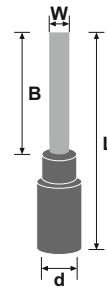

Blade Pre-insulated terminals

Part Number	Range (mm ²)	Pack Qty (pcs)	Blade (W)	Blade (B)	Length (L)	Dia (d)
ERFB9	0.5 – 1.5	100	2.8	9.0	19.3	1.7
ERFB14		100	3.0	14.0	24.3	1.7
ERFB18		100	2.3	18.0	27.8	1.7
EBFB9	1.5 – 2.5	100	2.8	9.0	19.3	2.3
EBFB18		100	2.3	18.0	27.8	2.3
EYFB10	4.0 – 6.0	100	2.8	10.5	23.5	3.4
EYFB18		100	4.5	18.0	23.0	3.4

All dimensions are in mm

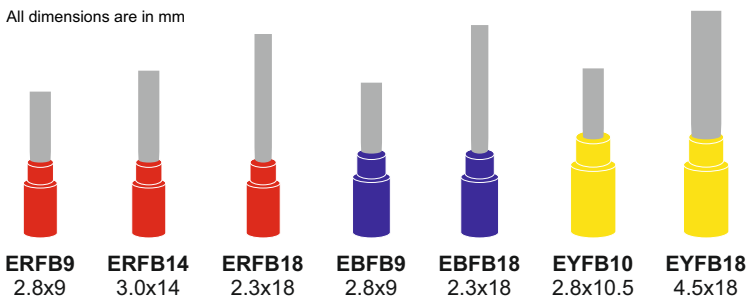

Hooked Blade Pre-insulated terminals

Part Number	Range (mm ²)	Pack Qty (pcs)	Blade (W)	Blade (B)	Length (L)	Dia (d)
ERHB3	0.5 – 1.5	100	3.0	13.0	27.7	1.7
ERHB46		100	4.6	13.0	27.7	1.7
EBHB3	1.5 – 2.5	100	3.0	13.0	27.7	2.3
EBHB46		100	4.6	13.0	27.7	2.3
EYHB46	4.0 – 6.0	100	4.6	13.0	30.7	3.4

All dimensions are in mm

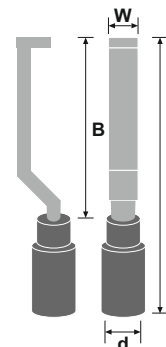
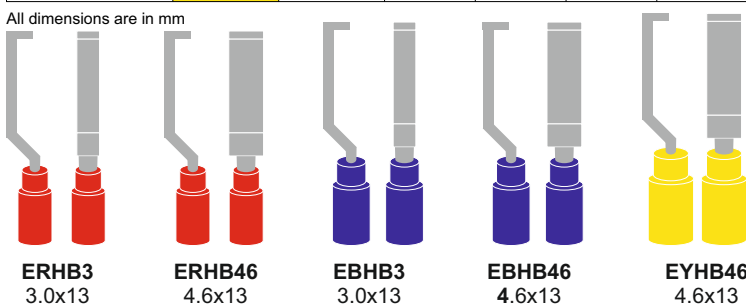

Piggyback Pre-insulated terminals

Part Number	Range (mm ²)	Pack Qty (pcs)	Width (W)	Thick (T)	Length (L)	Dia (d)
ERPBF63-8	0.5 – 1.5	100	6.3	0.8	22.5	1.7
EBPBF63-8	1.5 – 2.5	100	6.3	0.8	22.5	2.3
EYPBF63-8	4.0 – 6.0	100	6.3	0.8	24.0	3.4

All dimensions are in mm

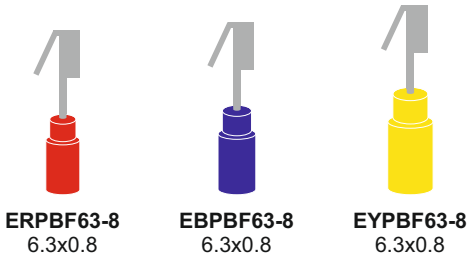
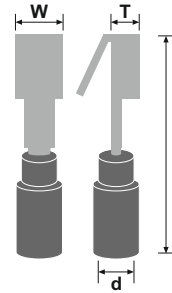
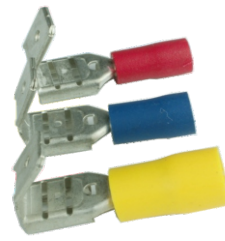

Bullet Connectors Male Pre-insulated terminals

Part Number	Range (mm ²)	Pack Qty (pcs)	Dia (D)	Bullet (B)	Length (L)	Dia (d)
ERBM4	0.5 – 1.5	100	4.0	10.5	21.5	1.7
EBBM4	1.5 – 2.5	100	4.0	10.5	21.7	2.3
EBBM5		100	5.0	10.5	21.2	2.3
EYBM5	4.0 – 6.0	100	5.0	13.0	24.0	3.4

All dimensions are in mm

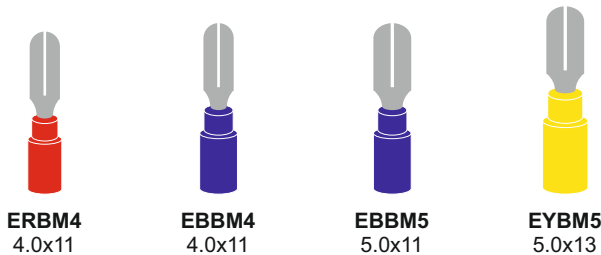
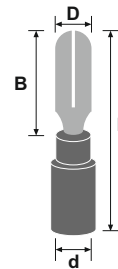

Bullet Connectors Female Pre-insulated terminals

Part Number	Range (mm ²)	Pack Qty (pcs)	Dia (D)	Bullet (B)	Length (L)	Dia (d)
ERBF4	0.5 – 1.5	100	4.0	10.5	23.3	1.7
EBBF4	1.5 – 2.5	100	4.0	10.5	23.3	2.3
EBBF5		100	5.0	10.5	23.3	2.3
EYBF5	4.0 – 6.0	100	5.0	13.0	25.1	3.4

All dimensions are in mm

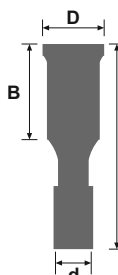

Technical Data



Material

Conductor: Copper

Plating: Tin

Insulation: Vinyl

Operating temperature

-10°C to +75°C

Ratings

Max voltage rating: 600V

Max. current rating:

Red : 19A

Blue : 27A

Yellow : 48A

Features

Zero Halogen

Flared barrel

Simple wire insertion

Low insertion force

Easy to crimp

Secure termination

Tooling

Ratchet action crimp tool

For pre-insulated terminals

Range : 0.5mm² to 6.0mm²

Tool length: 242mm

Weight: 0.5 kgs

Part Number : **ERT6**



Butt Connector Pre-insulated terminals

Part Number	Range (mm ²)	Pack Qty (pcs)	Dia (D)	Length (L)	Dia (d)
ERBC	0.5 – 1.5	100	4.0	24.6	1.7
EBBC	1.5 – 2.5	100	4.5	24.6	2.3
EYBC	4.0 – 6.0	100	6.3	26.5	3.4

All dimensions are in mm



ERBC
1.7x24



EBBC
2.3x24



EYBC
3.4x27



Technical Data



Material

Conductor: Copper

Plating: Tin

Insulation: Vinyl

Operating temperature

-10°C to +75°C

Ratings

Max voltage rating: 600V

Max. current rating:

Red : 19A

Blue : 27A

Yellow : 48A

Features

Zero Halogen

Flared barrel

Simple wire insertion

Low insertion force

Easy to crimp

Secure termination

Tooling

Ratchet action crimp tool

For pre-insulated terminals

Range : 0.5mm² to 6.0mm²

Tool length: 242mm

Weight: 0.5 kgs

Part Number : **ERT6**

Closed End Connectors Pre-insulated terminals

Part Number	Range (mm ²)	Pack Qty (pcs)	Dia (D)	Length (L)	Dia (d)
ERCEC	0.5 – 1.5	100	8.0	21.0	2.3
EBCEC	1.5 – 2.5	100	8.0	21.0	3.1
EYCEC	4.0 – 6.0	100	10.0	25.5	4.0

All dimensions are in mm



ERCEC
2.3x21



EBCEC
3.1x21



EYCEC
4.0x26



Push-on Flag Pre-insulated terminals

Part Number	Range (mm ²)	Pack Qty (pcs)	Width (W)	Thick (T)	Length (L)	Dia (d)
ERFLAG63-8	0.5 – 1.5	100	6.3	0.8	16.0	1.7
EBFLAG63-8	1.5 – 2.5	100	6.3	0.8	16.5	3.4

All dimensions are in mm



ERFLAG63-8
6.3x0.8



EBFLAG63-8
6.3x0.8

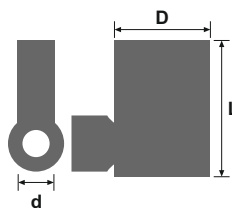

Ratchet action crimp tool

For pre-insulated **flag** terminals only

Range : 0.5mm² to 6.0mm²

Tool length: 205mm

Weight: 0.5 kgs

Part Number : **EFTCT1**



ET-RBY-KIT1 Pre-Insulated terminals kit

A professional RBY terminals kit supplied in a robust carry case with removable compartments. Kit includes:

ECSB-L large compartment storage box	1pc
ERT6 crimp tool for RBY terminals 0.5-6.0mm ²	1pc
TAPE-0-19X33M-PVC 19mm x 33M PVC Black	2pcs

Red Terminals

ERR43 Pre-Insulated Ring 4.3mm	25pcs
ERR53 Pre-Insulated Ring 5.3mm	25pcs
ERR64 Pre-Insulated Ring 6.4mm	25pcs
ERF43N Pre-Insulated Fork 4.3mm	25pcs
ERP12 Pre-Insulated Pin 12mm	25pcs
ERFS63-8 Pre-Insulated Push-on Spade 6.3mm	25pcs
ERPOM63-8 Pre-Insulated Push-on Tab 6.3mm	25pcs
ERBC Pre-Insulated Butt Connector 4mm	25pcs

Blue Terminals

EBR43 Pre-Insulated Ring 4.3mm	25pcs
EBR53 Pre-Insulated Ring 5.3mm	25pcs
EBR64 Pre-Insulated Ring 6.4mm	25pcs
EBF43N Pre-Insulated Fork 4.3mm	25pcs
EBP12 Pre-Insulated Pin 12mm	25pcs
EBFS63-8 Pre-Insulated Push-on Spade 6.3mm	25pcs
EBPOM63-8 Pre-Insulated Push-on Tab 6.3mm	25pcs
EBBC Pre-Insulated Butt Connector 5mm	25pcs

Yellow Terminals

EYR43 Pre-Insulated Ring 4.3mm	25pcs
EYR53 Pre-Insulated Ring 5.3mm	25pcs
EYR64 Pre-Insulated Ring 6.4mm	25pcs
EYBC Pre-Insulated Butt Connector 6mm	25pcs

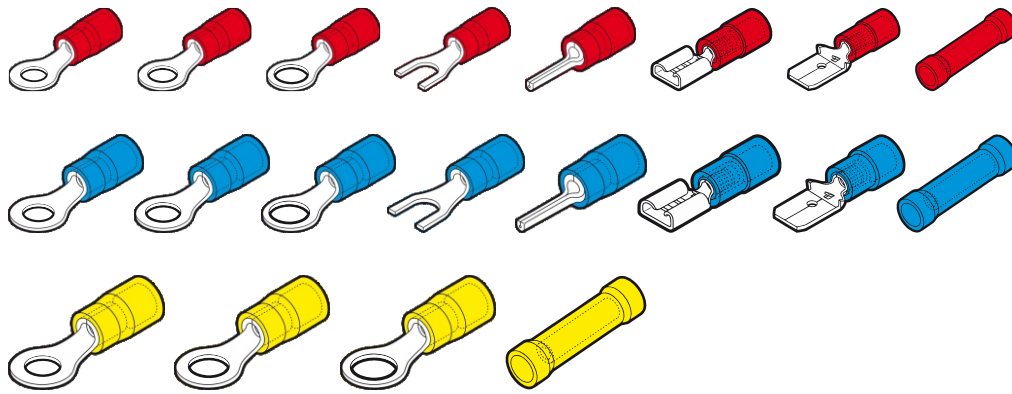

Ordering information

Kit part number : **ET-RBY-KIT1**

Technical Data



Material

Conductor: Copper
Plating: Tin
Insulation: Vinyl

Operating temperature

-10°C to +75°C

Ratings

Max voltage rating: 600V

Max. current rating:

Red : 19A

Blue : 27A

Yellow : 48A

Features

Zero Halogen
Flared barrel
Simple wire insertion
Low insertion force
Easy to crimp
Secure termination

Tooling

Ratchet action crimp tool
For pre-insulated terminals
Range : 0.5mm² to 6.0mm²
Tool length: 242mm
Weight: 0.5 kgs
Part Number : **ERT6**

Order additional terminals to personalise your own kit

Create your own kit using these professional compartment boxes

ECSB Professional Empty Compartment Storage Boxes

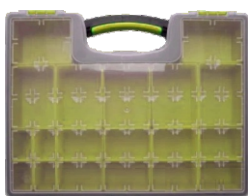

ECSB-L
19 removable compartments
420 x 330 x 55mm (WxDxH)



ECSB-M
15 removable compartments
200 x 300 x 50mm (WxDxH)



ECSB-S
15 removable dividers
212 x 138 x 43mm (WxDxH)

Telephone : +44 (0)141 941 3689 Email : sales@expresselectrical.co.uk